

T. 3S., R. 45E., W.M.

15.0 acres SW 1/4 NE 1/4

21.5 acres SE 1/4 NE 1/4

Tax Lot 600

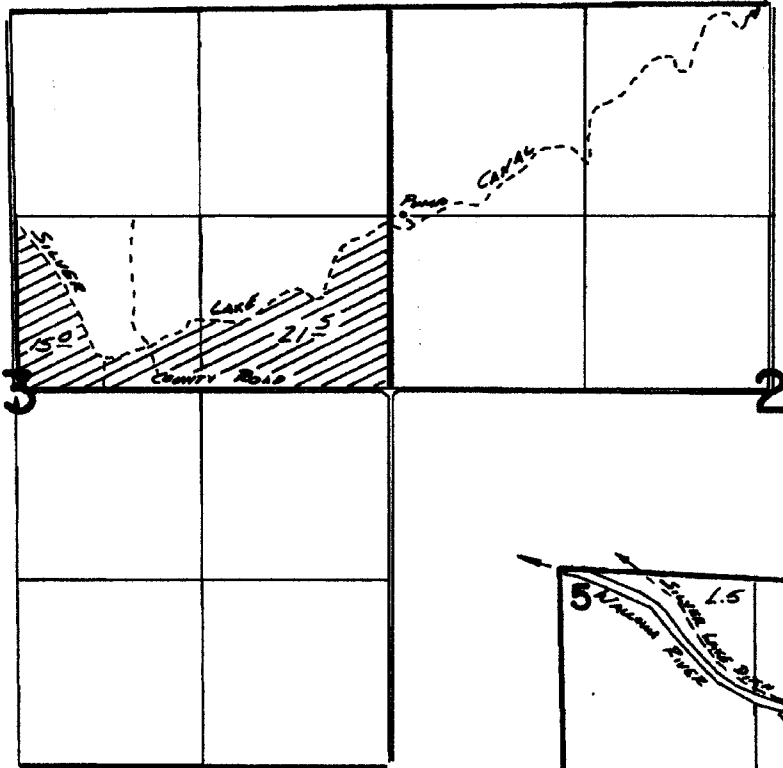

1" = 1/4 mile

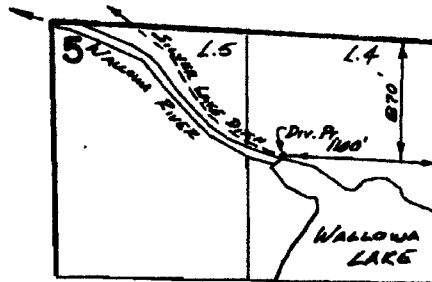

Application map for Dan & Lori Butterfield

FINAL PROOF SURVEY
UNDER

Application No. **54202** Permit No. **40567**
IN NAME OF

LUTHER E. THORNBURGH

Surveyed *Aug 11* 1982, by *V.H. Church*

RECEIVED

SEP 27 2013

WATER RESOURCES DEPT
SALEM, OREGON

Photo Copy

S87936

42