

RECEIVED

NOV 12 2010

WATER RESOURCES DEPT
SALEM, OREGON

T. 34 S., R. 2W Sec 21

NW/NE TL 6702

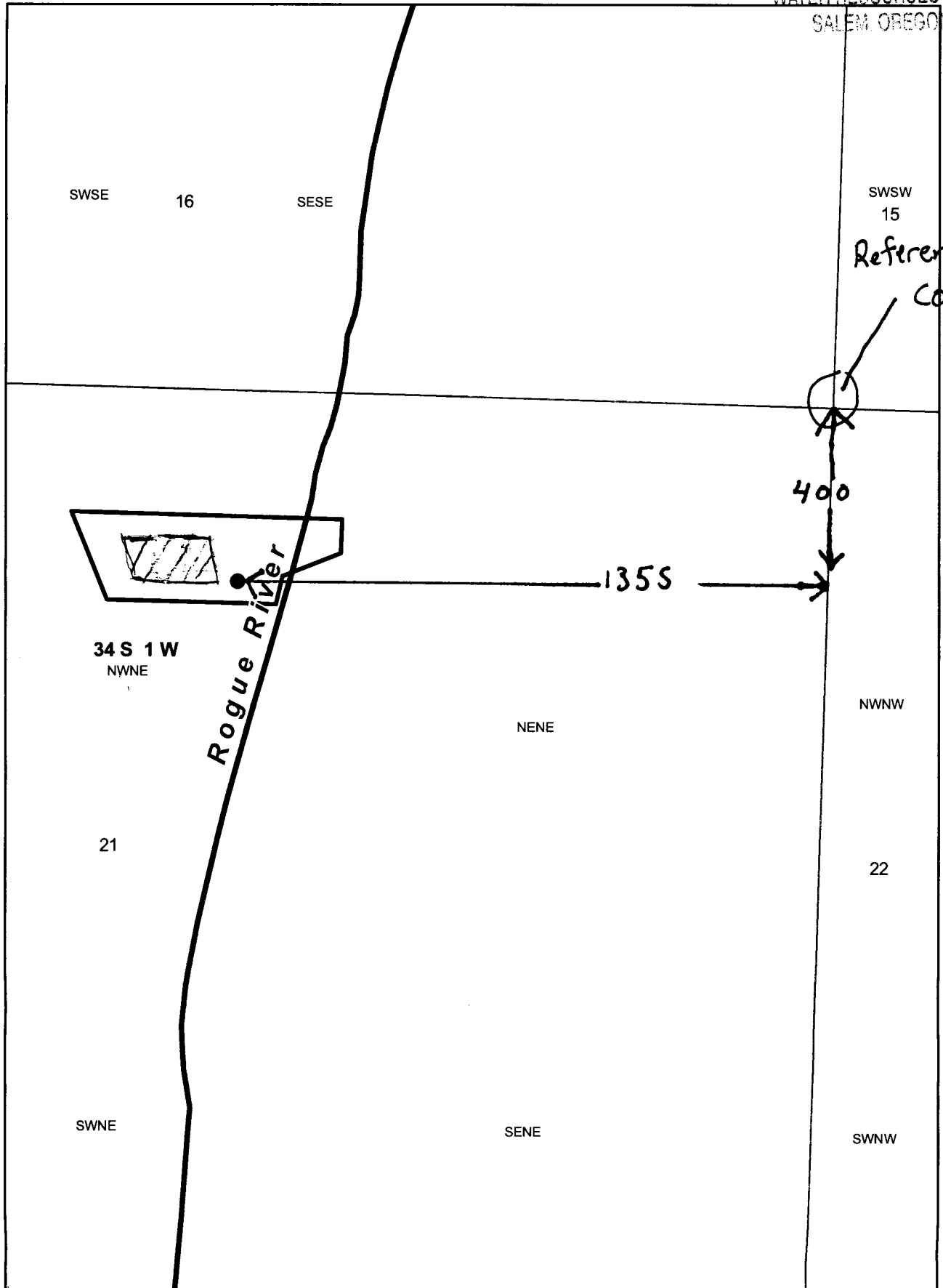

SWSE 16

SESE

SWSW 15

Reference
Corner

400

1355

34 S 1 W
NWNE

NENE

NWNW

21

22

SWNE

SENE

SWNW

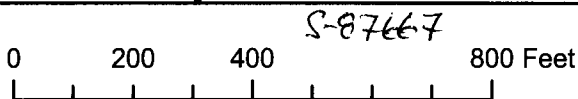

S-87667

POD is 400 ft South and 1355 ft West
from NE corner of Section 21

POU in NWNE of 1.58 acres