

Water Right Application Map
Larry Brandenburg
SW 1/4 Sec. 23 T.26S. R.5W
Douglas County
Scale: 1" = 500'

RECEIVED BY GWRD

OCT 08 2014

SALEM, OR

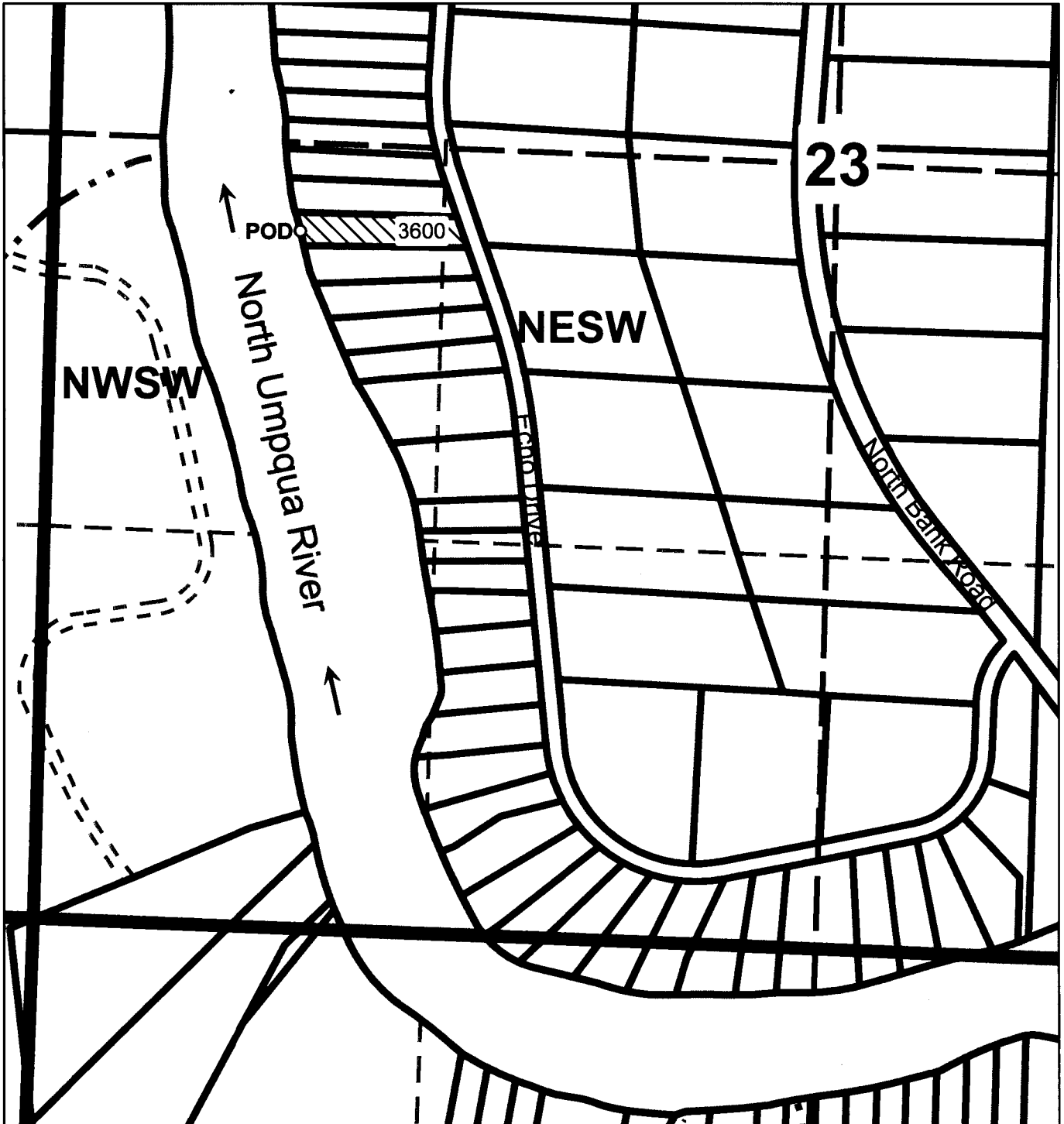
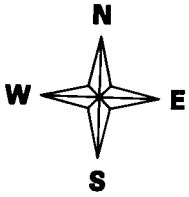

**POD is 300 ft. south and 830 ft. east from the
west 1/4 corner of Section 23**

S-88019