

# T.1N. R.3W. Section 15, W.M.

TL 1N315 300

**Cornelius Sr.  
DLC 45**

10 11  
15 14

0.9

RECORDED

APR 25 2013

WATER RESOURCES DEPT  
SOUTH OREGON

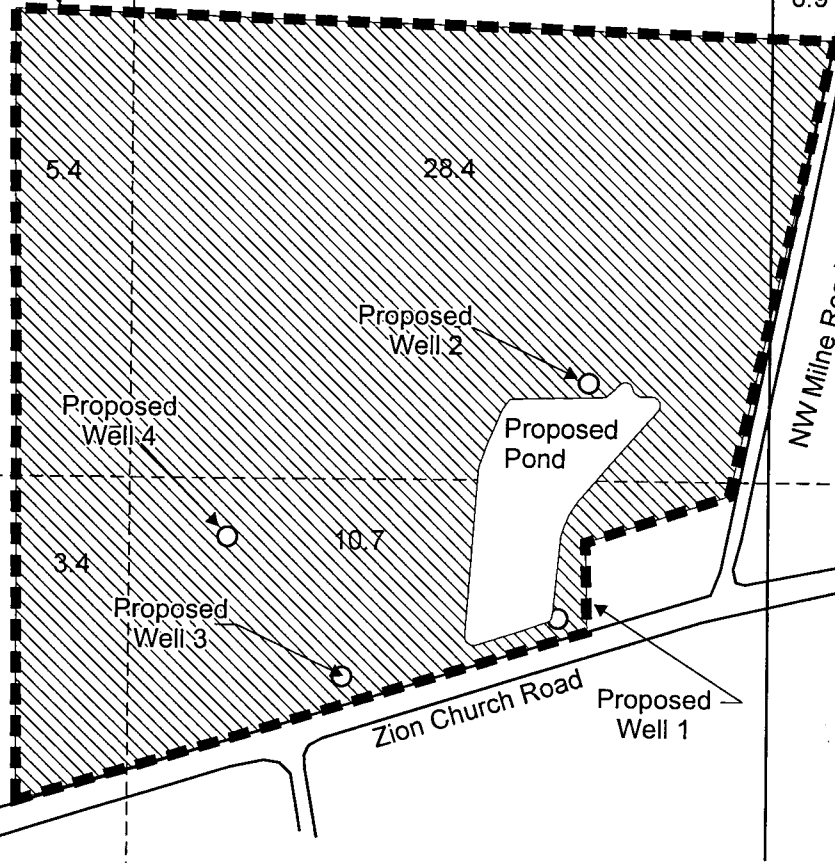

*Melissa R. Kuyvelde*  
STATE OF OREGON  
REGISTRAR

EXPIRATION DATE 6/30/13

Proposed Well 1 is located 1,610 feet south and 435 feet west from NE corner of Section 15.  
 Proposed Well 2 is located 1,120 feet south and 375 feet west from NE corner of Section 15.  
 Proposed Well 3 is located 1,730 feet south and 875 feet west from the NE corner of Section 15.  
 Proposed Well 4 is located 1,440 feet south and 1,120 feet west from NE corner of Section 15.  
 Proposed center of berm is located feet 1,635 south and 510 feet west from NE corner of Section 15.

Area (47.9 Acres) to be irrigated.

Tax lot boundary

Scale: 1" = 400'

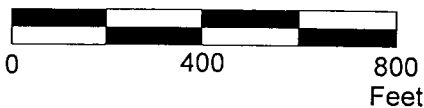

This map was prepared for the purpose of identifying the location of a water right only and is not intended to provide legal dimensions or location of property ownership lines.



S-87992

Pacific Hydro-Geology Inc.

Water Right Application Map

Blooming Nursery  
T.1N. R.3W. Section 15, Tax Lot 300

03/2013 MRK

BloomingAppMap.cdr