

David Darnall

1" = 1320'

Tax Lot: 400, 01800, and 01900.



S.W. 1/4 N.E. 1/4 SEC. 22 T. 1S R. 10W W.M. Tillamook County

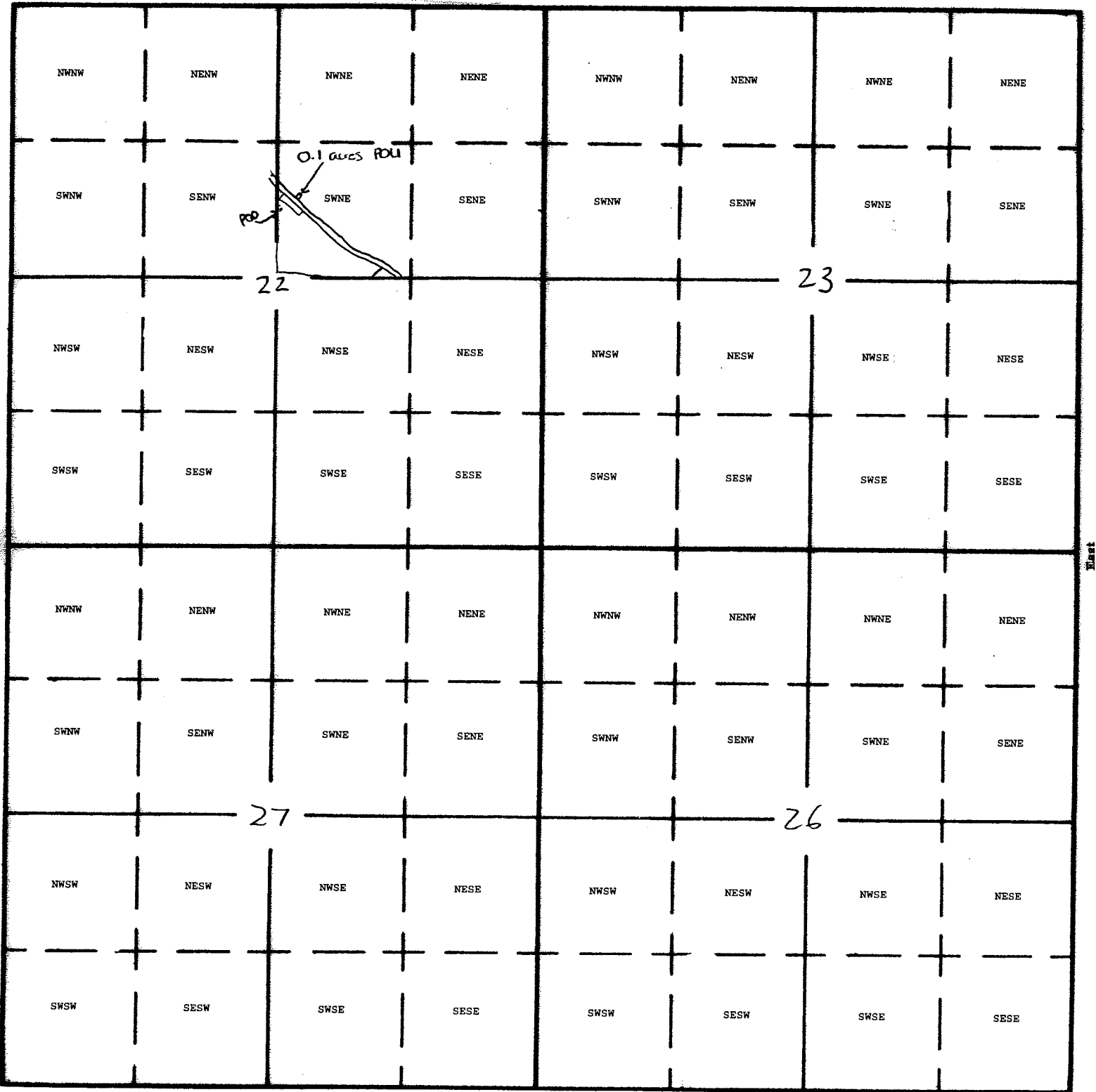

Point of Diversion is located 1970 feet South and ~~2778~~ ²⁶⁴⁰ feet West of the NE Corner of Section 22
 RECEIVED BY OWRD

SEP 24 2014

S-88014

SEP 12 2014

SALEM, OR

SALEM, OR