

SEC. 36 T.25S. R.7W. W.M.
 DOUGLAS COUNTY
 Scale 1" = 1000'

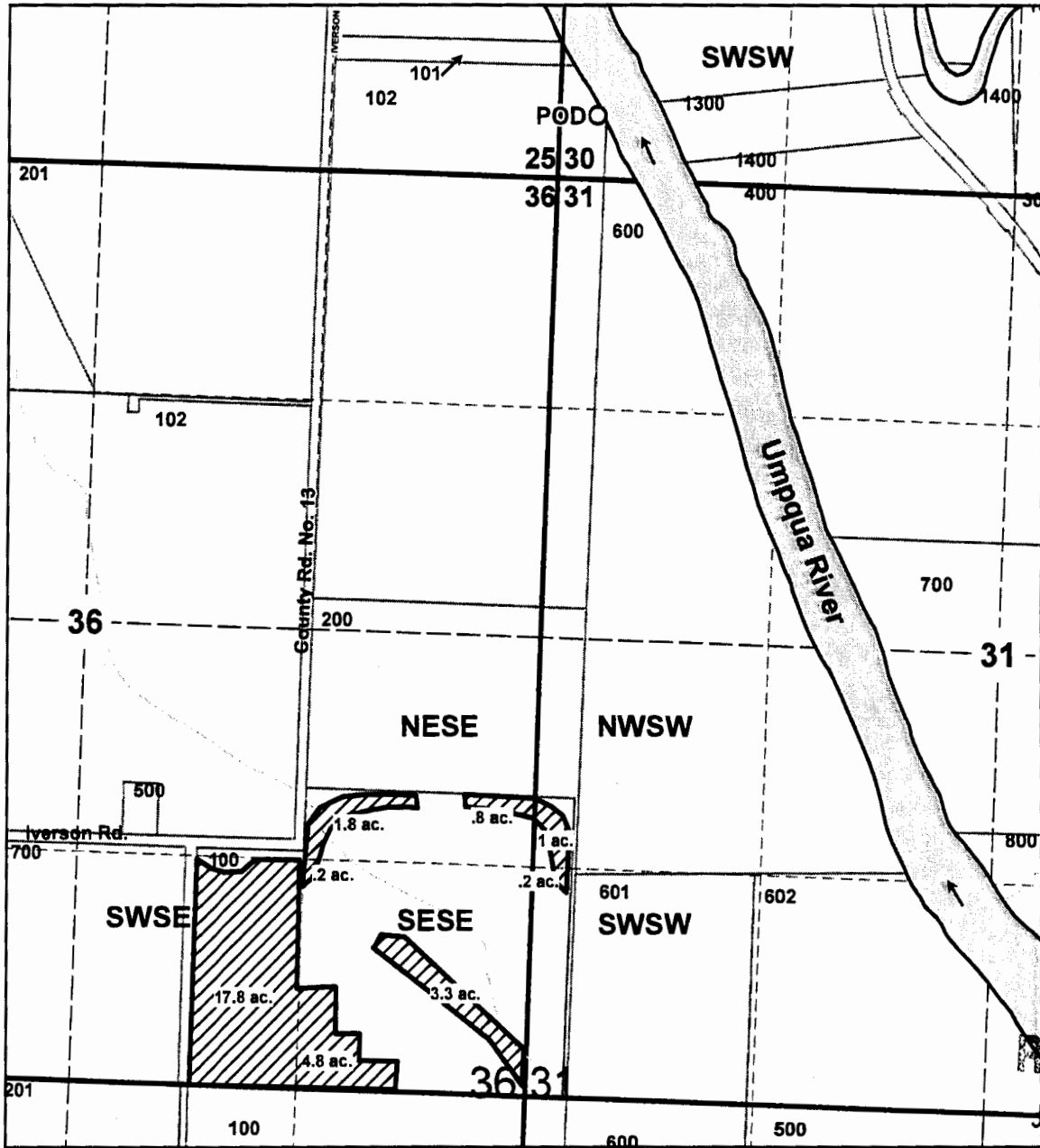
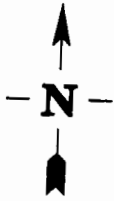

RECEIVED

JUN 03 2010

WATER RESOURCES DEPT
 SALEM, OREGON

Point of Diversion is located 410 ft. N. and 210 ft. E.
 from the SW Corner of Sec. 30.