

T.10S. R.3W. Sec. 19, 20, 29, & 30, W.M.

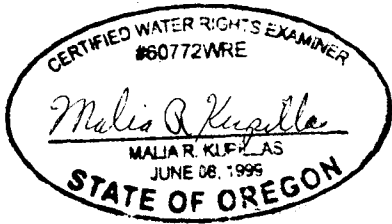
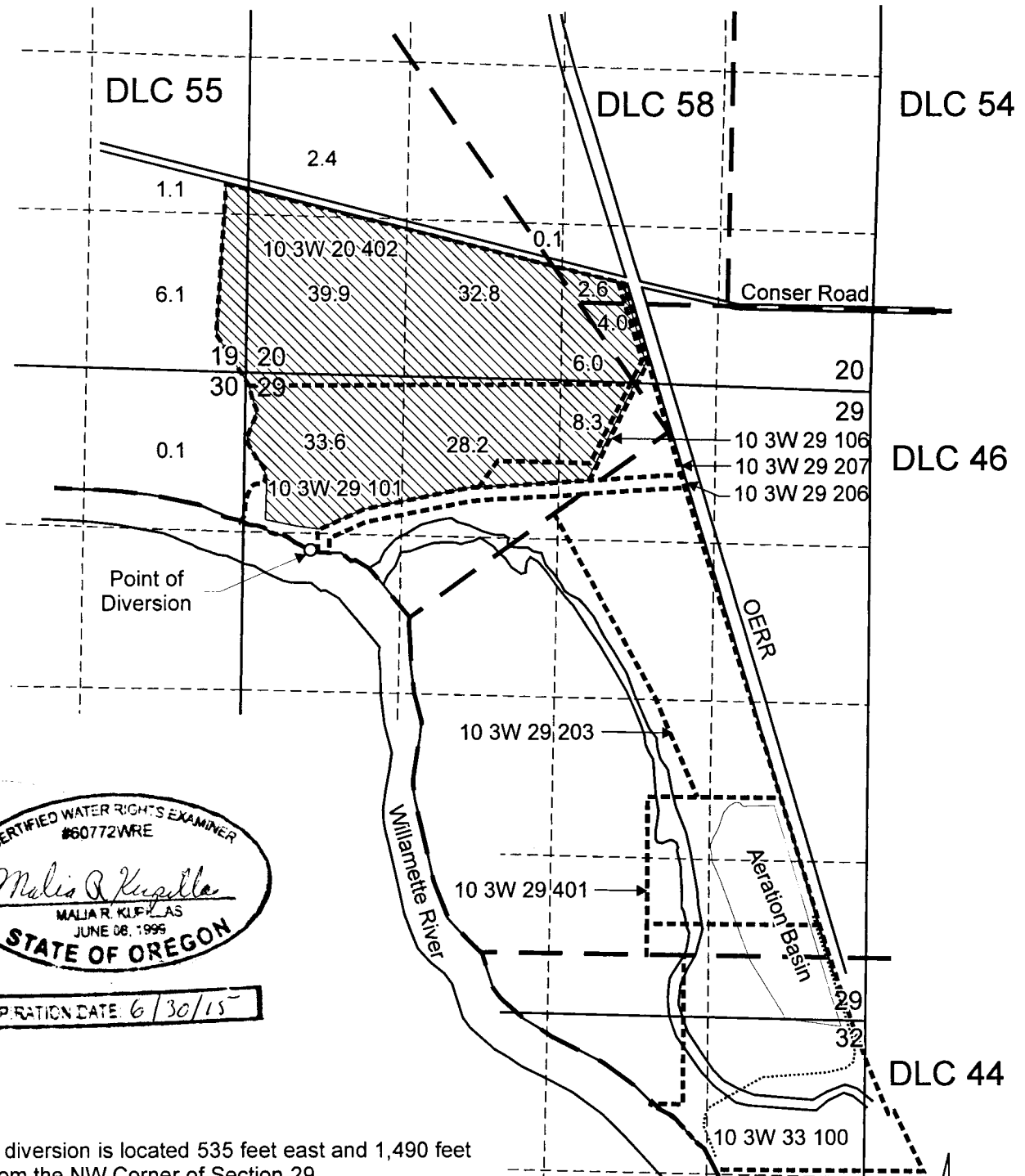

EXPIRATION DATE: 6/30/15

Point of diversion is located 535 feet east and 1,490 feet south from the NW Corner of Section 29.

Area (165.2 Acres) proposed for supplemental irrigation use; (Primary irrigation under Certificate 72755 and Certificate 72756).

----- Tax Lot Boundary

Scale: 1" = 1,320'



RECEIVED

OCT 30 2014



Water Right Application Map
WATER RESOURCES DEPT
SALEM, OREGON

Willamette Valley Land LLC
T.10S. R.3W. Sec. 19, 20, 29, & 30, W.M.

Pacific Hydro-Geology Inc.

2014-bgp

Willamette_Valley_Land_LLC.cdr

8-88027