

7988

Township 28 S,

Range 6 W.

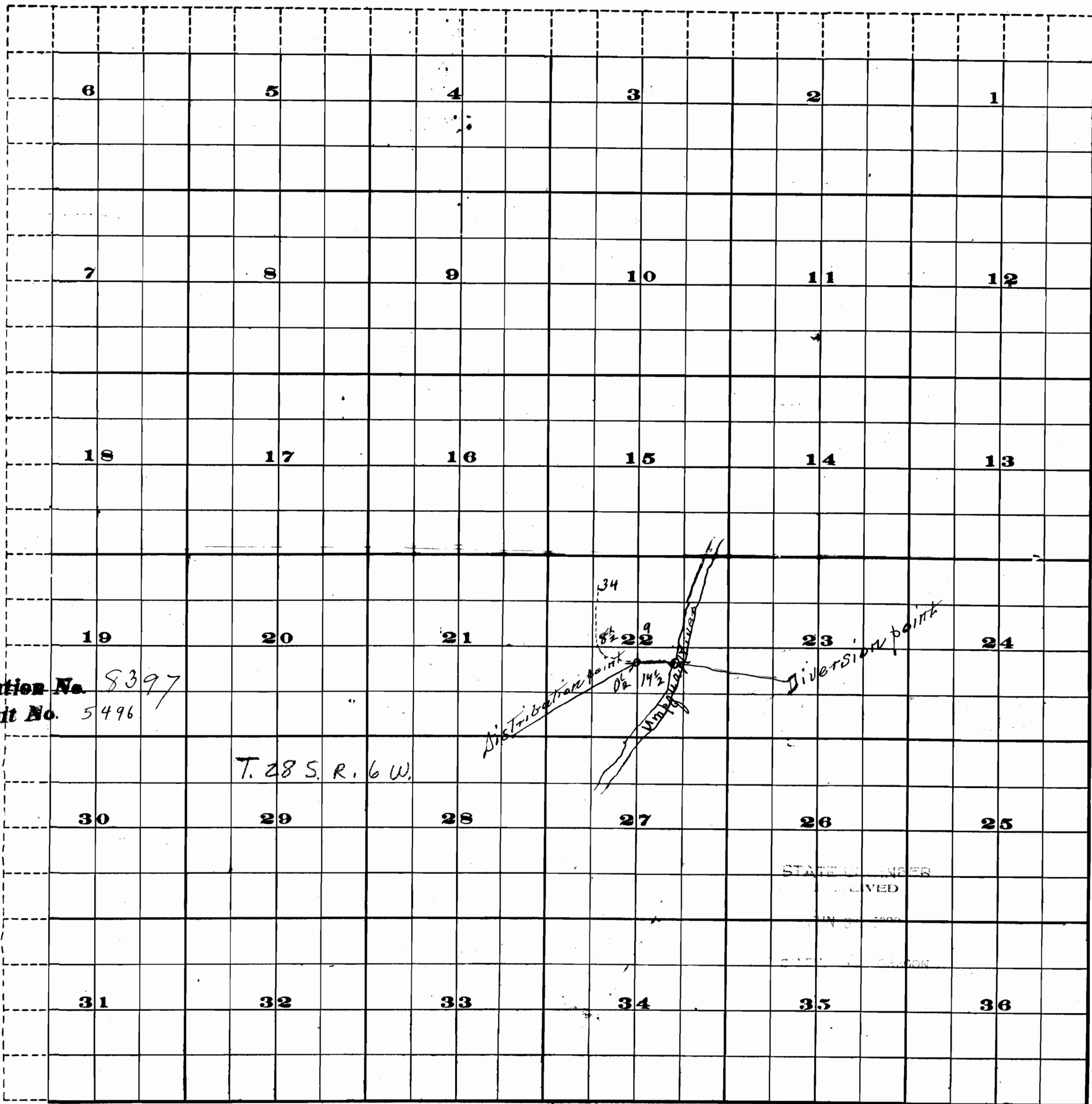

Application No. 8397
Permit No. 5496

T. 28 S. R. 6 W.

STATE ENGINEER
RECEIVED
JUN 2 1900
OFFICE OF THE STATE ENGINEER

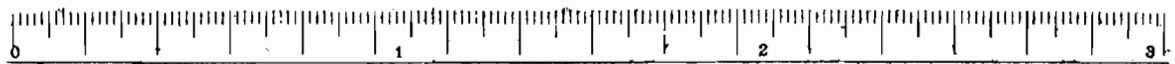

Scale of Feet.

FROM OFFICE OF THE STATE ENGINEER, SALEM, OREGON

7988