

**Water Right Application  
James Gayner  
T.28S. R.7W. W.M.  
Sections 27 and 34  
Scale: 1" = 500'**

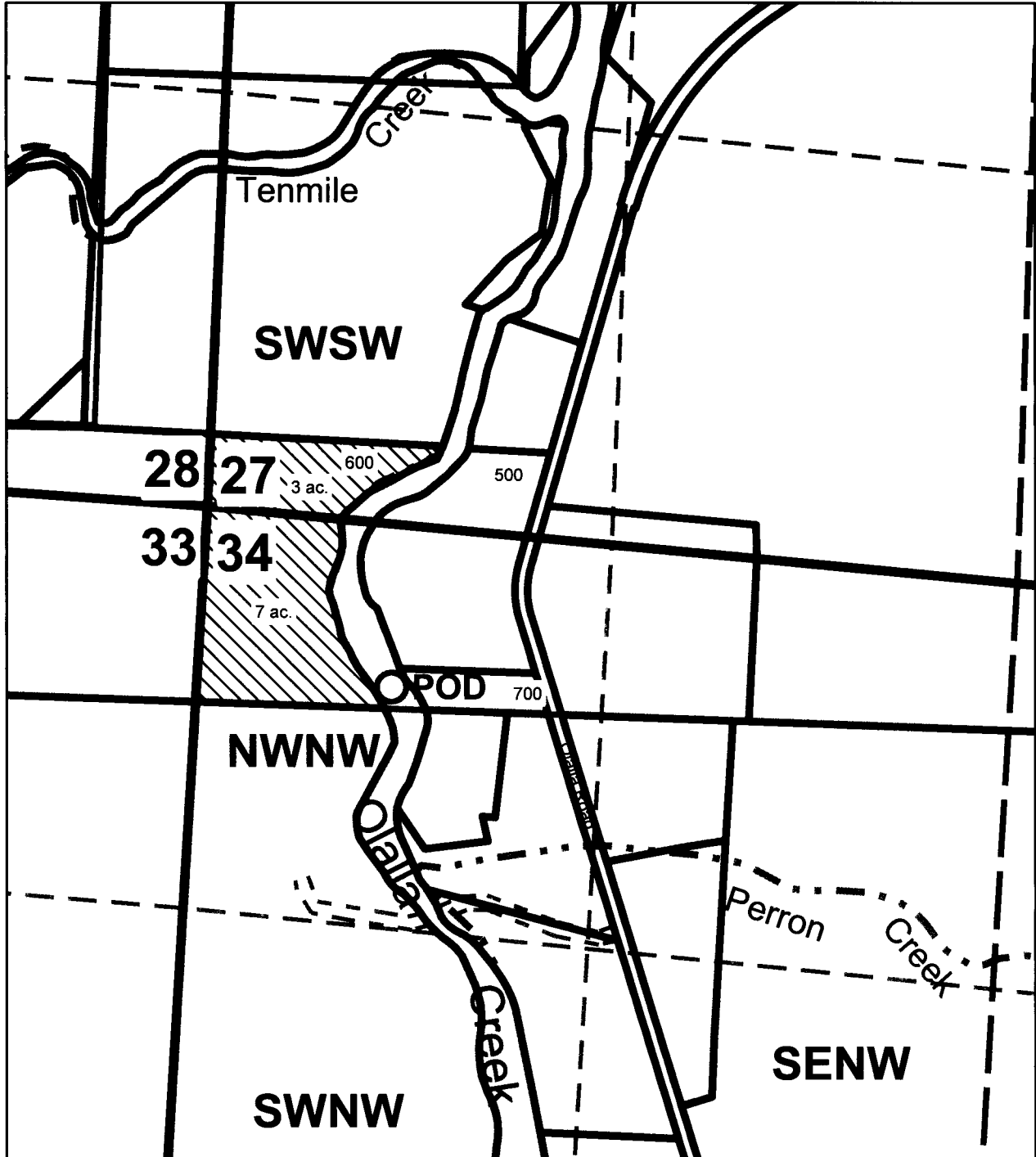
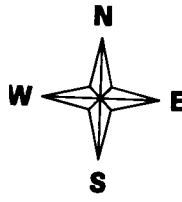

**POD is 600 ft. South and 730 ft. East from the NW corner of Section 34**

**RECEIVED BY OWRD**

*S-82083*

**MAY 08 2015**

**SALEM, OR**