

**Permit Application Map
for the Use of Stored Water**

Place of Use Map - Clarno
Township 28 South, Range 6 West, W.M.

LEGEND

- Proposed Point of Re-Diversion
- Place of Use (POU)
- Irrigation Mainline
- Donation Land Claim (DLC)
- Government Lot (GL)
- Tax Lot
- Watercourse
- Waterbody

RECEIVED
NOV 05 2015
OWRD

POD Location Description

Proposed Point of Re-Diversion
Located 1,180 feet South and 2,125 feet West from the NE corner of Section 19, Township 28 South, Range 6 West (W.M.)

Disclaimer

This map was prepared for the purpose of identifying the location of a water right only and it is not intended to provide legal dimensions or location of property ownership lines.

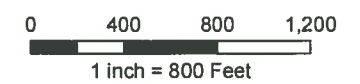

MAP NOTES:

Date: October 27, 2015
Data Sources: USGS, BLM, Douglas Co.









S-88144

**Permit Application Map
for the Use of Stored Water**

Point of Diversion Map

Township 29 South, Range 7 West, W.M.

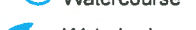
LEGEND

-  Proposed Point of Diversion
-  Berry Creek Dam
-  Donation Land Claim (DLC)
-  Government Lot (GL)
-  Tax Lot
-  Watercourse
-  Waterbody

RECEIVED
NOV 05 2015
OWRD

POD Location Description

Proposed Point of Diversion
Located 1,080 feet South and 2,060 feet East from the NW corner
of Section 20, Township 29 South, Range 7 West (W.M.)

Disclaimer

This map was prepared for the purpose of identifying the
location of a water right only and it is not intended to provide
legal dimensions or location of property ownership lines.

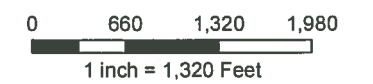

MAP NOTES:

Date: June 2, 2015
Data Sources: USGS, BLM, Douglas Co.

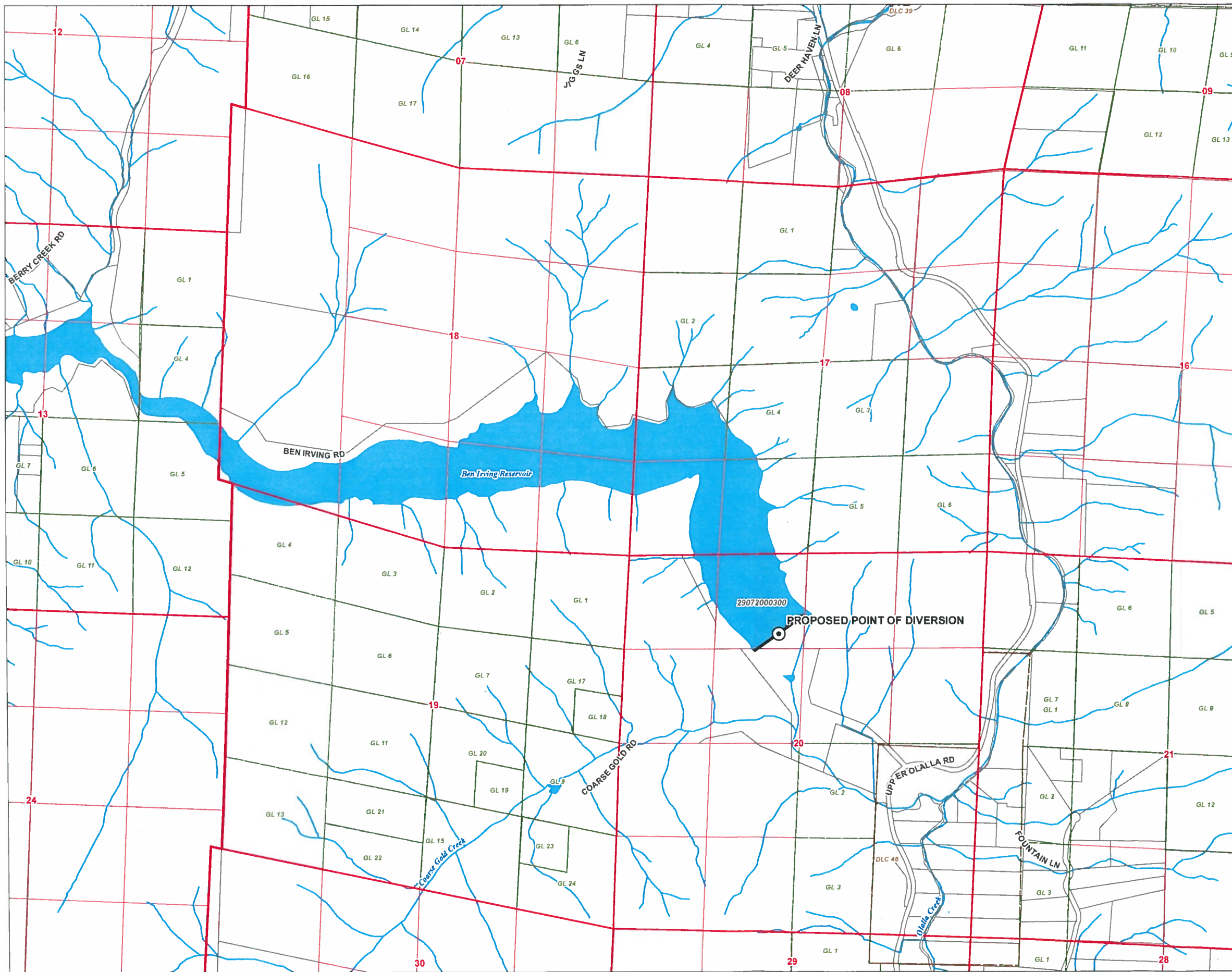

S-88144