

**Permit Application Map  
for the Use of Stored Water**

**Place of Use Map - Clarno**  
Township 28 South, Range 6 West, W.M.

**LEGEND**

- Proposed Point of Re-Diversion
- Place of Use (POU)
- Irrigation Mainline
- Donation Land Claim (DLC)
- Government Lot (GL)
- Tax Lot
- Watercourse
- Waterbody

**RECEIVED**  
**NOV 05 2015**  
**OWRD**

**POD Location Description**

**Proposed Point of Re-Diversion**  
Located 1,180 feet South and 2,125 feet West from the NE corner of Section 19, Township 28 South, Range 6 West (W.M.)

**Disclaimer**

This map was prepared for the purpose of identifying the location of a water right only and it is not intended to provide legal dimensions or location of property ownership lines.

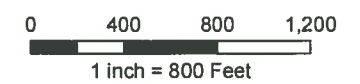

**MAP NOTES:**

Date: October 27, 2015  
Data Sources: USGS, BLM, Douglas Co.









S-88144

**Permit Application Map  
for the Use of Stored Water**

**Point of Diversion Map**

Township 29 South, Range 7 West, W.M.

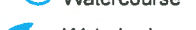
**LEGEND**

-  Proposed Point of Diversion
-  Berry Creek Dam
-  Donation Land Claim (DLC)
-  Government Lot (GL)
-  Tax Lot
-  Watercourse
-  Waterbody

**RECEIVED**  
NOV 05 2015  
OWRD

**POD Location Description**

Proposed Point of Diversion  
Located 1,080 feet South and 2,060 feet East from the NW corner  
of Section 20, Township 29 South, Range 7 West (W.M.)

**Disclaimer**

This map was prepared for the purpose of identifying the  
location of a water right only and it is not intended to provide  
legal dimensions or location of property ownership lines.

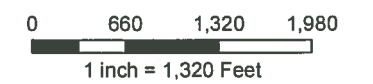

**MAP NOTES:**

Date: June 2, 2015  
Data Sources: USGS, BLM, Douglas Co.

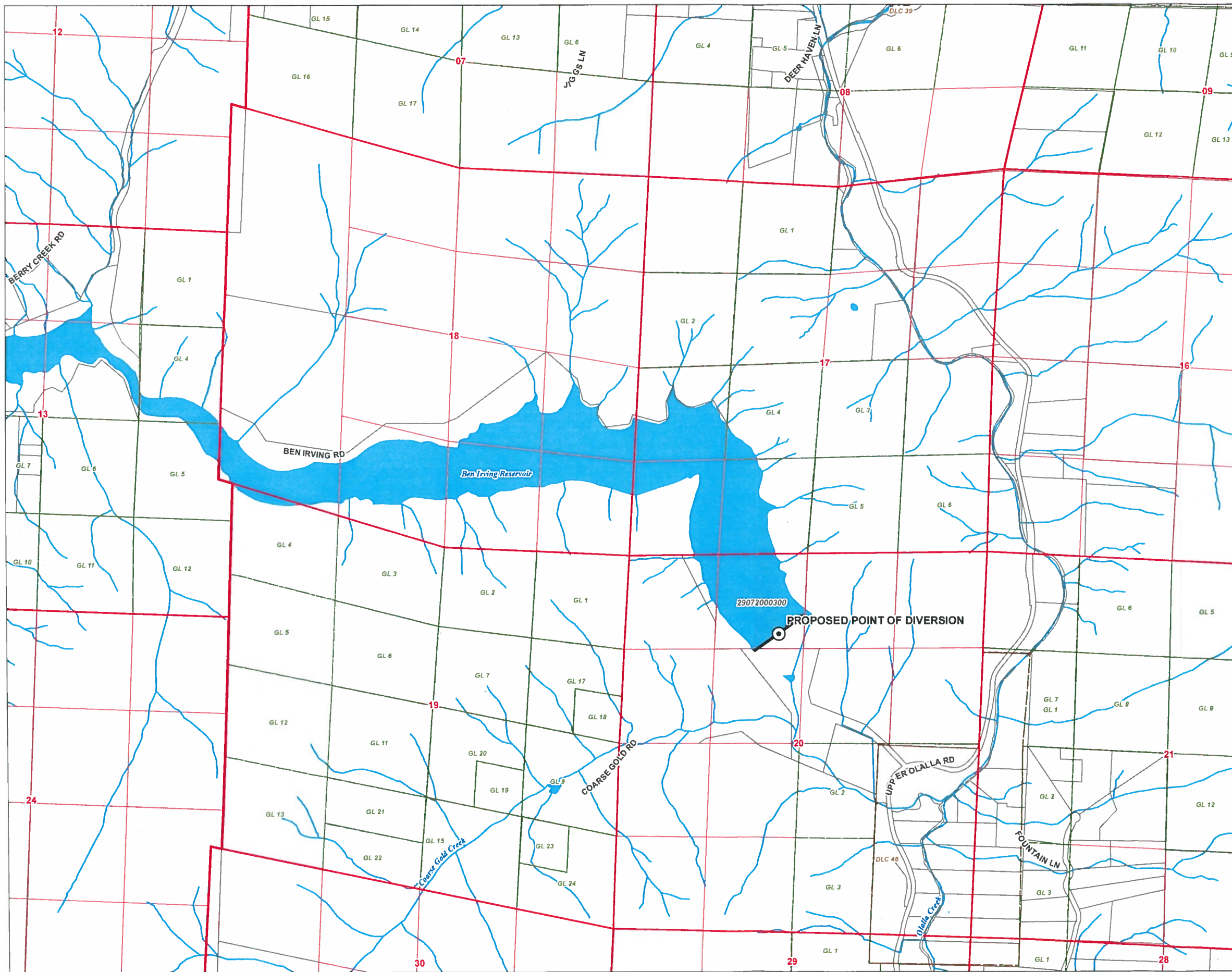

S-88144