

# T.8S. R.2W. Sec. 11, & 12, W.M.

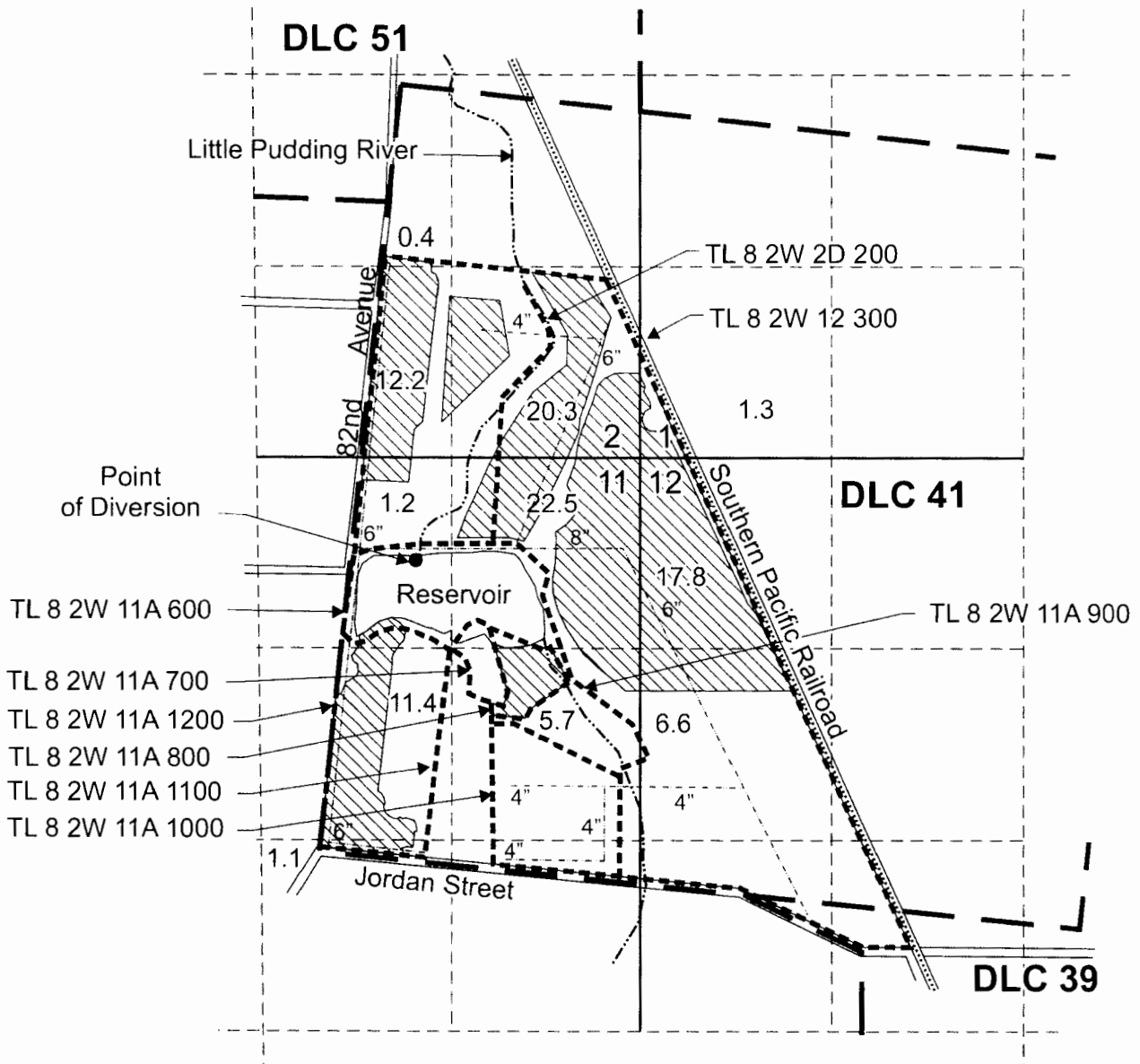

Proposed point of diversion is located 690 feet S. and 1,070 feet E. from the N 1/4 corner of Section 11.

Proposed area (100.5 Acres) for supplemental nursery use.

Tax lot Boundary

**RECEIVED**

FEB 18 2016

WATER RESOURCES DEPT  
SALEM, OREGON

**RECEIVED**

OCT 01 2015

OWRD

Scale: 1" = 1,320'

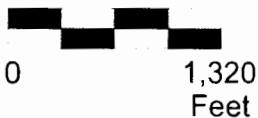

This map was prepared for the purpose of identifying the location of a water right only and is not intended to provide legal dimensions or location of property ownership lines.

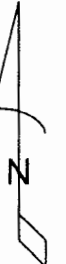

New Surface Water Application

5-88026

Heritage Seedlings (Lake Farm)  
T.8S. R.2W. Sec. 1, 2, 11, and 12

Pacific Hydro-Geology Inc.

5-88026 / 3-54994