

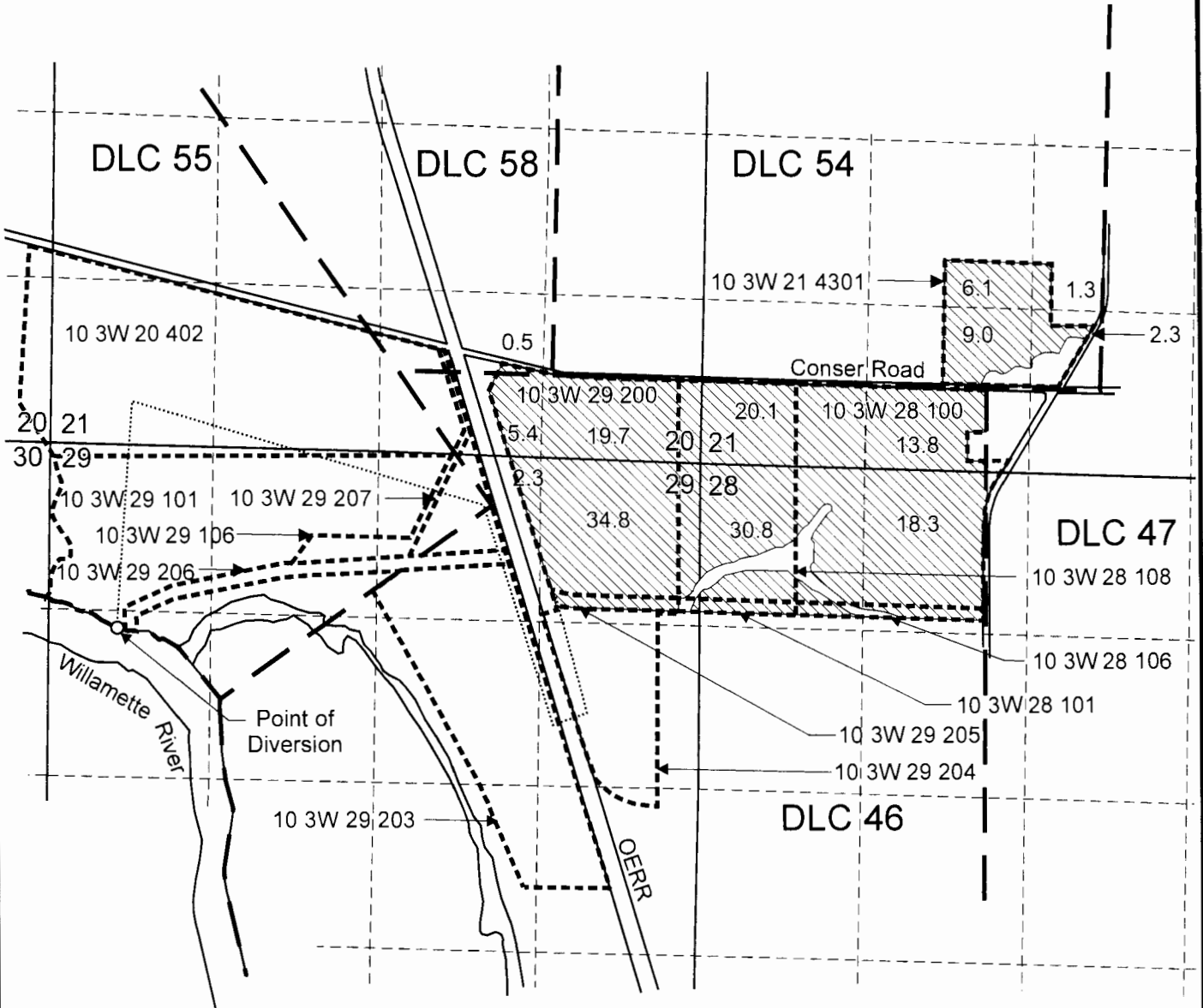

T.10S. R.3W. Sec. 20, 21, 28 & 29, W.M.



Point of diversion is located 535 feet east and 1,490 feet south from the NW Corner of Section 29.

 Area (164.4 Acres) proposed for irrigation use.

 Tax Lot Boundary

 12-inch Mainline

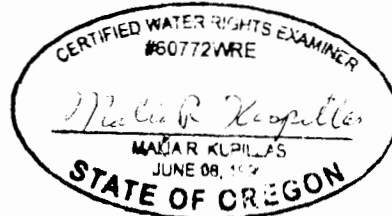

EXPIRATION DATE 6/30/17



Scale: 1" = 1,320'

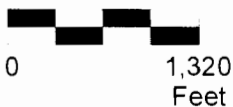

Water Right Application Map

Willamette Valley Land LLC
T.10S. R.3W. Sec. 20, 21, 28 & 29, W.M.

Pacific Hydro-Geology Inc.

2016-bgp

3-88199