

Application for a Water Right Permit in the name of Azalea Rojo, LLC Proposed Place of Use/Point of Re-Diversion

Township 28 South, Range 7 West, Section 27 (W.M.)

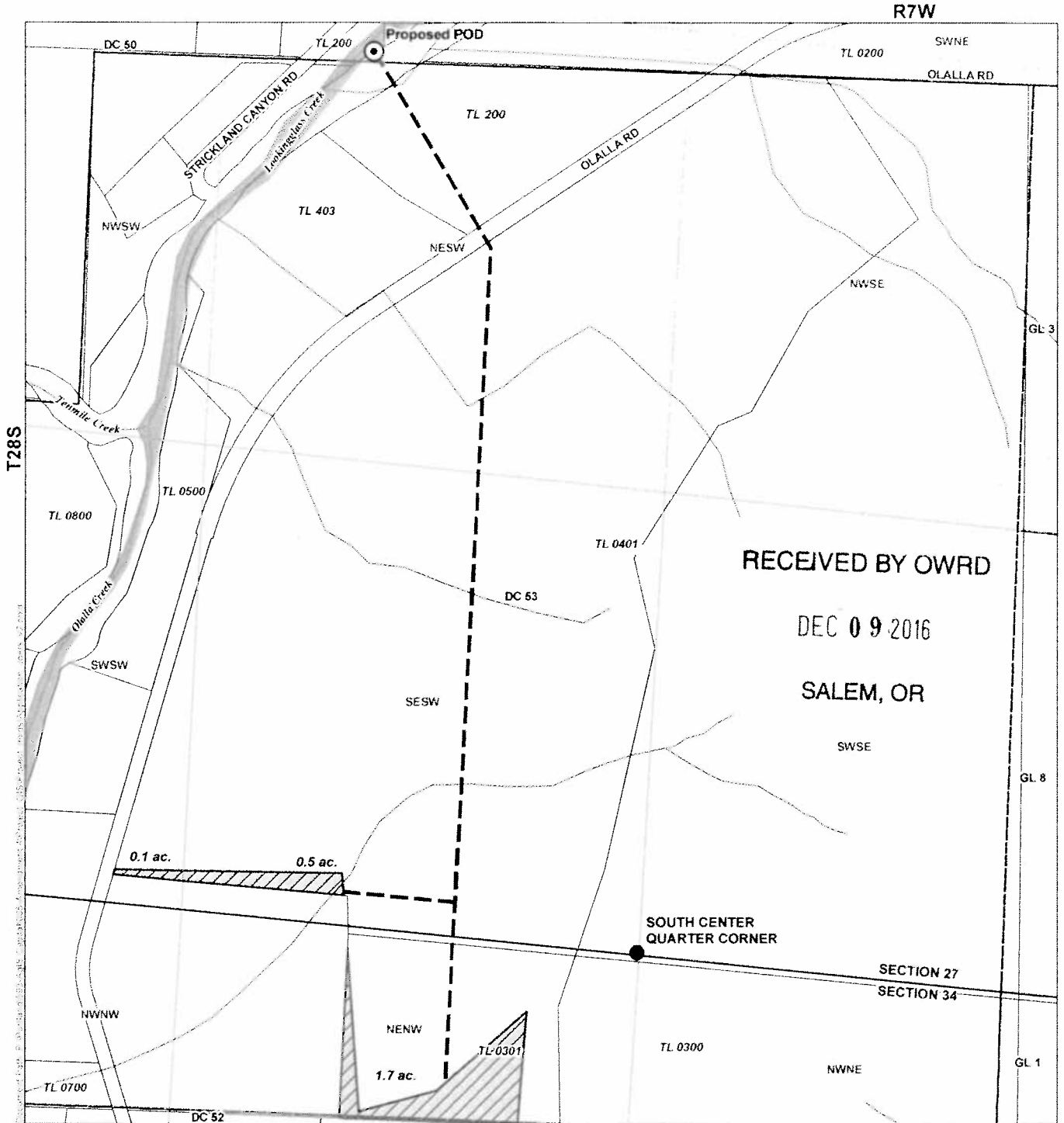

LEGEND

- Proposed Point of Re-Diversion (POD)
- Proposed Place of Use (POU)
- Pipeline
- Tax Lot (TL)
- Donation Land Claim (DC)
- Government Lot (GL)
- Watercourse
- Waterbody

DISCLAIMER

This map was prepared for the purpose of identifying the location of a water right only and it is not intended to provide legal dimensions or location of property ownership lines.

MAP NOTES

Date: October 27, 2016
Data Sources: BLM, Douglas Co., USGS

Proposed Point of Diversion

Located 2,510 feet North and 935 feet West from the South center quarter corner of Section 27, Township 28 South, Range 7 West (W.M.)

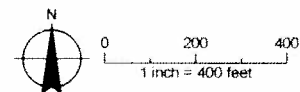



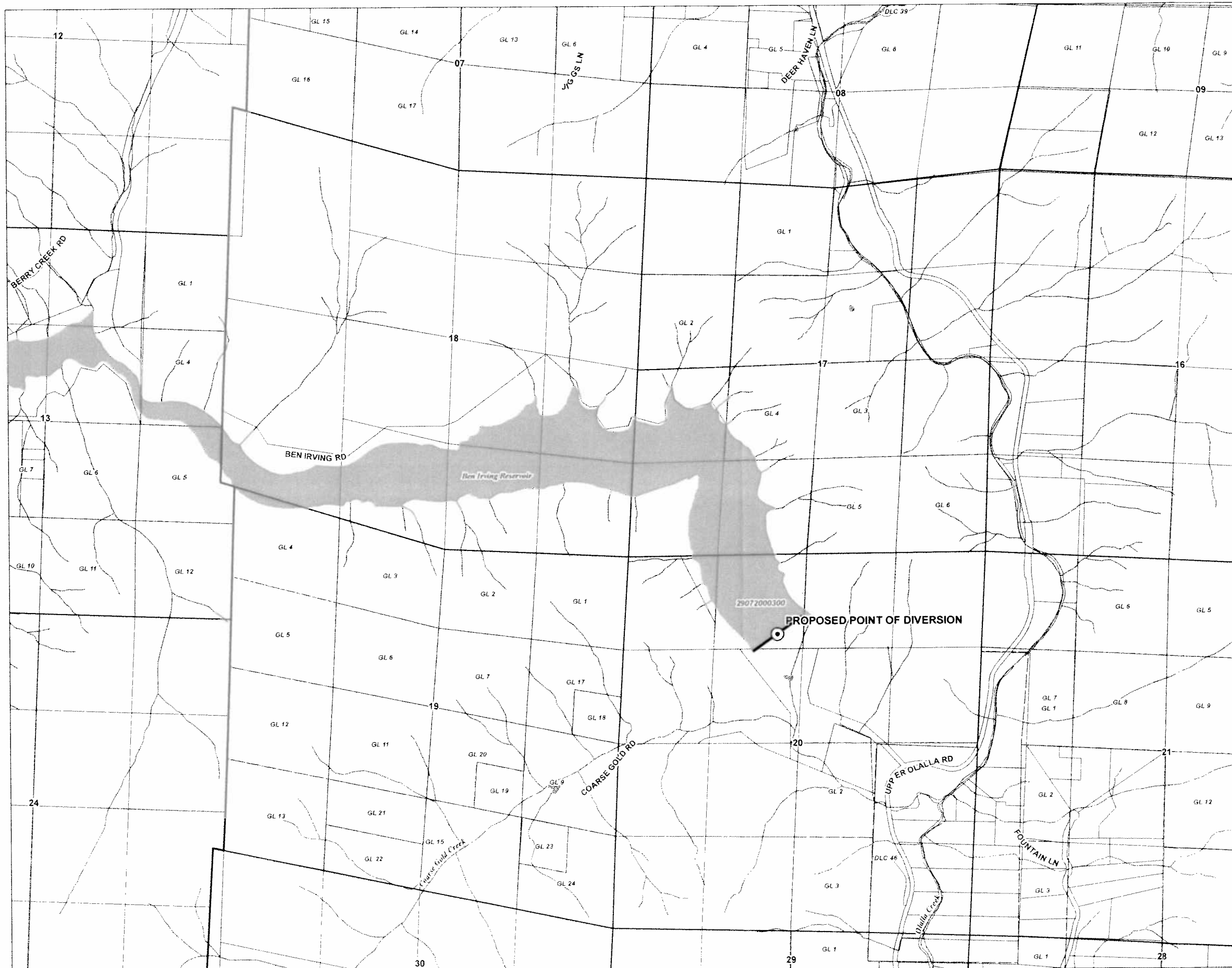



S-88341



**Permit Application Map
for the Use of Stored Water**
Point of Diversion Map
Township 29 South, Range 7 West, W.M.

LEGEND

-  Proposed Point of Diversion
-  Berry Creek Dam
-  Donation Land Claim (DLC)
-  Government Lot (GL)
-  Tax Lot
-  Watercourse
-  Waterbody

RECEIVED BY OWRD
DEC 09 2016
SALEM, OR

POD Location Description

Proposed Point of Diversion
Located 1,080 feet South and 2,060 feet East from the NW corner of Section 20, Township 29 South, Range 7 West (W.M.)

Disclaimer

This map was prepared for the purpose of identifying the location of a water right only and it is not intended to provide legal dimensions or location of property ownership lines

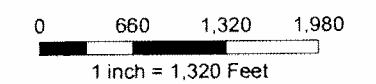
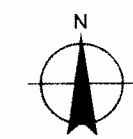

MAP NOTES:

Date: June 2, 2015
Data Sources: USGS, BLM, Douglas Co



S-88341