

Permit Application Map
Oregon Pacific Bank Trust Officer/Jody Tatone
T26S. R6W. Sections 5 and 6
Scale: 1" = 15,840
Douglas County

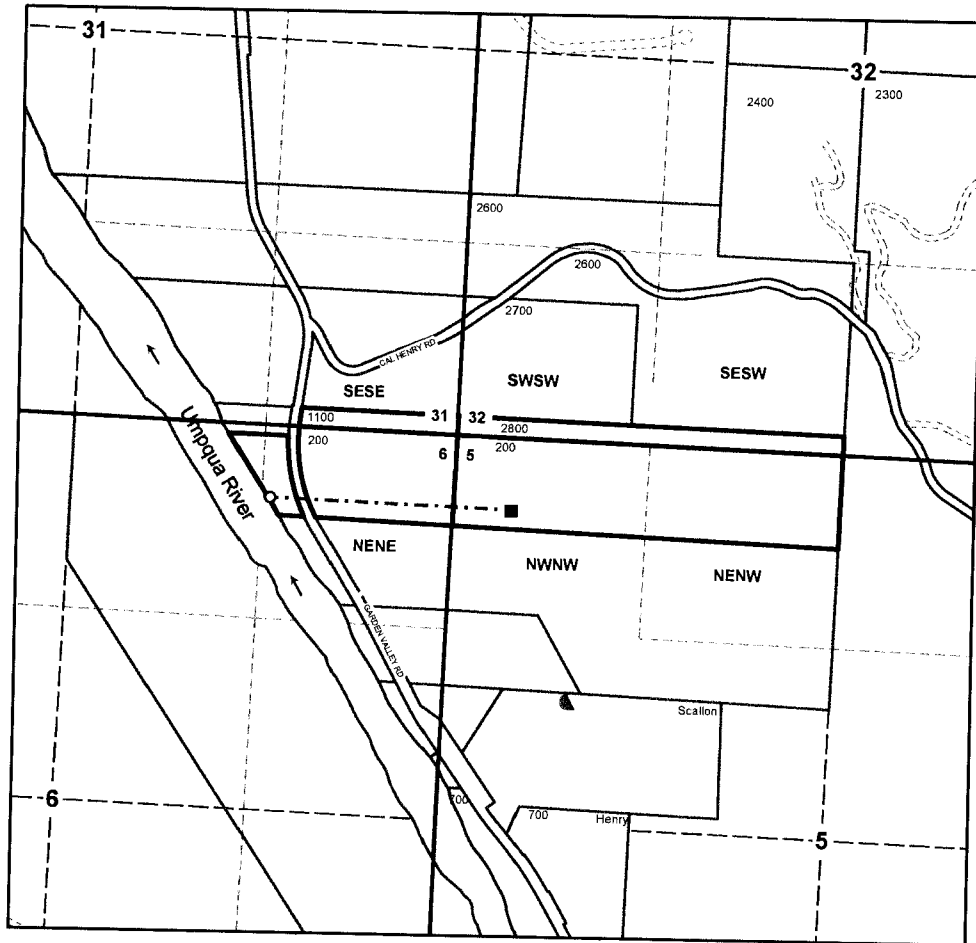
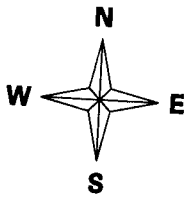

**Point of Diversion is 500 ft. South and 1300 ft. West
from the Northeast Corner of Section 6.**

RECEIVED

NOV 28 2016

CWRD
SALEM, OREGON