

**Water Right Application Map**  
**Greg Tillman-White**  
**SW 1/4 Sec. 3 T.28S. R.6W.**  
**Douglas County**  
**Scale: 1" = 500'**

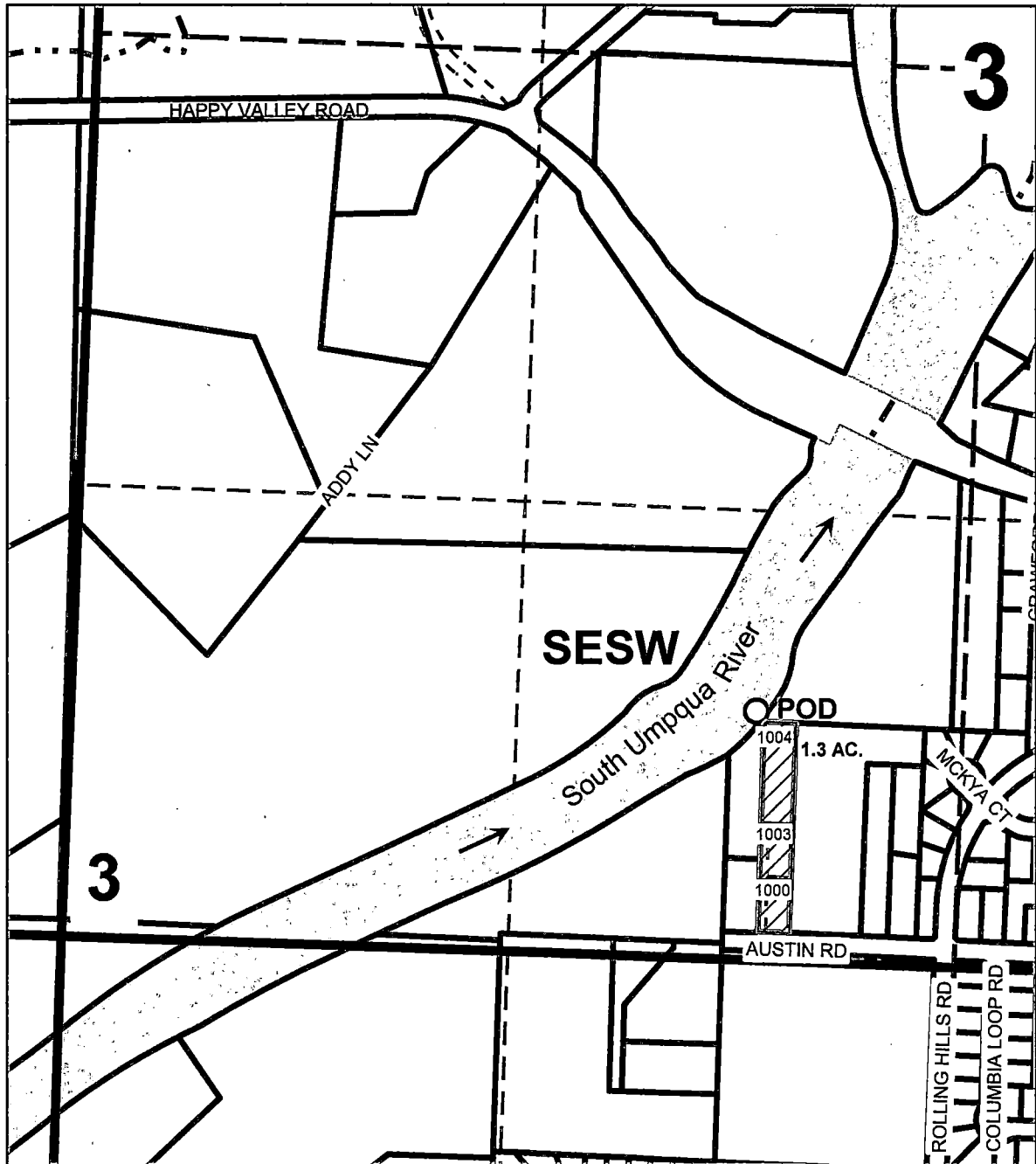
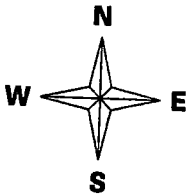

**Point of Diversion is 720 ft. North and 2075 ft. East from  
the Southwest quarter Corner of Section 3.**

RECEIVED BY OWRD

JUN 03 2016

SALEM, OR

S. 88239