

Water Right Permit Application Map

LaDonna M. Ollivant

10745 Lookingglass Rd.

Roseburg, OR 97471

SE 1/4 Section T. 28S. R.7W.

Douglas County

Scale 1" = 400"

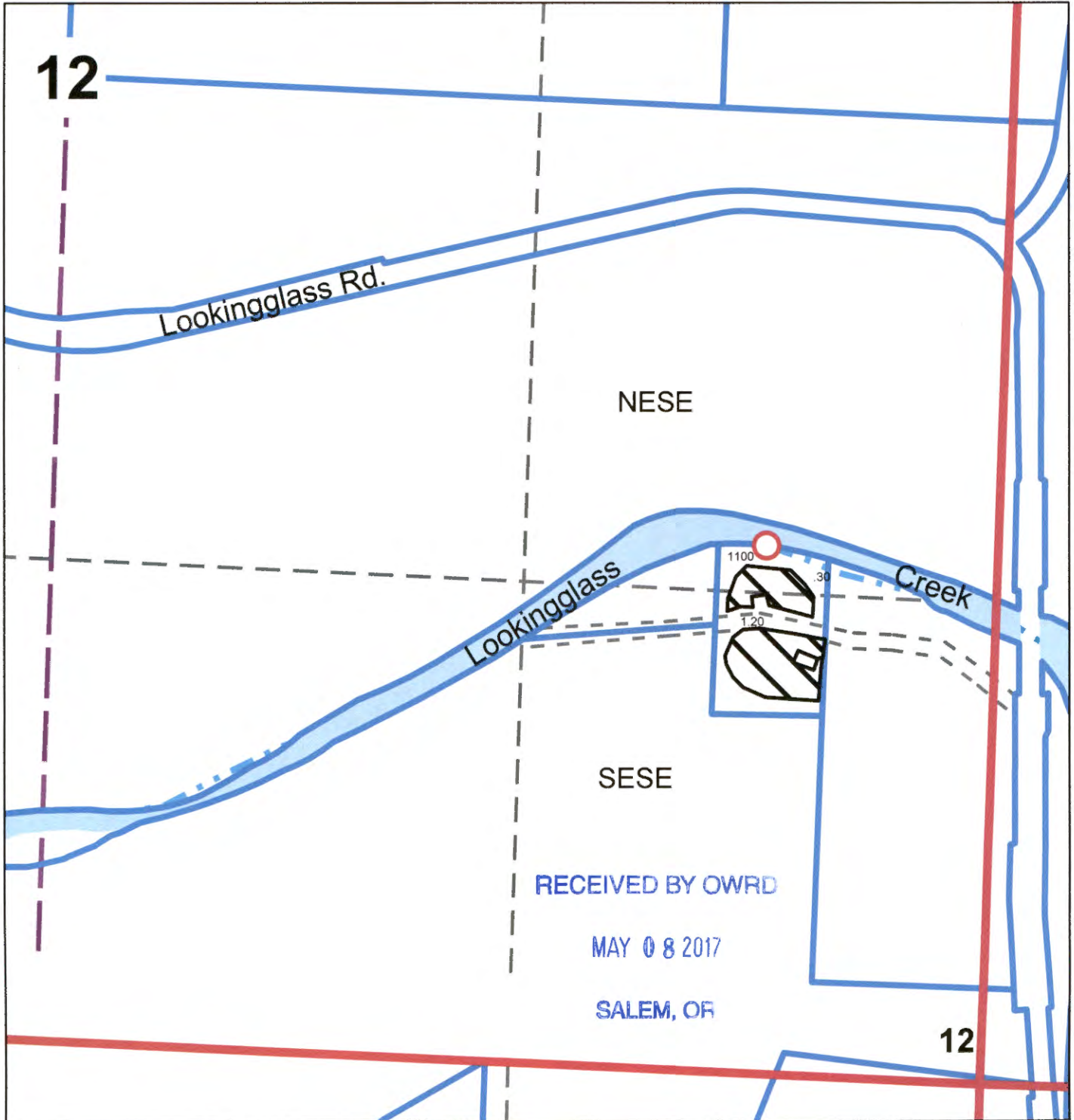

Point of Diversion is 1440 ft. North and 640 ft. West from the SE corner of Section 12

S-88406