

Application Map for Use of Stored Water
Map ID: 38S-4W-17 Tax Lot 503
Place of Use: 2.5 acres NE/SW
2 acres NW/SW

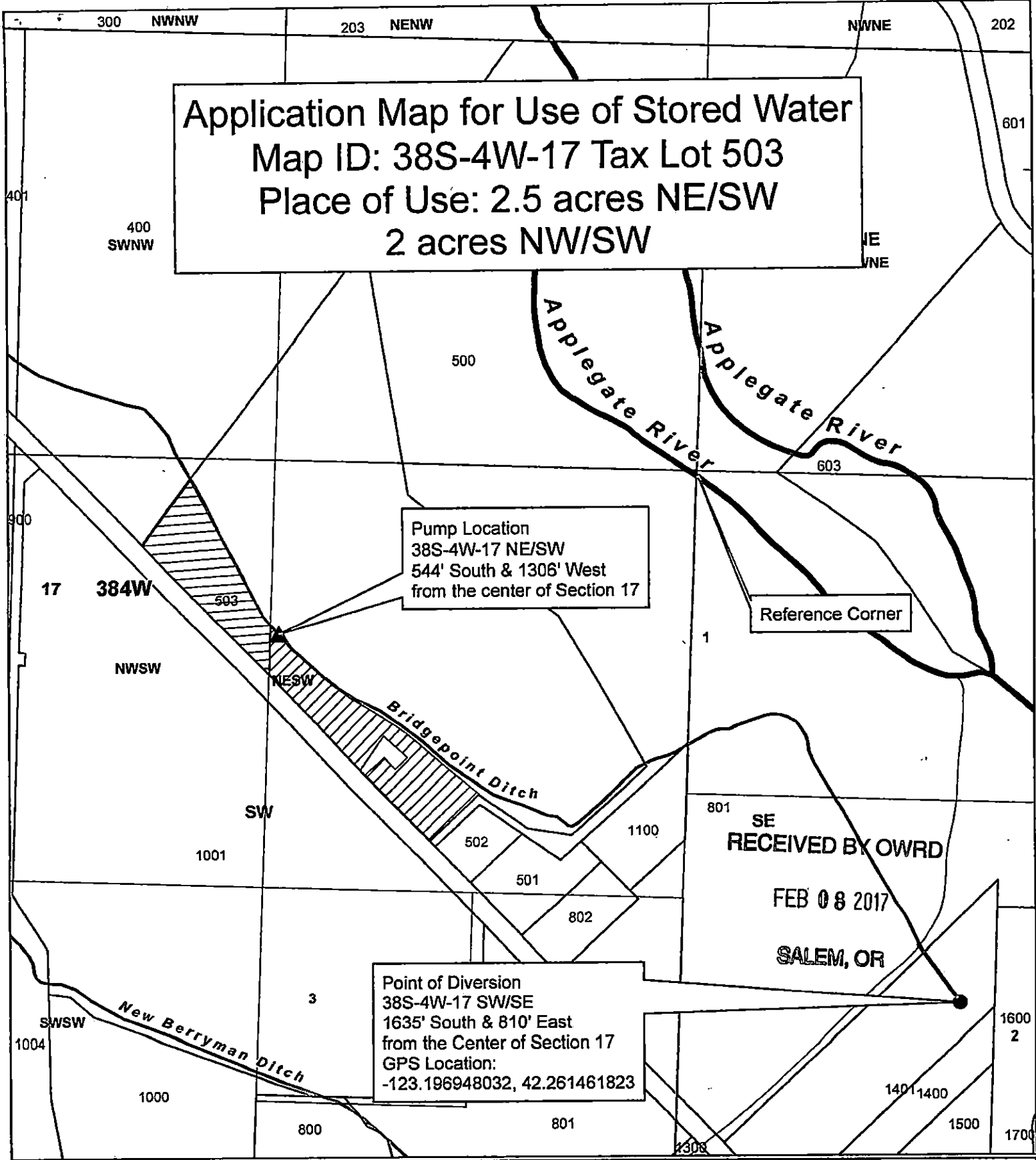

Legend

- Townships
- Sections
- Quarter Quarter Sections
- Quarter Sections
- Taxlots
- Taxlot 503
- Point of Diversion
- Pump Location
- Place of Use 2.5 acres NE/SW
- Place of Use 2 acres NW/SW

1 inch = 400 feet

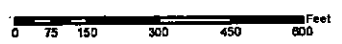

JACKSON COUNTY WATERMASTER

Prepared by Travis Kelly

This map is based on a digital database compiled by Jackson County from a variety of sources. Jackson County cannot accept responsibility for errors, omissions, or positional accuracy. There are no warranties, expressed or implied.

Date: 12/05/2014; 38-4W-17-503.mxd; KellyTM

S-98265