



Water Right Application Map
Thomas (Justin) Lindbloom
T.27S R.6W. Sections 5 and 6
Douglas County
Scale: 1" = 400'

RECEIVED BY OWRD

JUL 03 2017

SALEM, OR

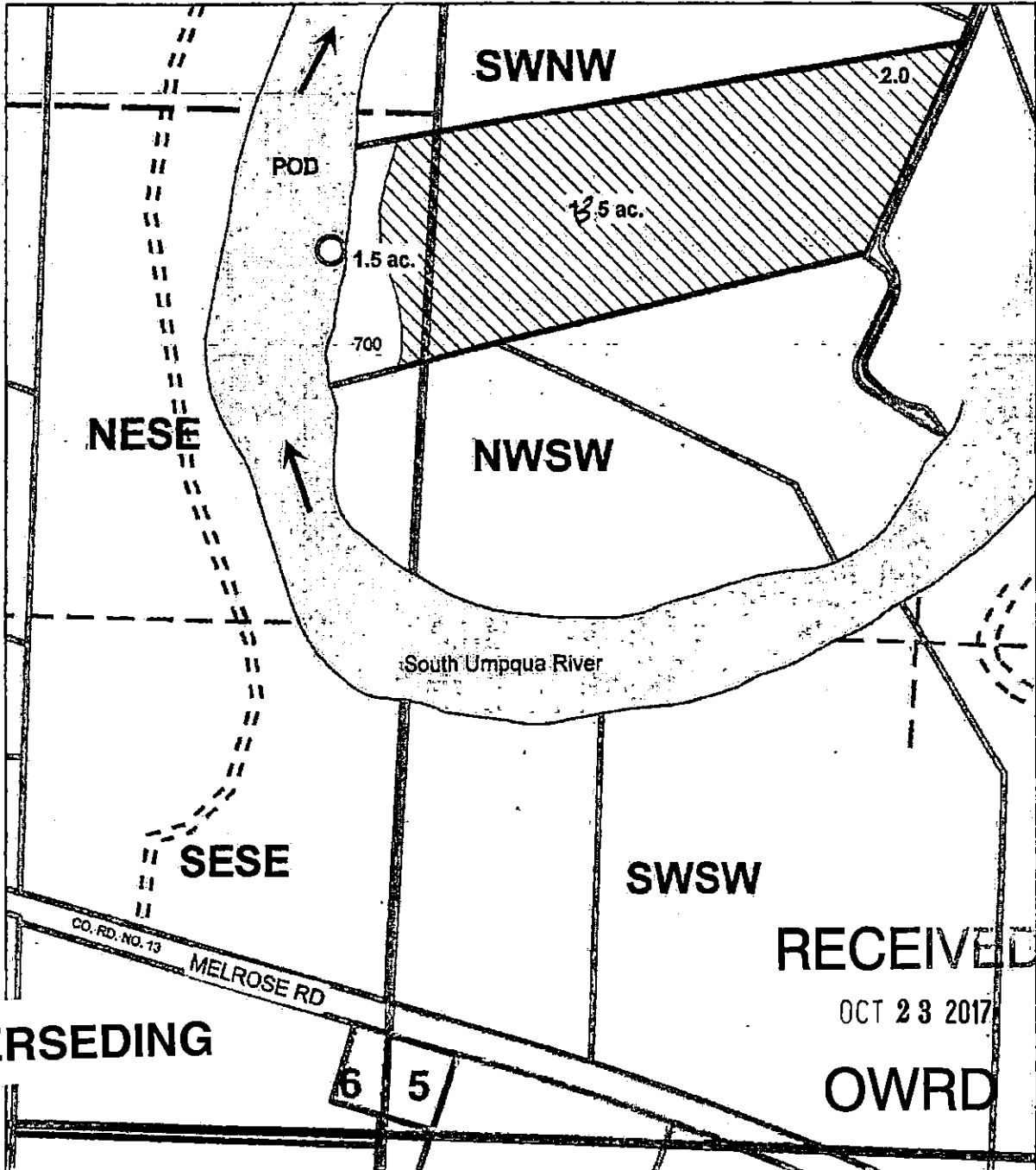

SUPERSEDING

RECEIVED

OCT 23 2017

OWRD

Point of Diversion is 2230 ft. North and 270 ft. West from the Southwest corner of Section 6.

RECEIVED BY OWRD

JUL 31 2017

SALEM, OR

S-88434

acreage amended 10-23-17
ST