

T8S, R3W, WM

MARION COUNTY

TAX LOT:
083W34 01000

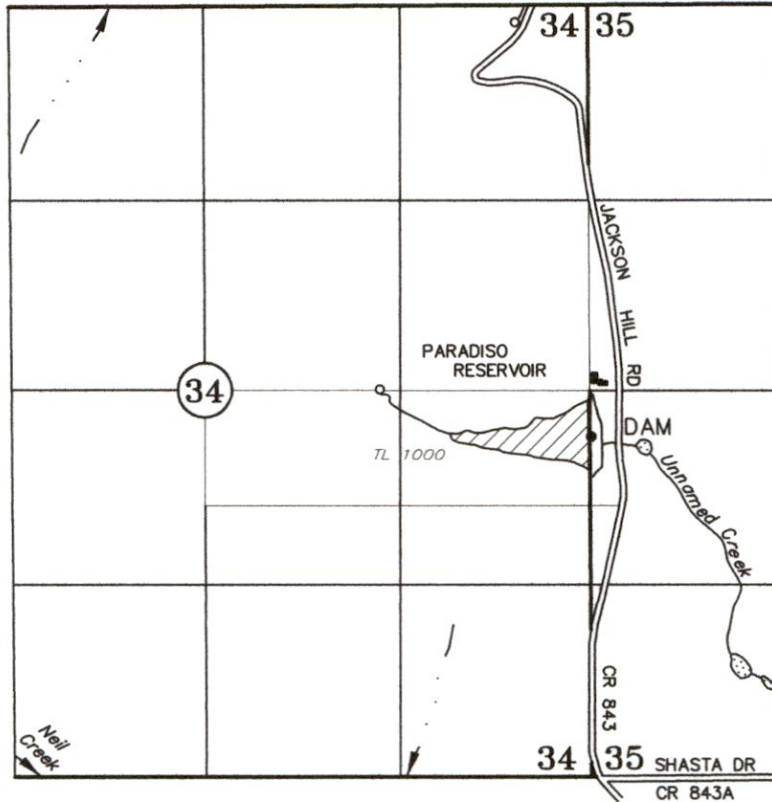

DAM: 315' S & 9' E OF E 1/4 COR SEC 34

APPLICATION TO CONSTRUCT A RESERVOIR

UNDER

Application No. _____ Permit No. _____

RECEIVED

MAR 13 2014

IN THE NAME OF

Meduri Farms, Inc.

WATER RESOURCES DEPT
SALEM, OREGON

FEBRUARY 28, 2014

SCALE: 1" = 1320'



NOTE: This map is not intended to provide legal dimensions or locations of property ownership lines.

EXPIRES 12-31-15

R-87965