

DOMESTIC WATER FOR THE WEST 1/2 OF S-W 1/4 OF SE 1/4 OF SEC-23

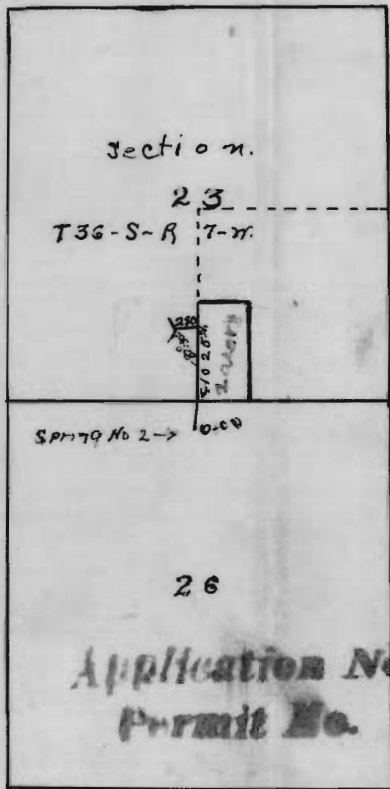

STA- Angles. Cal. Course.
 0+00-Point on Cen. line. 1025' North of 1/4 cor. $\frac{23}{26}$
 52°30' South 00°
 S 82°30' W.
 2+80 = Spring
 From 2+80 North 30° West 150'
 From 2+80 South 60° West 100'

SPRING NO 2
 0+00 is South 300' S-S° W. From 1/4 cor $\frac{23}{26}$
 From 0+00 to 2+00 is Spring.
 3+00 = 1/4 cor. $\frac{23}{26}$ = The END.

Application No.
 Permit No.

8448
 5512

STATE ENGINEER
 RECEIVED

JUN 13 1922

SALEM, OREGON

2772