

RECEIVED

JUN 15 1998

WATER RESOURCES DEPT.
SALEM, OREGON

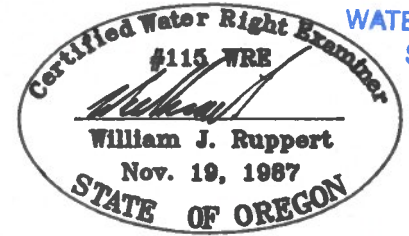

EXPIRES 12/31/98

MAP PREPARED BY WILLIAM J. RUPPERT
P.O. BOX 1564
MYRTLE CREEK, OR 97457

RIVERS WEST DEVELOPMENT, INC.
2201 WHISTLERS PARK RD.
ROSEBURG, OR 97457

MAP TO ACCOMPANY
APPLICATION FOR
STORED WATER
APPLICATION S-81436

T 29 S, R 5 W, WM

LOT 4

LOT 5

LOT 6

LOT 8

THIS MAP TO BE
USED FOR WATER
RIGHT PURPOSES ONLY.

June 12, 1998

MAP BASED ON
ASSESSOR'S PLAT



SCALE 1"=400'

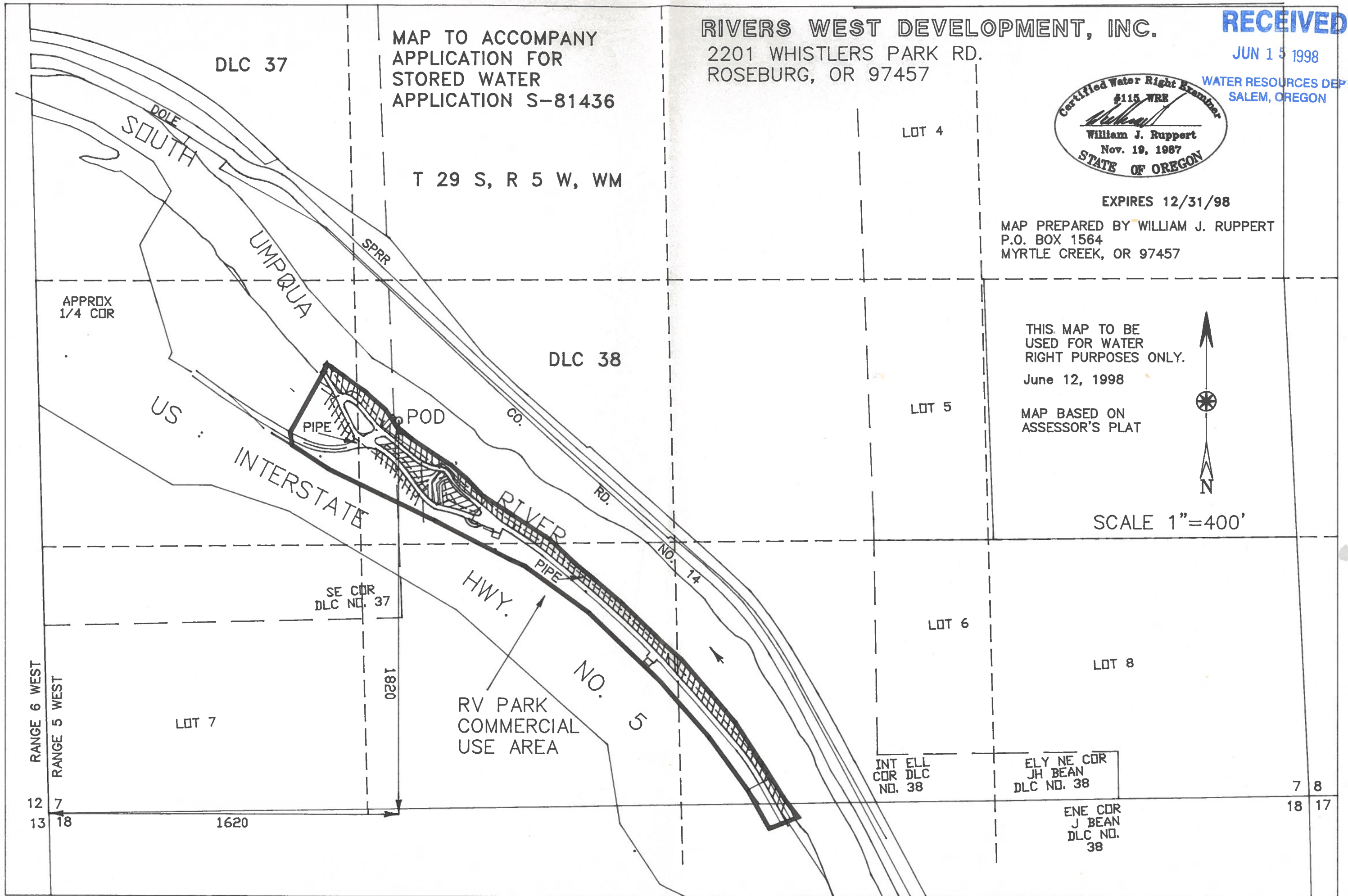

APPROX
1/4 COR

DLC 38

INTERSTATE

HWY.

RV PARK
COMMERCIAL
USE AREA

SE COR
DLC NO. 37

1820

LOT 7

INT ELL
COR DLC
NO. 38

ELY NE COR
JH BEAN
DLC NO. 38

ENE COR
J BEAN
DLC NO.
38

7 8

18 17

RANGE 6 WEST
RANGE 5 WEST

12 7
13 18

1620