

LEGEND

- | | |
|---|--|
| <p>Proposed Place of Use (POU)
Application S-86761</p> <p> 74.07 ac., IS, 3.0 of Stored Water (Permit R-15093)</p> <p>Place of Use (POU), Other Water Rights
Application S-86759</p> <p> IR, IS (refer to separate application)</p> | <p>All Other Features</p> <p> Roserock Property</p> <p> Tax Lot</p> <p> Watercourse</p> <p> Waterbody</p> |
|---|--|

Application S-86761 (Map 2 of 2)
In the Name of Roserock Middle, LLC
Polk County

Date: March 8, 2018
Data Sources: Polk Co., ESRI, OGIC, USGS

NOTE:
*These 46.06 acres of supplemental irrigation under this application (S-86761) requested to become primary if the primary irrigation under T-10440 and Application S-86759 is not developed.

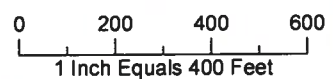

S-86761

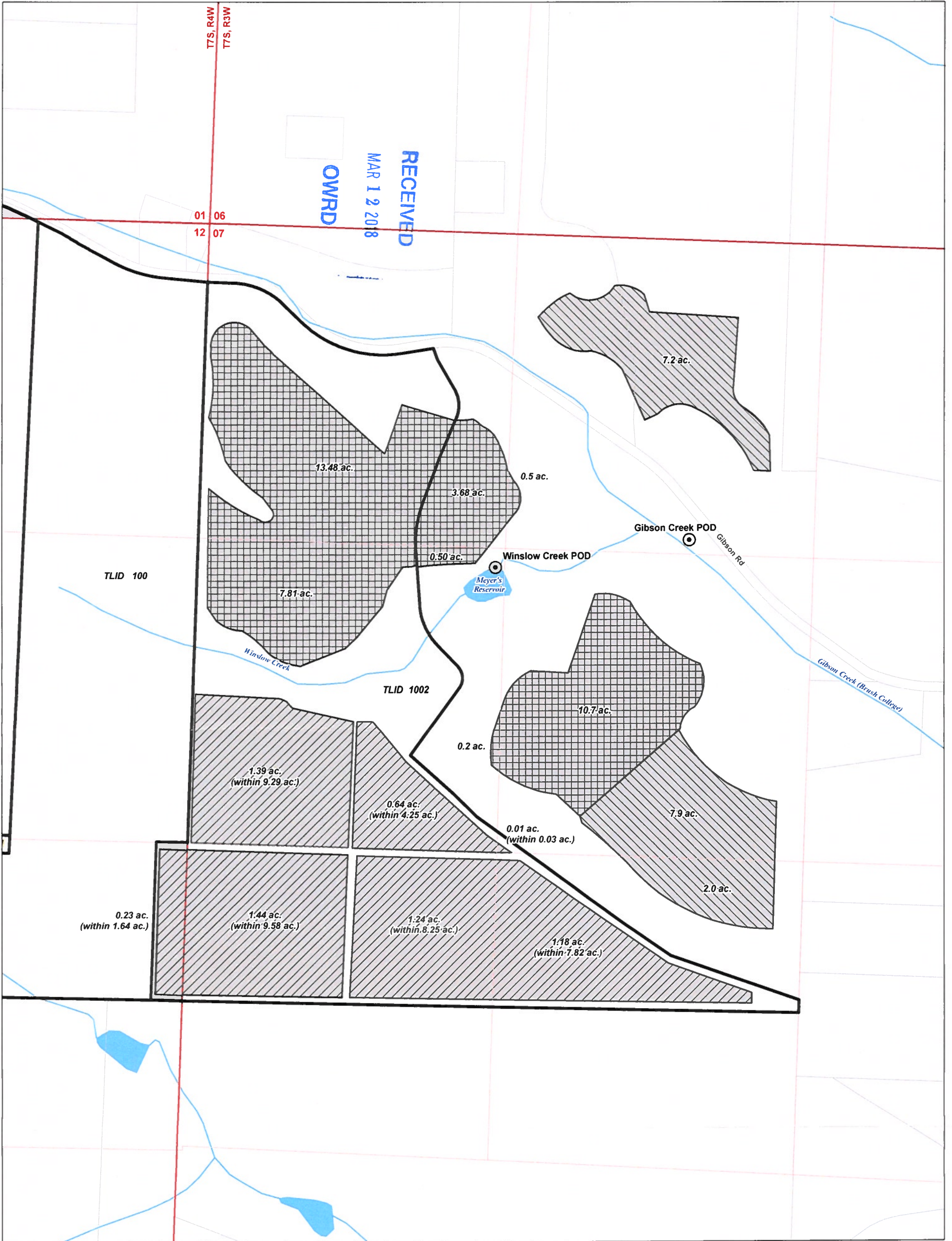

LEGEND

- ⊙ Point of Diversion (POD)
- Place of Use**
 - 85782, IR, Gibson Creek
 - 85782, IS, Gibson Creek
 - 85783, IR, Winslow Creek and Stored Water
 - T10440, IR, Winslow Creek and Stored Water IS, Gibson Creek
- All Other Features**
 - Roserock Property
 - Tax Lot
 - Watercourse
 - Waterbody

**Existing Water Rights
In the Name of Roserock East, LLC
Polk County**

Date: March 8, 2018
Data Sources: Polk Co., ESRI, OGIC, USGS

1 Inch Equals 400 Feet

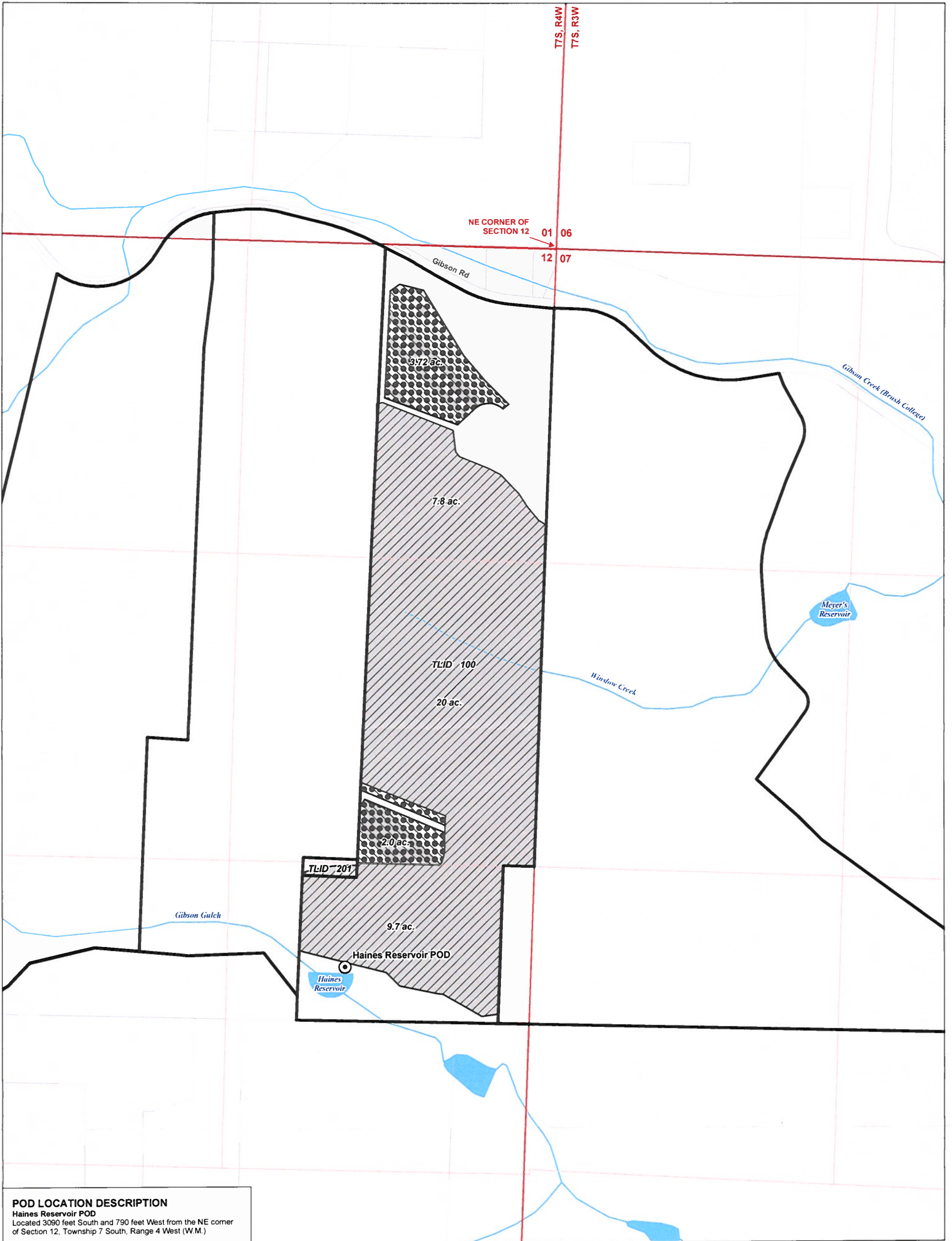

POD LOCATION DESCRIPTION
Haines Reservoir POD
 Located 3090 feet South and 790 feet West from the NE corner of Section 12, Township 7 South, Range 4 West (W.M.)

LEGEND		Application S-86761 (Map 1 of 2)	
<ul style="list-style-type: none"> ⊙ Existing and Proposed Point of Diversion (POD) Proposed Place of Use (POU) Application S-86761 5.72 ac., IR, 0.072 cfs, Gibson Gulch 74.07 ac., IS, 3.0 af Stored Water (permit R-15093) Place of Use (POU), Other Water Rights 41749 37.5 ac., IR, 0.47 cfs Gibson Gulch and Stored Water (41748) 	<ul style="list-style-type: none"> All Other Features Roserock Property Tax Lot Watercourse Waterbody 	<p>In the Name of Roserock Middle, LLC Polk County</p> <p style="font-size: 2em; color: blue; transform: rotate(-90deg); display: inline-block;">RECEIVED MAR 12 2018 OWRD</p>	
<p>Date: March 8, 2018 Data Sources: Polk Co., ESRI, OGIC, USGS</p>		 	

S-86761