

T.4S. R.3W. Sec. 29 & 30, W.M.

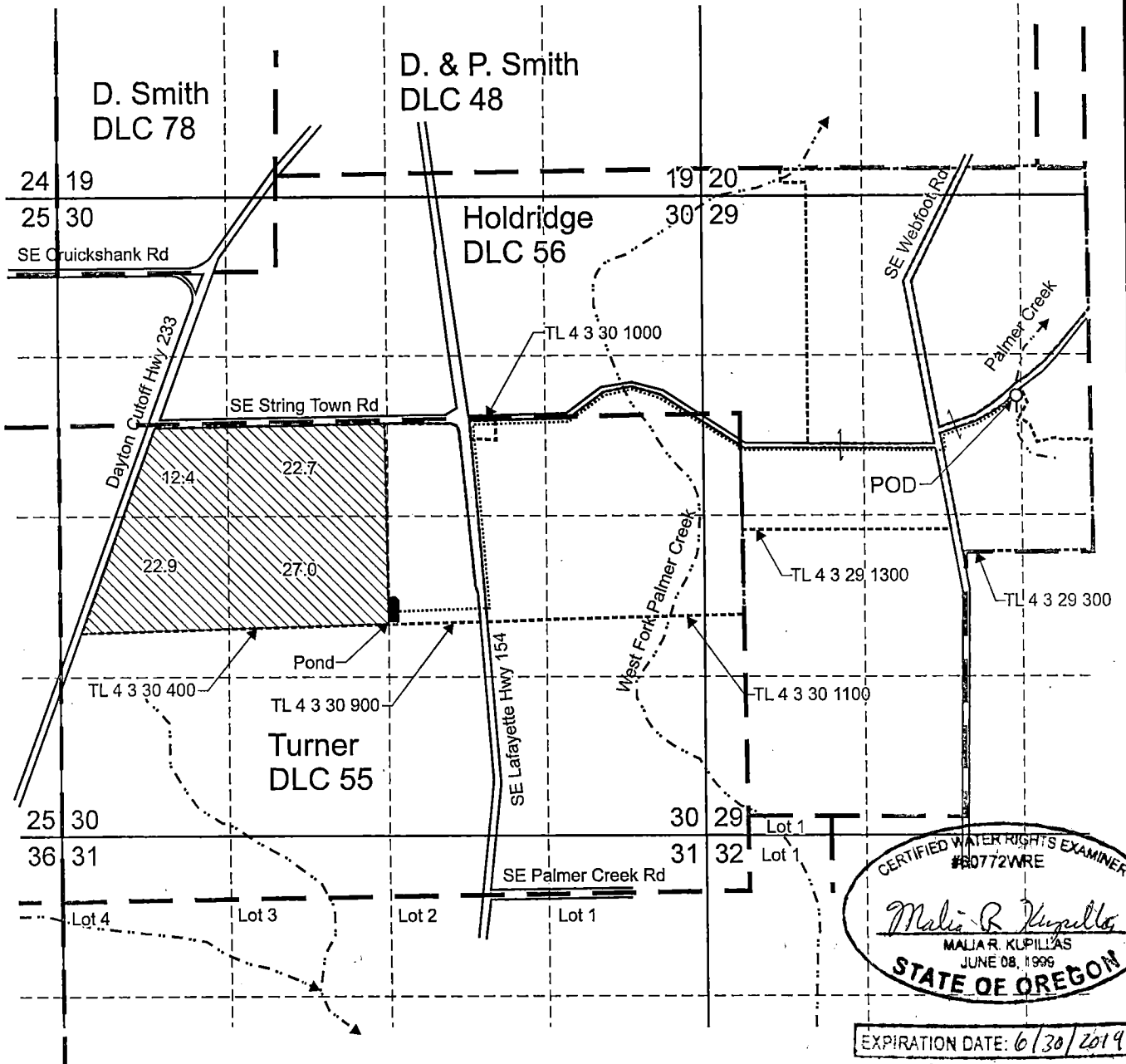

CERTIFIED WATER RIGHTS EXAMINER
 #60772WRE
Malia R. Kupillas
 MALIA R. KUPILLAS
 JUNE 08, 1996
 STATE OF OREGON

EXPIRATION DATE: 6/30/2019

Proposed POD is located 1,655 feet south and 2,600 feet east from the NW corner, Section 29.

- Area (85.0 Acres) to be irrigated.
- Tax lot boundary
- Donation Land Claim boundary
- Mainline

Scale: 1" = 1,320'

RECEIVED

AUG 31 2017

OWRD

This map was prepared for the purpose of identifying the location of a water right only and is not intended to provide legal dimensions or location of property ownership lines.

Water Right Application Map

Palmer Creek Water District
 Improvement Company
 T.4S. R.3W. Sec. 29 & 30, W.M.

08/2017

Pacific Hydro-Geology Inc.

KCKSWAppMap.cdr

S-88454

T.6S. R.3W. Sec. 4, W.M.

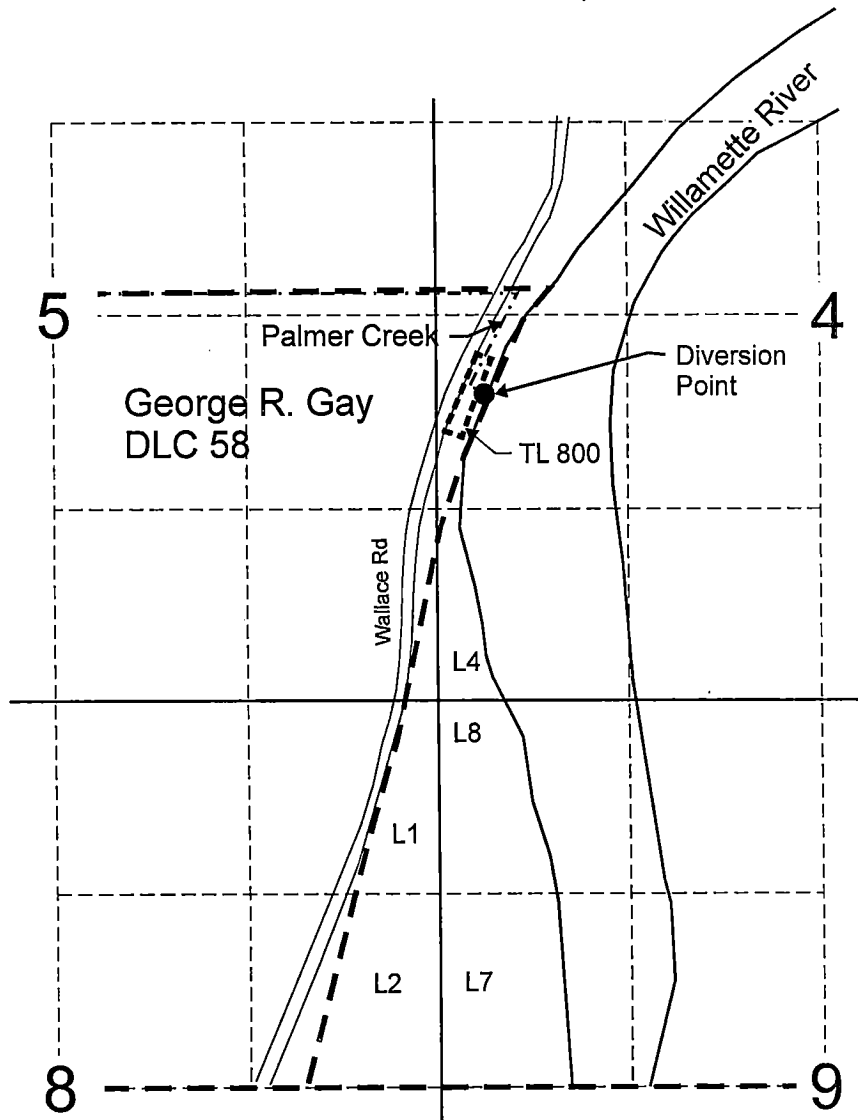

POD is located 690 feet south and 110 feet west from the NE corner of Gay DLC 58.

- - - - Main Canal
- - - - Tax lot boundary

RECEIVED

AUG 31 2017

OWRD

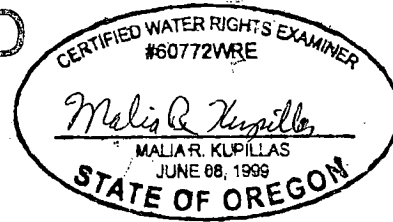

EXPIRATION DATE: 6/30/19

Scale: 1" = 1,320'

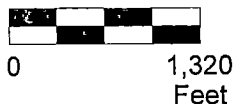

This map was prepared for the purpose of identifying the location of a water right only and is not intended to provide legal dimensions or location of property ownership lines.



PCWDIC Diversion Point

Palmer Creek Water District Improvement Company
T.6S. R.3W. Sec. 4, W.M.

Pacific Hydro-Geology Inc.

08/2017

POD.cdr

S-88454