

**Application Map**  
**Bradford R. Rackleff and Christa Sherwood-Garman**  
**NW 1/4 Section T. 26S. R. 5W. W.M.**  
**Douglas County**  
**Scale: 1" = 400'**

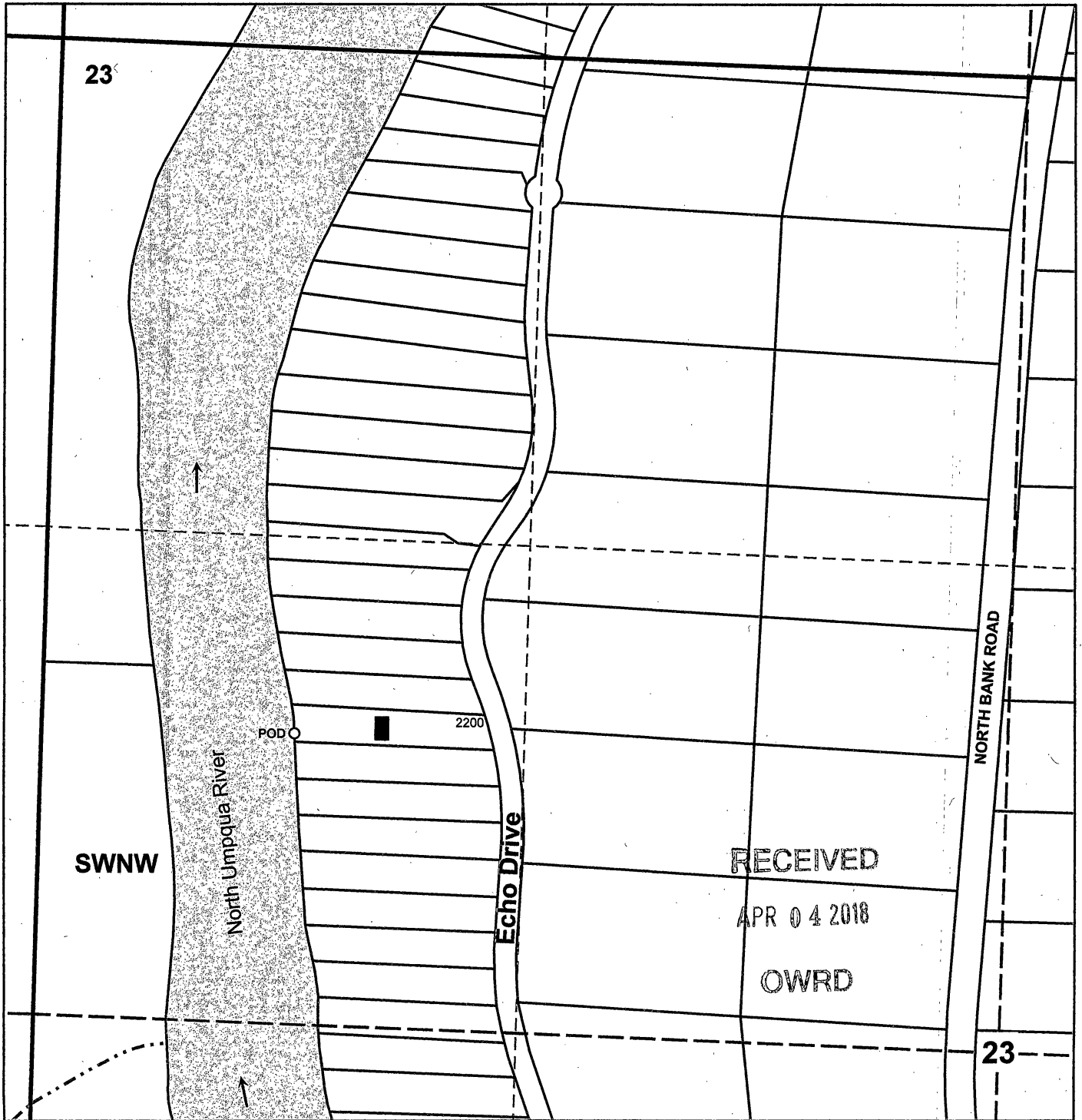
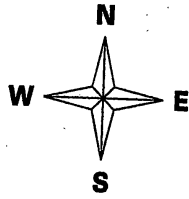

**Point of Diversion is 780 ft. North and 680 ft. East from the West quarter section corner of Section 23.**

S-88572