

**Application Map**  
**Erleen and J Simms**  
**NE 1/4 SEC.19 T.26S. R.6W. WM**  
**Douglas County**  
**Scale: 1"= 600'**

RECEIVED  
JUN 06 2019  
OWRD

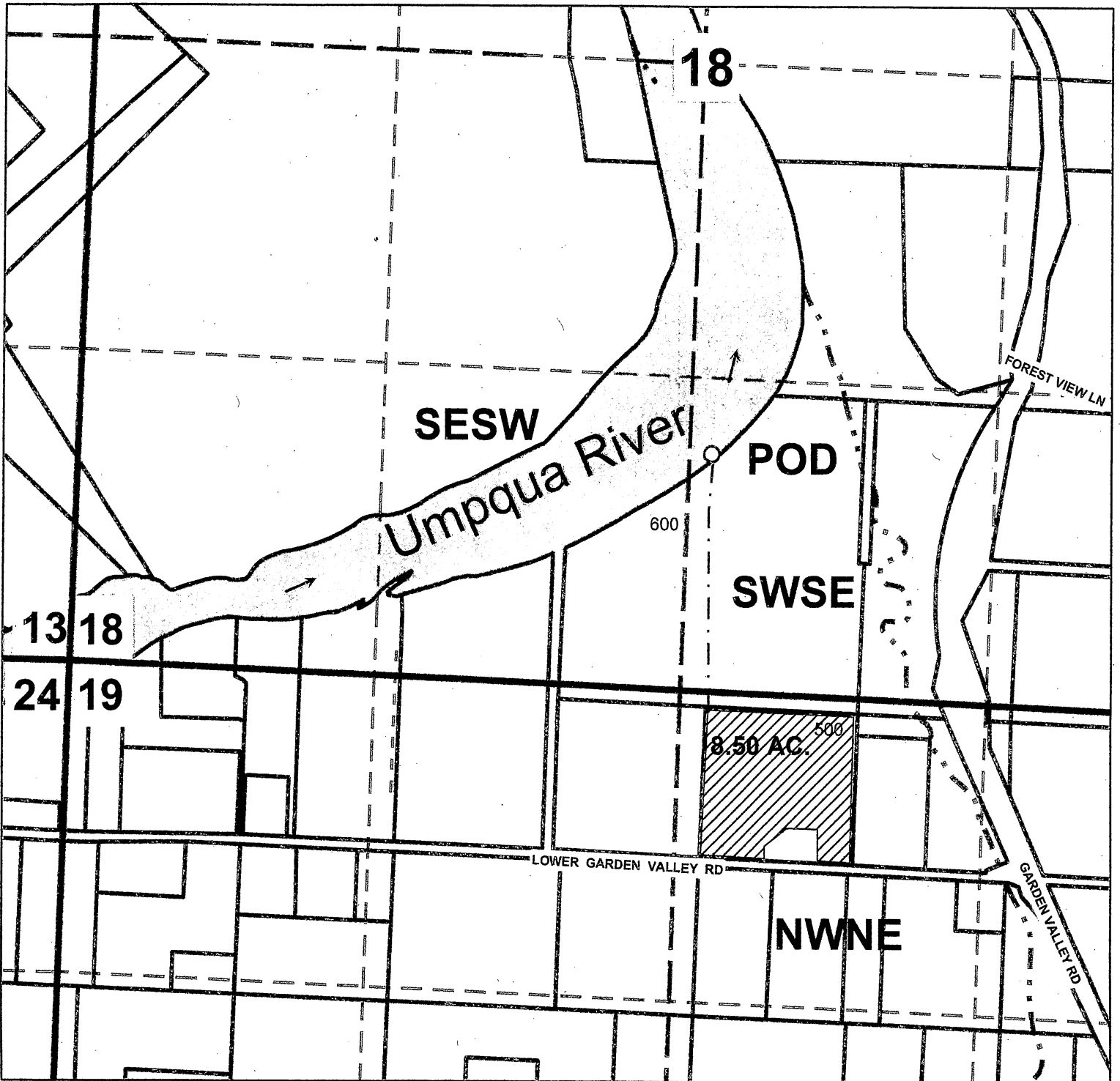

**Point of Diversion is 975 ft. North and 2750 ft. East of the South West quarter corner of Section 18**