

**Whistlers Bend Park
Douglas County, Oregon
T.26S. R.4W. Sections 7 and 18
Scale: 1" = 1320'**

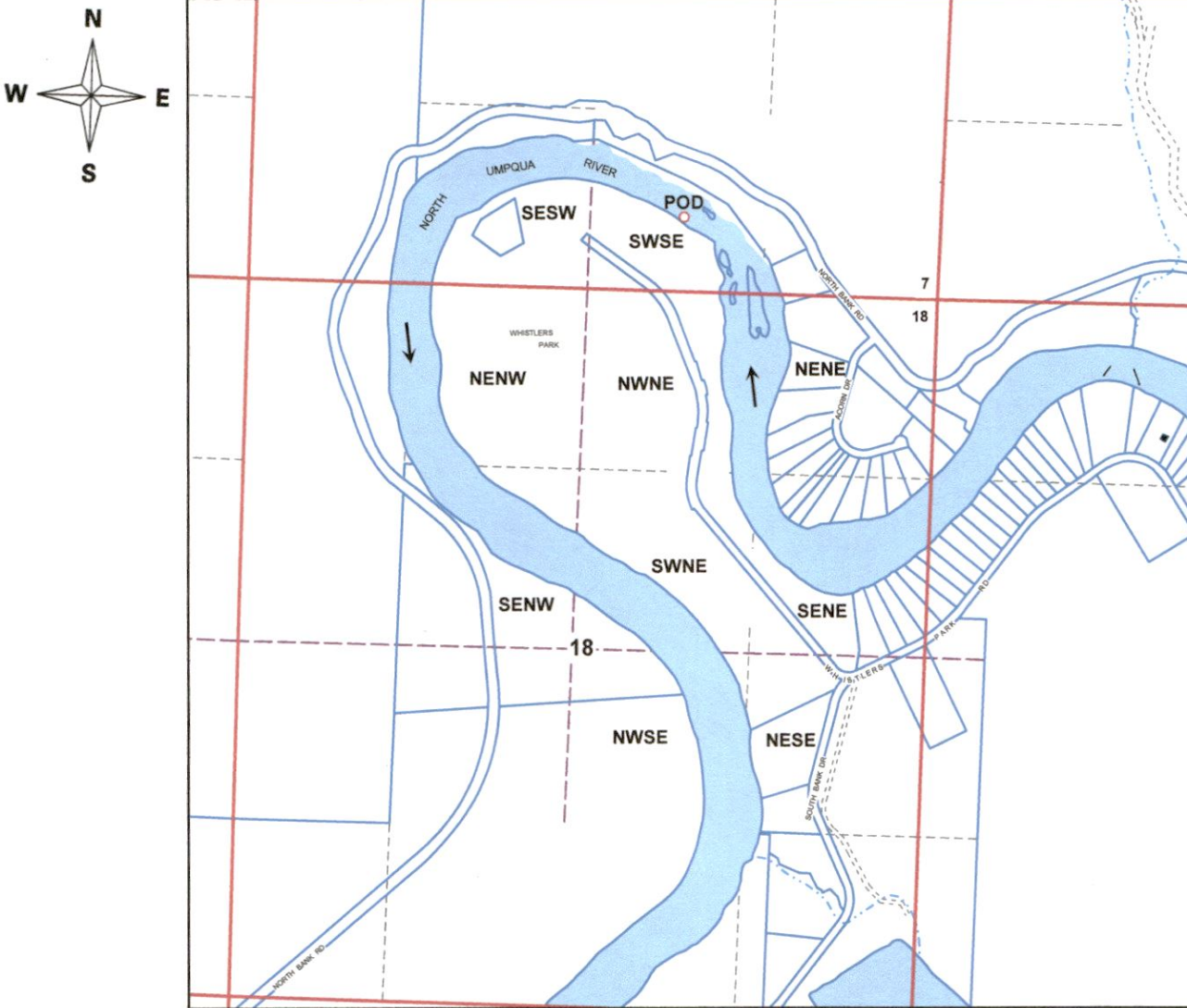

**Point of Diversion is 550 ft. North and 1900' West
from the SE Corner of Section 7.**

RECEIVED BY OWRD

APR 13 2017

SALEM, OR

S-88391