

T.34S., R.1W., W. M.

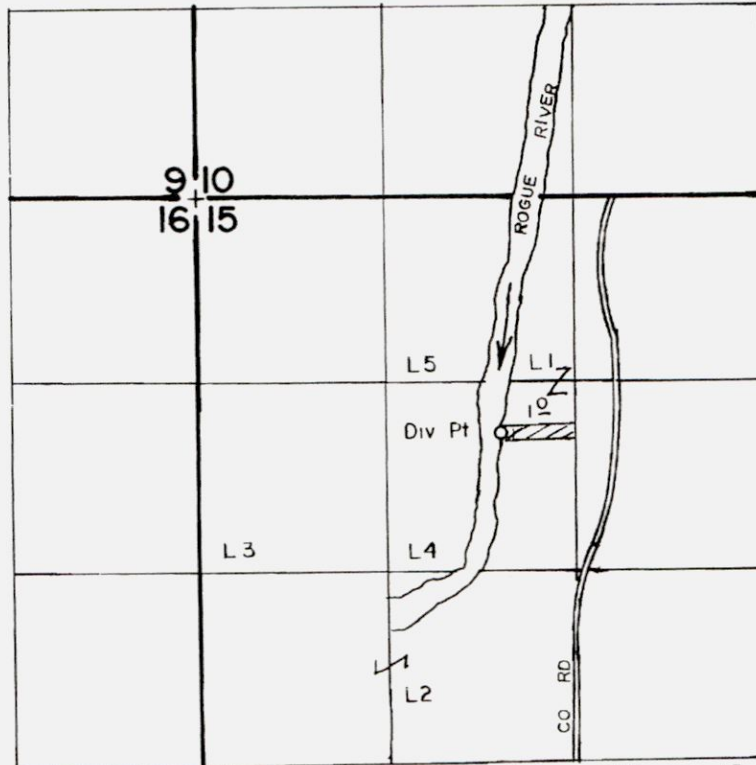

Div Pt Located 1000' N & 510' W From The Center 1/4 Corner Of Section 15

SCALE: 1" = 1320'

FINAL PROOF SURVEY UNDER

TRANSFER NO 5902

Application No. Permit No.
IN NAME OF

JANE L & RENA F. NEUNER

Surveyed MARCH 26 1990., by B.S. JAMES

RECEIVED BY OWRD

OCT 30 2017

SALEM, OR