

RECEIVED
NOV 18 2019
OWMRD

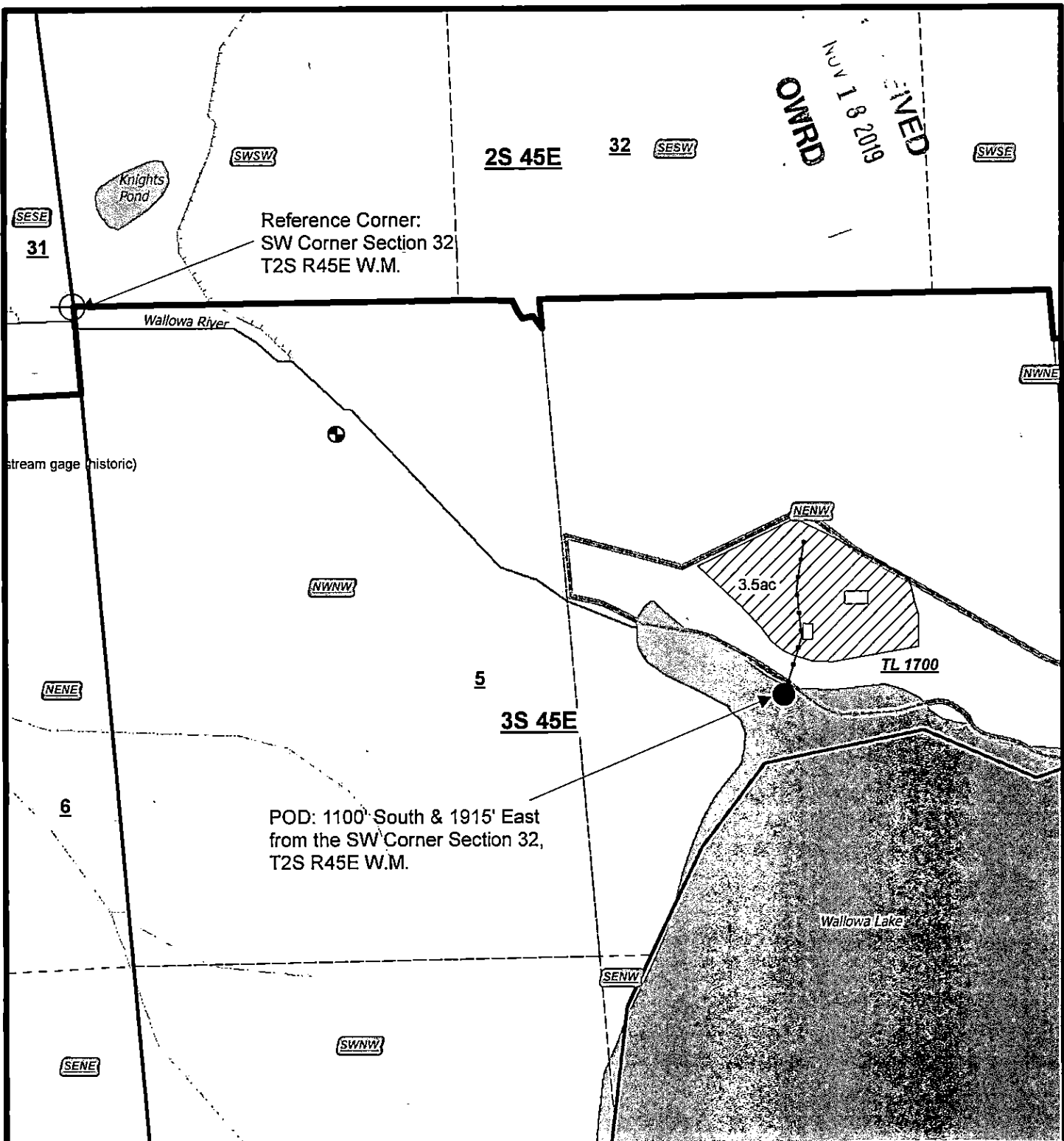

WLID application to irrigate 3.5 acres, Source: Wallowa Lake Reservoir

Map Disclaimer:
This product is for informational purposes and may not have been prepared for, or be suitable for legal, engineering, or surveying purposes. Users of this information should review or consult the primary data and information sources to ascertain the usability of the information. This map is not intended to display property lines

Disclaimer: This listing is the result of a manual search of the records of the Watermaster's Plat Cards and the WRIS database. The listing has not been field checked. That a right of record is no guarantee that is has not been abandoned under the conditions of ORS 540.610. The plat card records of listed by the 40.0 acre quarter quarter within a section. If the water right listed within a quarter-quarter is on more than one tax lot, this office has not itemized that water rights for each tax lot- only a survey could accurately depict how much of the water rights are on each tax lot.

Irrigated area	D7_TWP
WLID Tax Lot 1700	D7_SEC
Pipeline	D7_QQ
	Stream, perennial
	Stream, intermittent
	Canal
	Connector
	Lake

N
Scale 1in=400ft
 District 7 Watermaster