



Surface Water Application  
Ross/Ross/Moore  
T.29 &30S R.5W Section 6 & 31  
Douglas County  
Scale: 1"=800'

RECEIVED

JUL 26 2021

OWRD

Tax lot 100  
Richard Ross  
1.00 acres Supplemental  
Cert 54152

Tax lot 1200  
Ernest Ross  
1.0 acre Supplemental  
Cert 85671  
0.3 acre Primary

Tax lot 600  
Forrest Moore  
1.0 acres Supplemental  
Cert 85671  
Domestic Expanded

Legend

-  Domestic Expanded (Moore)
-  1.0 acre Supplemental (E. Ross)
-  4.0 acre Supplemental (Moore)
-  0.3 acre Primary (E. Ross)
-  10.0 acres Supplemental (R. Ross)

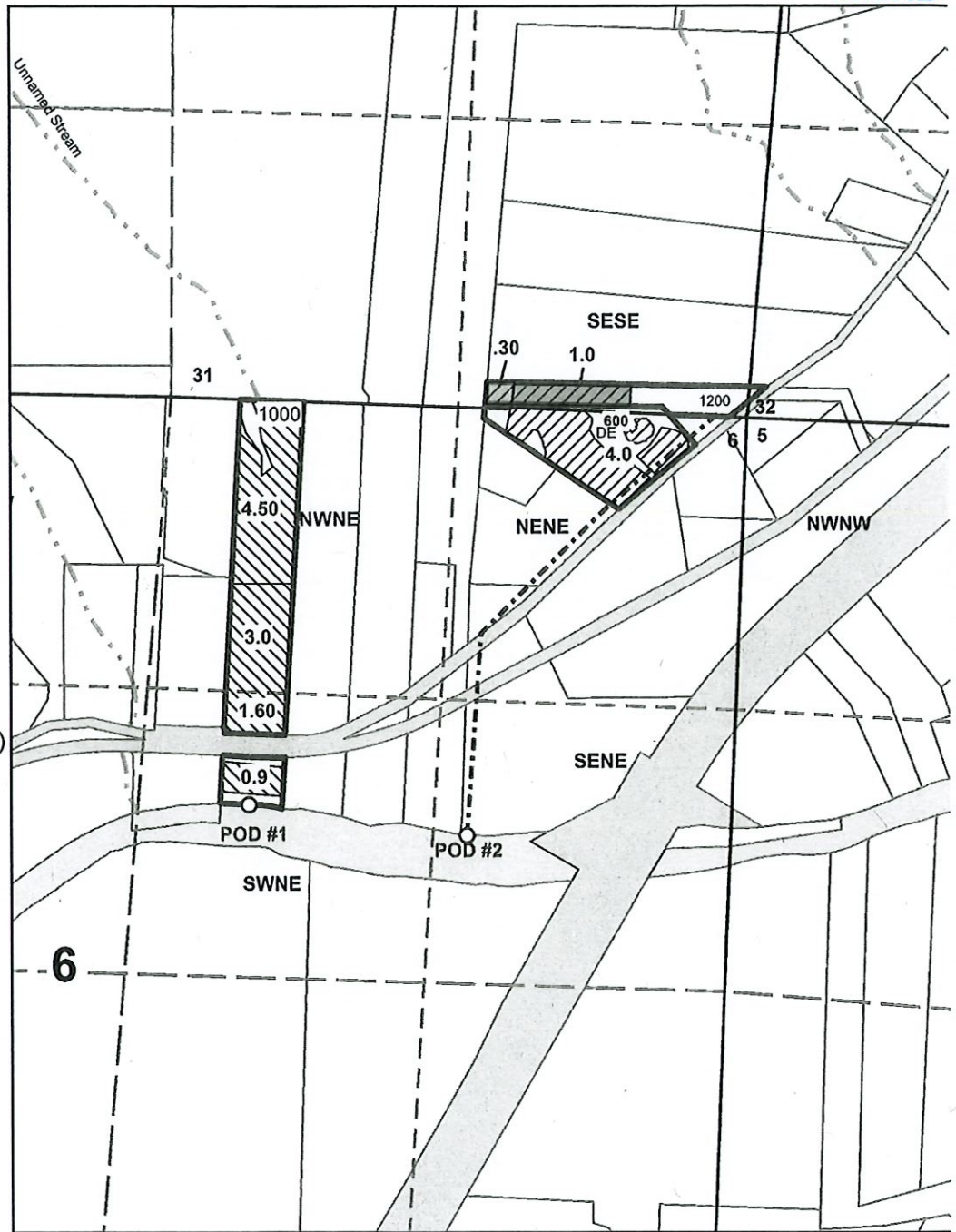

POD #1 is 1840 ft South and 500 ft East from the North 1/4 Corner of Section 6

POD #2 is 1900 ft South and 1150 ft West from the NE Corner of Section 6

The purpose of this map is to identify  
the location of a water right.  
Not intended to show property ownership.



**Surface Water Application  
Ross/Ross/Moore  
T.29 &30S R.5W Section 6 & 31  
Douglas County  
Scale: 1"=800'**

Tax lot 100  
Richard Ross  
10.00 acres Supplemental  
Cert 54152

Tax lot 1200  
Ernest Ross  
1.0 acre Supplemental  
Cert\_85671  
0.3 acre Primary

Tax lot 600  
Forrest Moore  
4.0 acres Supplemental  
Cert\_85671  
Domestic Expanded

**Legend**

-  Domestic Expanded (Moore)
-  1.0 acre Supplemental (E. Ross)
-  4.0 acre Supplemental (Moore)
-  0.3 acre Primary (E. Ross)
-  10.0 acres Supplemental (R. Ross)

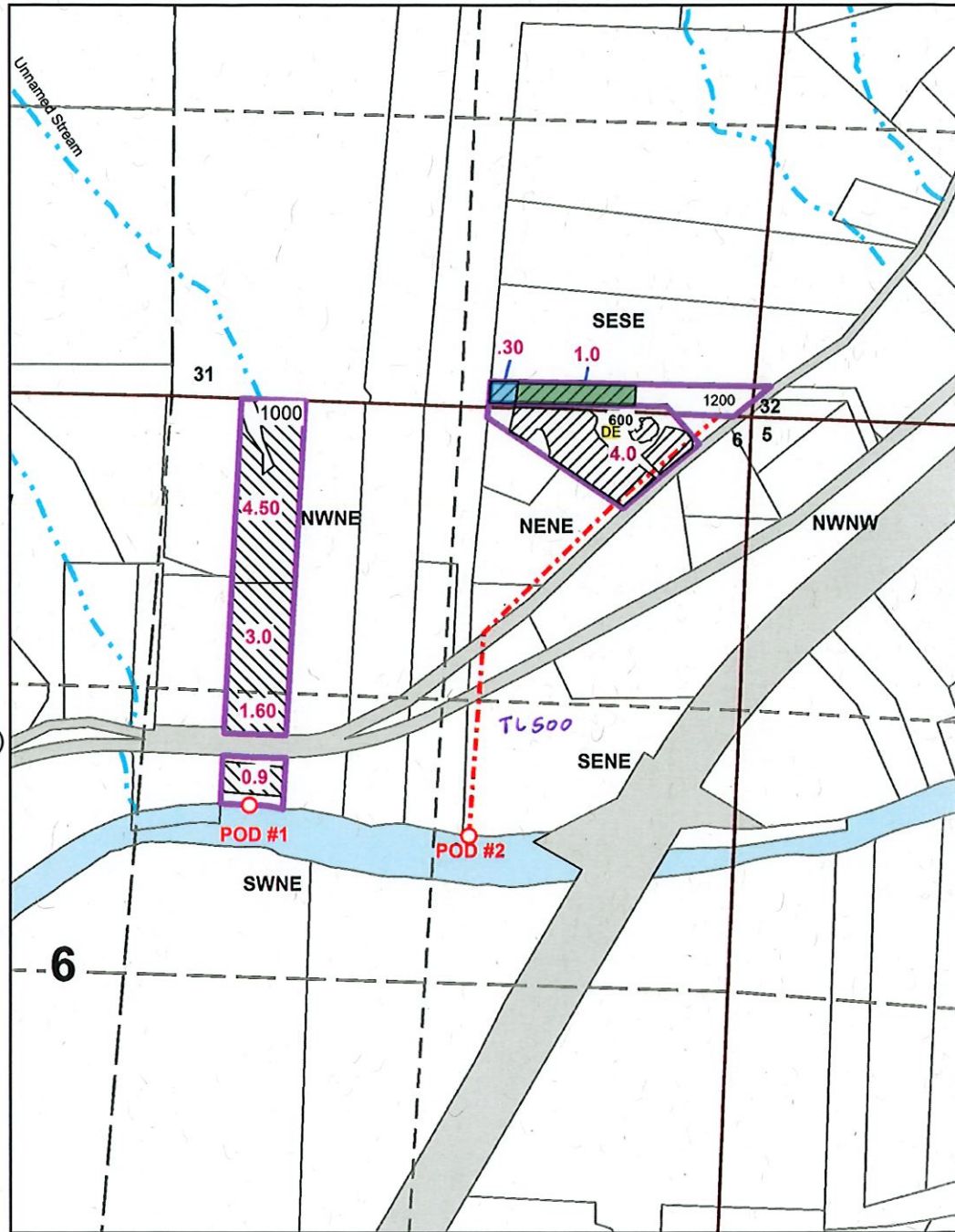

POD #1 is 1840 ft South and 500 ft East from the North 1/4 Corner of Section 6

POD #2 is 1900 ft South and 1150 ft West from the NE Corner of Section 6

**RECEIVED**

**JUL 26 2021**

**OWRD**

The purpose of this map is to identify the location of a water right.  
Not intended to show property ownership.