

LEGEND

- SECTION LINE
- 1/4 1/4 LINE
- TAX LOT LINE
- ROAD
- BY-PASS DITCH
- SECTION CORNER
- TAX LOT NUMBER
- PROPOSED AREA FOR LILY POND (RESERVOIR)
- BUILDINGS

DAM LOCATION

LILY POND (RESERVOIR): NW1/4 SE1/4, SECTION 2, T38S, R8W, W.M.; 1385' NORTH AND 1696' WEST FROM SOUTHEAST CORNER, SECTION 2.

NOTES

1. THE PURPOSE OF THIS MAP IS TO IDENTIFY THE LOCATION OF THE WATER RIGHT ONLY, AND IS NOT INTENDED TO PROVIDE DIMENSIONS OR LOCATION OF PROPERTY LINES.
2. FOR TAX LOT INFORMATION, SEE TAX MAPS INCLUDED WITH THIS APPLICATION.

AL ADKINS ENGINEERING & SURVEYING
 o / 541.884.4666
 w / AdkinsEngineering.com

1435 ESPLANADE AVENUE, KLAMATH FALLS, OR 97601

SERVING S. OREGON & N. CALIFORNIA

ENGINEERING • SURVEYING • PLANNING • TESTING

APPLICATION FOR A PERMIT TO STORE WATER IN A RESERVOIR

FOR
 JUDI SCHARNS
 T38S, R8E, SEC. 2, WM
 JOSEPHINE COUNTY, OREGON

RECEIVED

JUL 11 2019

OWRD

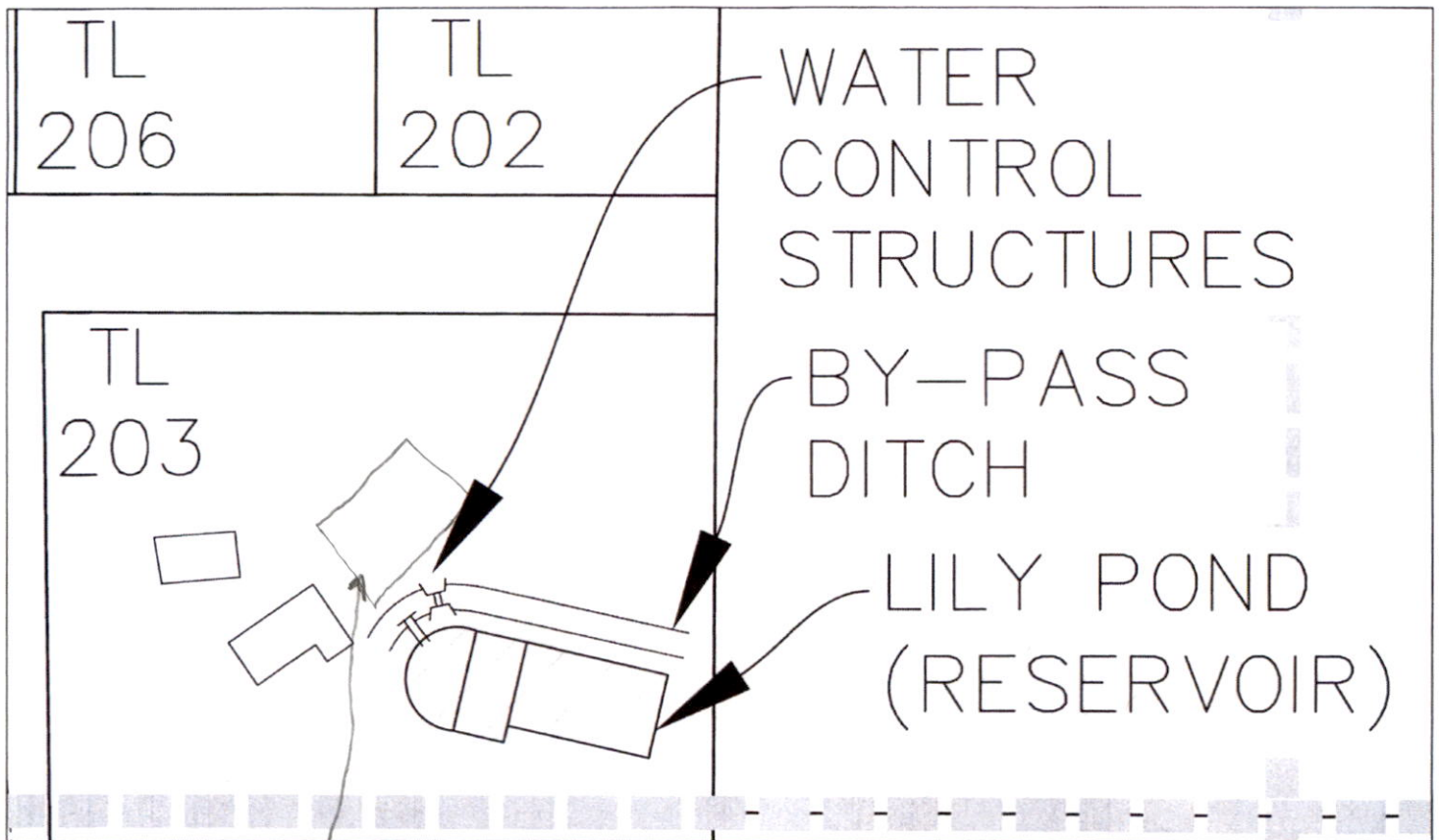
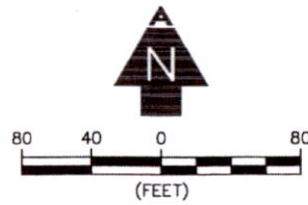

R-88718

AREA OF USE

Assessor's Map 38-08-02-D0 tl 203

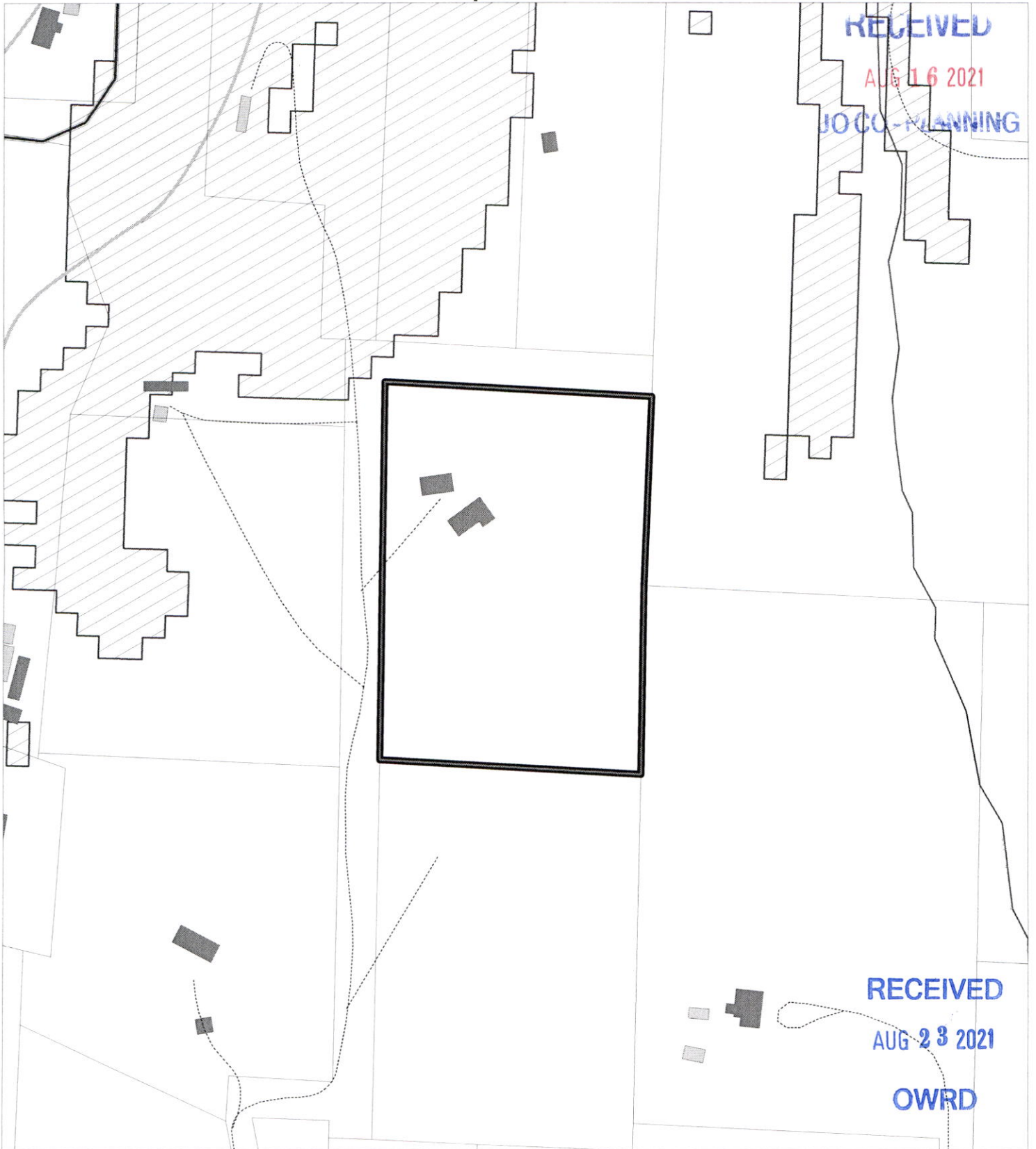

Legend

	Buildings
	PRIMARY
	SECONDARY
	Driveways
FEMA Flood Map	
	Approximate
	Slope > 15 %
	Taxlots
	Water (line)
	Class 1
	Class 2
	Wetlands (Line)



The information on this map is furnished for general interest purposes only. This information is provided without warranties of any kind, express or implied, and it should not be used to support any purchase or other investment. Neither Josephine County, Cave Junction, nor Grants Pass will accept responsibility for any errors or inaccuracies in the depicted information.



Scale
1:2400



Locator Map

