

APPLICATION FOR PERMIT

DOMESTIC USE EXPANDED

RECEIVED

JUN 24 2021

SECTION 11, TOWNSHIP 26 S., RANGE 3 W., W.M.

OWRD

DOUGLAS COUNTY, OREGON

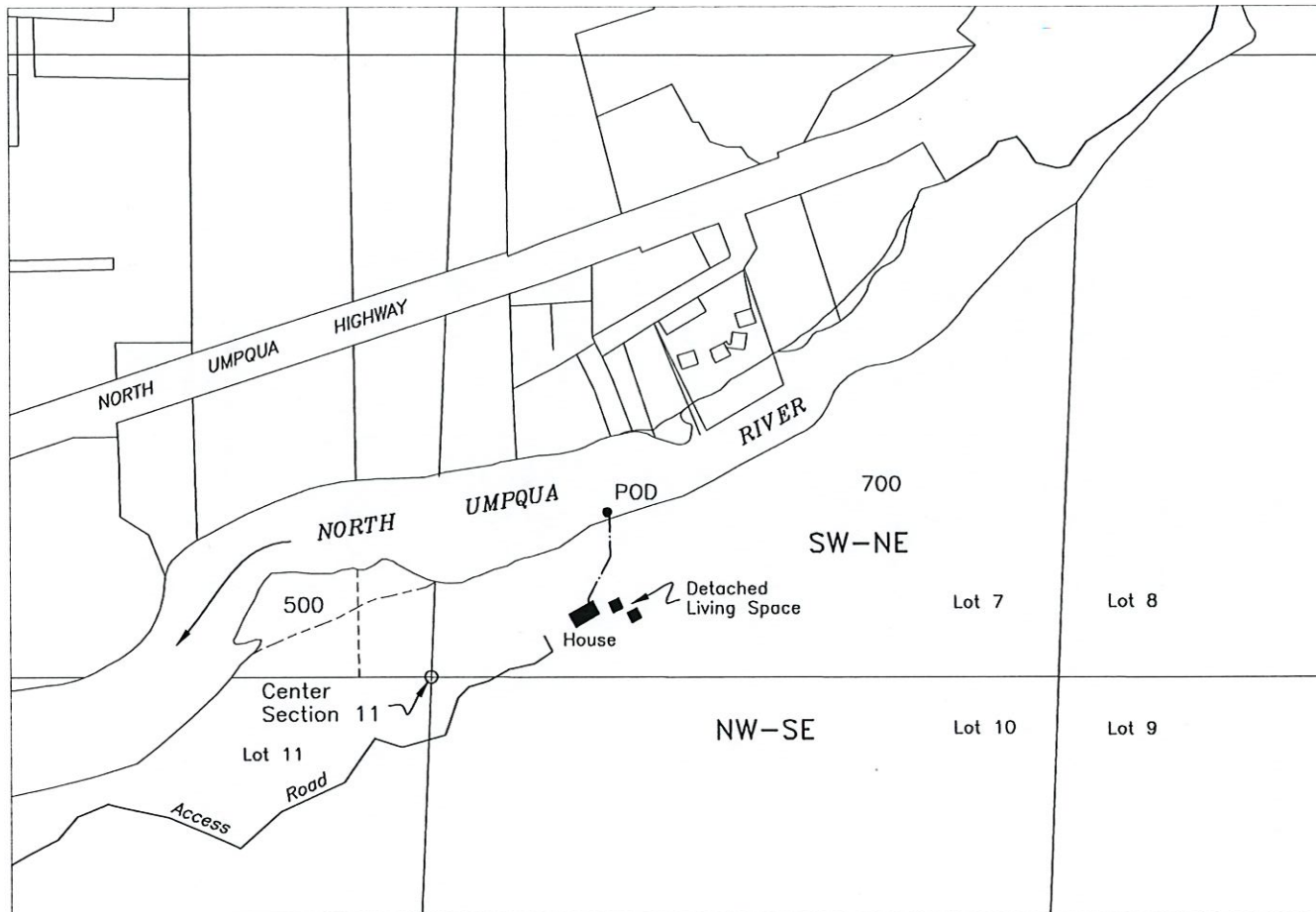

Legend

POD Lot 7, SW/NE Section 11, 340 feet North & 370 feet East from the Center 1/4 Corner Section 11

SOURCE: North Umpqua River

APPLICATION FOR:
TL-700 Domestic Use Expanded

NARALTO, LLC
P.O. BOX 1001
ROSEBURG, OR 97470

Scale
1" = 400'



JORDAN ENGINEERING
460 JORDAN LANE
ROSEBURG, OREGON 97471
(541) 673-1931

Base Map: Douglas County GIS mapping adjusted to and oriented to survey map M-116-51 & M37-1 over 5/10/2019 Google aerial photo & Oregon Map aerial photo for assumed best fit

This map is not intended to provide legal dimensions or locations of property ownership lines

5/14/2021 n.e.d.