

Lot 4, Sec 13. T35S. R17

Pipe line for Hotel + Domestic use

T. 35 S. R. 12 W.

R. 11 W.

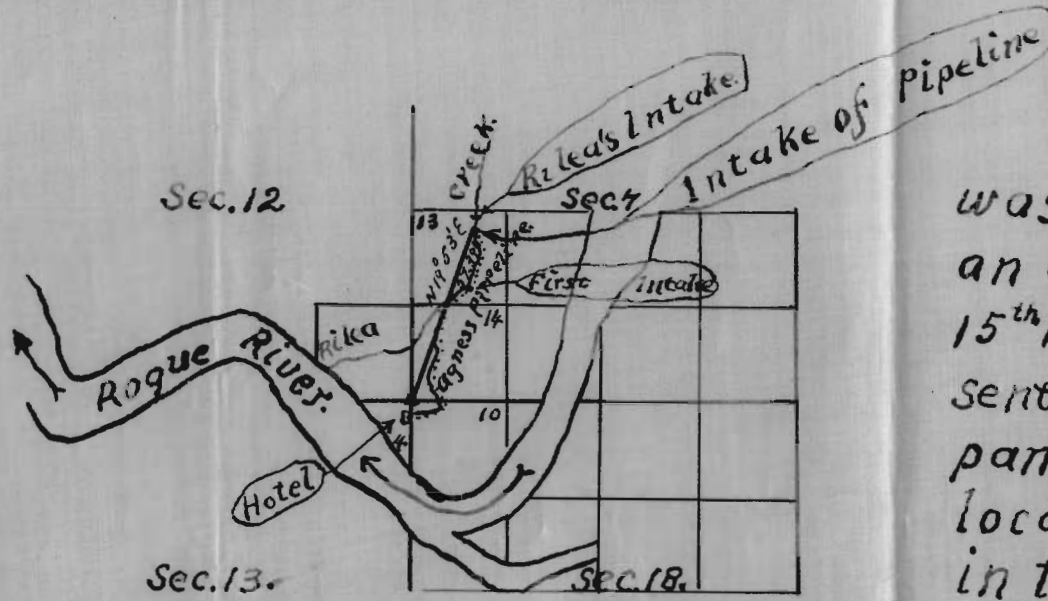

I. R. J. Canfield, of Agness, Ore., do hereby certify that this map was made from notes taken during an actual survey made by me on Sept. 15th 1922, and that it correctly represents the works described in the accompanying application, together with the location of streams and other ditches in the immediate vicinity.

R. J. Canfield,
Surveyor.

STATE ENGINEER
RECEIVED

OCT 11 1922

SALEM, OREGON

Application No. 8619
Permit No. 5664

SALEM, OREGON

8619

STATE ENGINEER
RECEIVED
OCT 11 1922

Ditch for irrigation Lot 4, Sec 13 - T. 35 S. R. 12 W

STATE ENGINEER
RECEIVED

OCT 11 1922

SALEM, OREGON

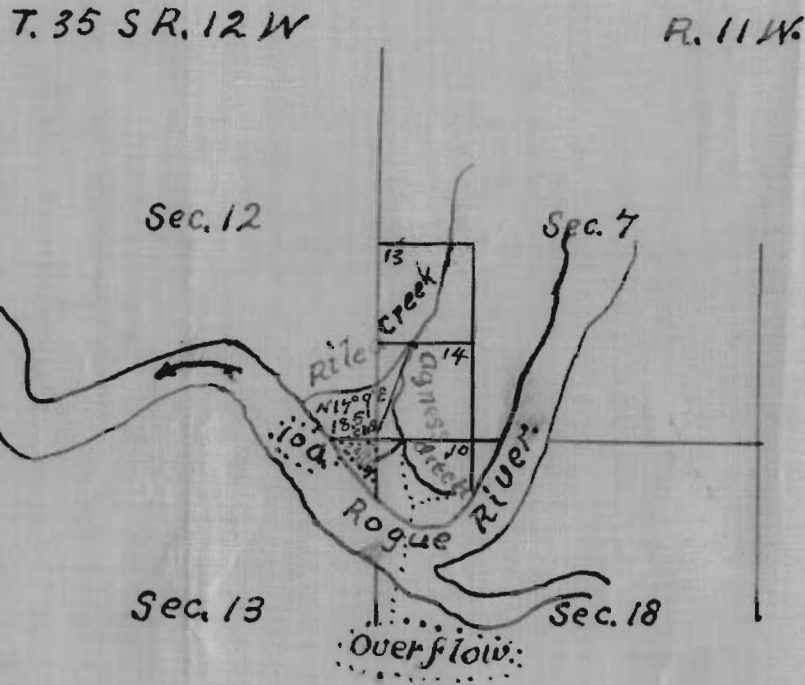

I, R.J. Canfield, of Agness Ore. do hereby certify that this map was made from notes taken during an actual survey made by me on Sept. 5th 1922, and that it correctly represents the works described in the accompanying application together with the location of streams and other ditches in the immediate vicinity.
R.J. Canfield, Surveyor.

STATE ENGINEER
RECEIVED

OCT 11 1922

SALEM, OREGON

Application No 8619
Permit No 5664

8619