

8730

Tp. 21 S. R. 5 W. W. M.

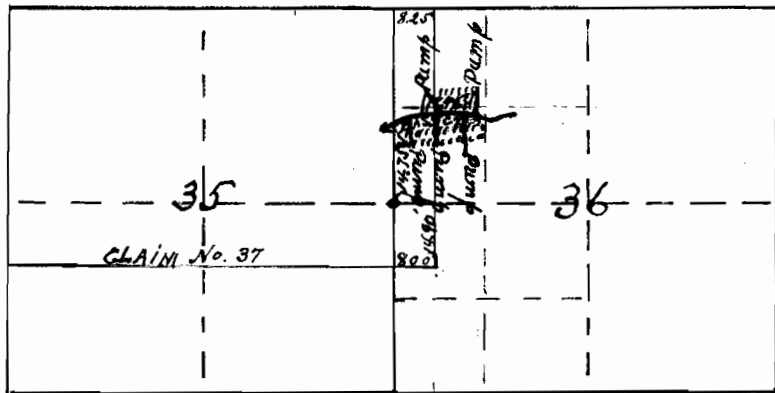

CERTIFICATE OF SURVEYOR.

I, O. F. THIEL, OF DRAIN, OREGON, DO HEREBY CERTIFY THAT THIS MAP WAS MADE FROM NOTES TAKEN DURING AN ACTUAL SURVEY MADE BY ME OF THE PROPERTY OF SAID EM. HENDERER, BY FORMER SURVEYS, AND THAT IT CORRECTLY REPRESENTS THE WORKS DESCRIBED IN THE ACCOMPANYING APPLICATION, TOGETHER WITH THE LOCATION OF STREAM IN THE IMMEDIATE VICINITY.

O. F. Thiel,
SURVEYOR.

SCALE 2 IN. = 1 MI.

STATE ENGINEER
RECEIVED

DEC 26 1927

SALEM, OREGON

Application No. 8730
Permit No. 5749

8730