

MAP
 Accompanying application for permit
 to appropriate Water
 by
 W. J. Rust

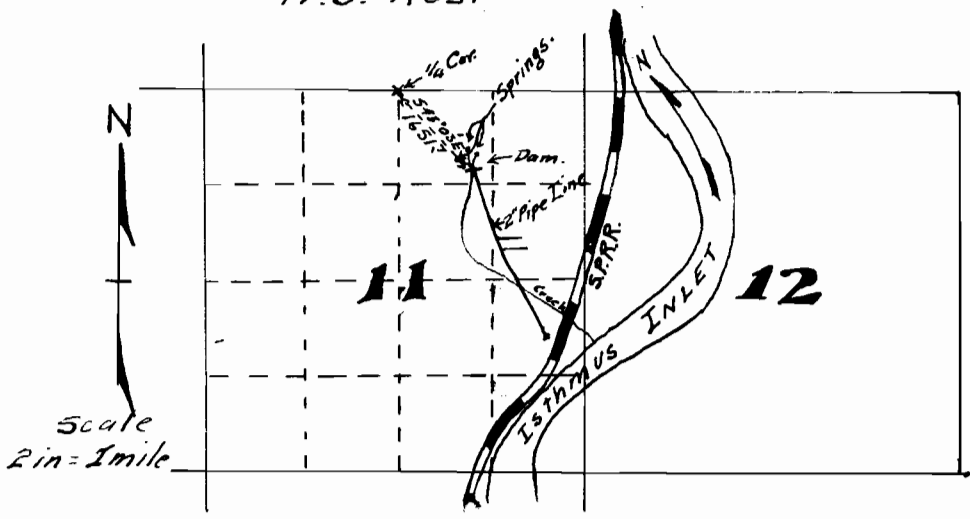

REGISTERED PROFESSIONAL ENGINEER
 LICENSE NO. 112
 D. L. BUCKINGHAM
 PORTLAND, OREGON

I, D. L. Buckingham of Marshfield Oregon do Hereby certify that this map was made from notes taken during an actual survey made by me on April 6-1922 and that it correctly represents the works described in the accompanying application together with the location of streams and pipe lines in the immediate vicinity.

D. L. Buckingham
 Registered Professional Engineer
 OREGON No 112 Dec 8-1919

8790
 5753