

5401

Silver Creek Ditch

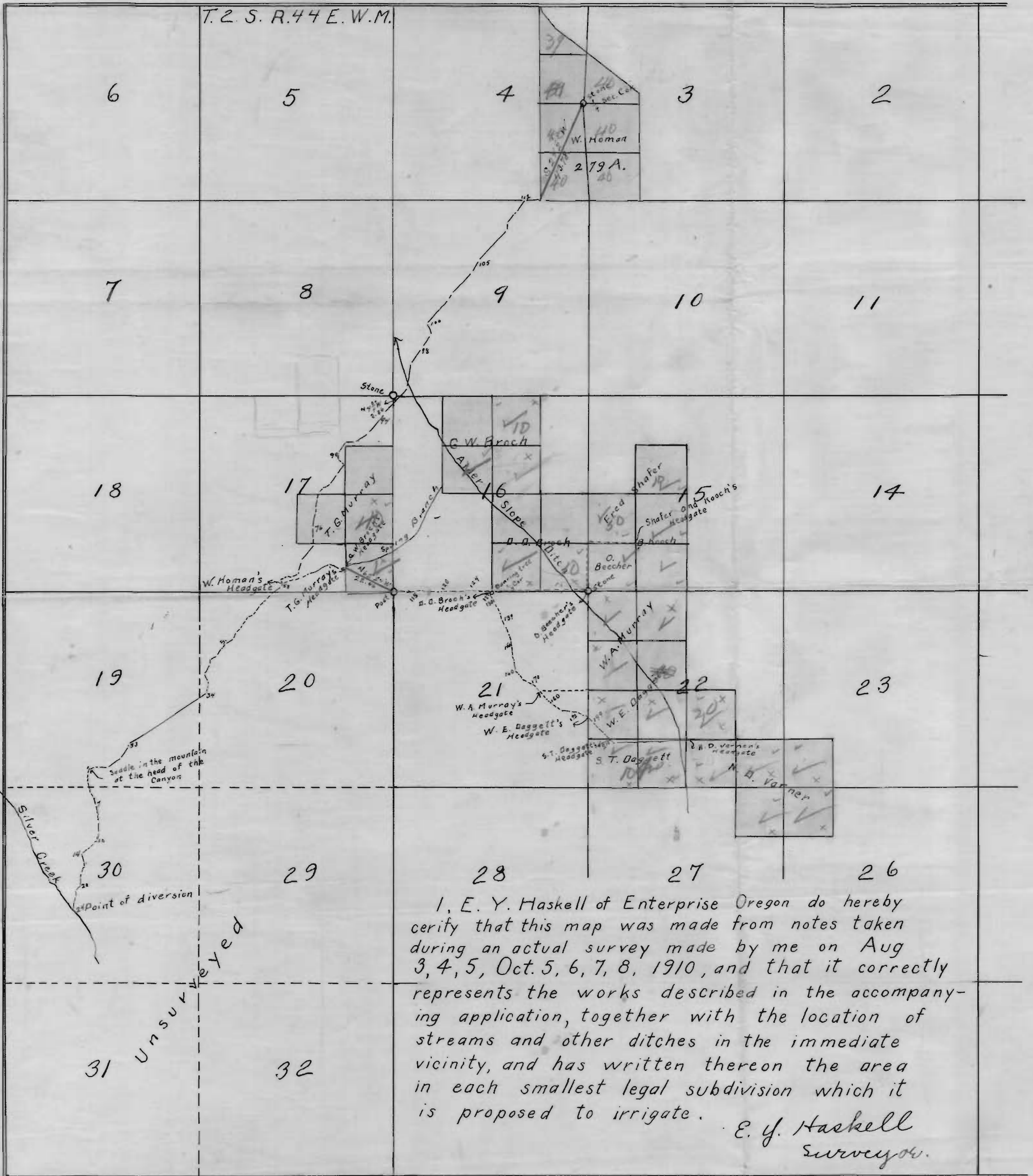

I, E. Y. Haskell of Enterprise Oregon do hereby certify that this map was made from notes taken during an actual survey made by me on Aug 3, 4, 5, Oct. 5, 6, 7, 8, 1910, and that it correctly represents the works described in the accompanying application, together with the location of streams and other ditches in the immediate vicinity, and has written thereon the area in each smallest legal subdivision which it is proposed to irrigate.

E. Y. Haskell
Surveyor.

OCT 22 1910
RECEIVED
Application No 1042
Permit No. 582

TOYS