

Permit: S 5840
Volume: 4A
Strm: FRUITDALE CR
Trib: ROGUE R
Priority: 4/10/23

Hyd. 8911

T. 36 S., R. 5 W.

28

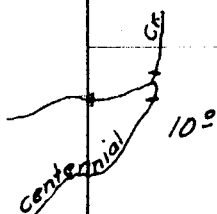

*sketched from app. map
Acreage from proof.*

A.- 8911

Rough Sketch
of
Land to be watered.

STATE ENGINEER
RECEIVED

APR 10 1923

SALEM, OREGON

RECEIVED
STATE ENGINEER

APR 10 1923

RECEIVED
STATE ENGINEER

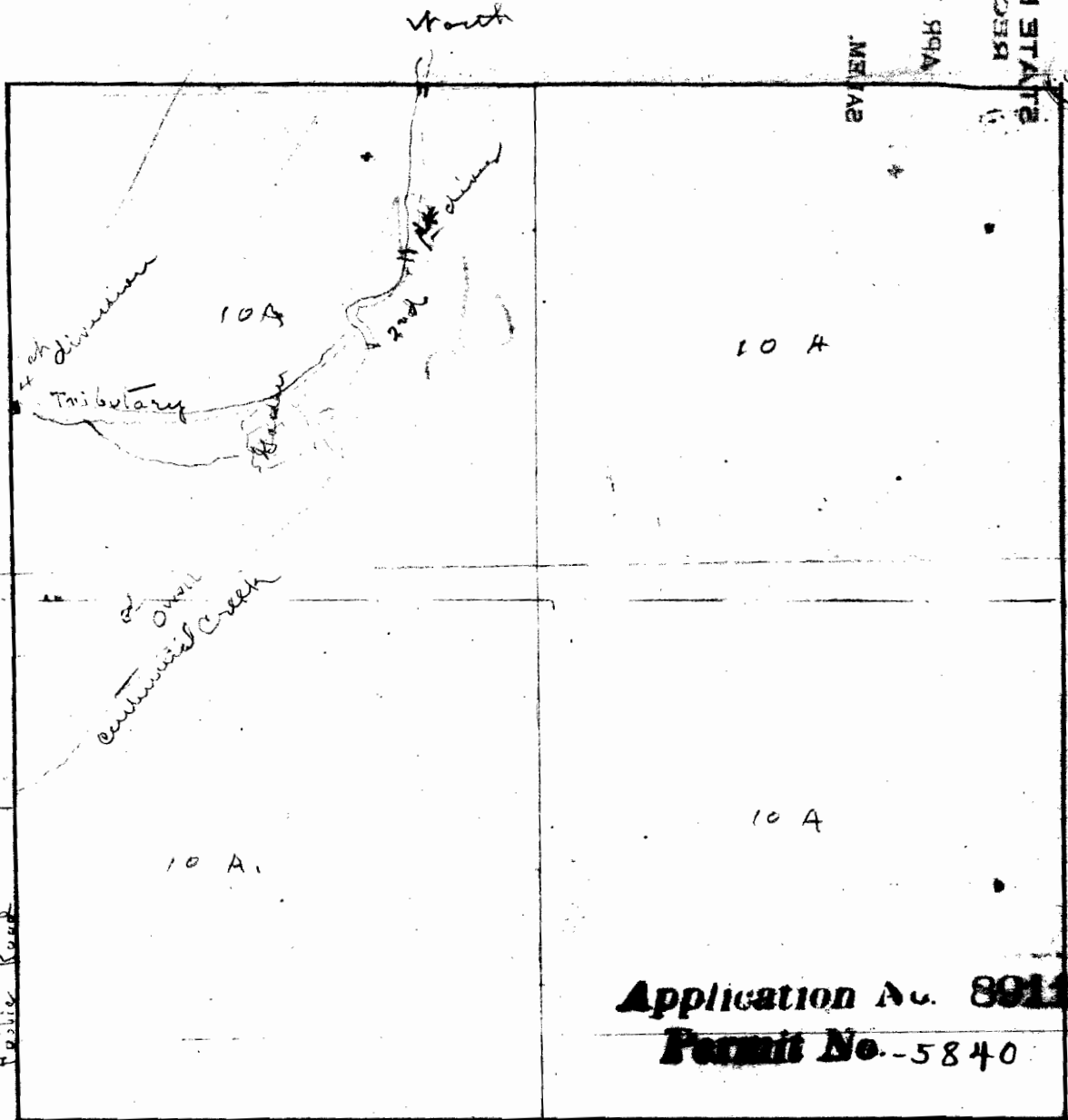

Application No. 8911
Permit No. -5840

SW SW-28-36-5