

— MAP —

Accompanying application of Mrs Eugene Caris and George M. Smith of Rogue River, Jackson County, Oregon. for permit to the Flood and surplus waters of Pleasant Creek, Jackson County, Oregon. for the purpose of irrigation.

— July 1923. —

TP 35.5R.4.W.W.M.

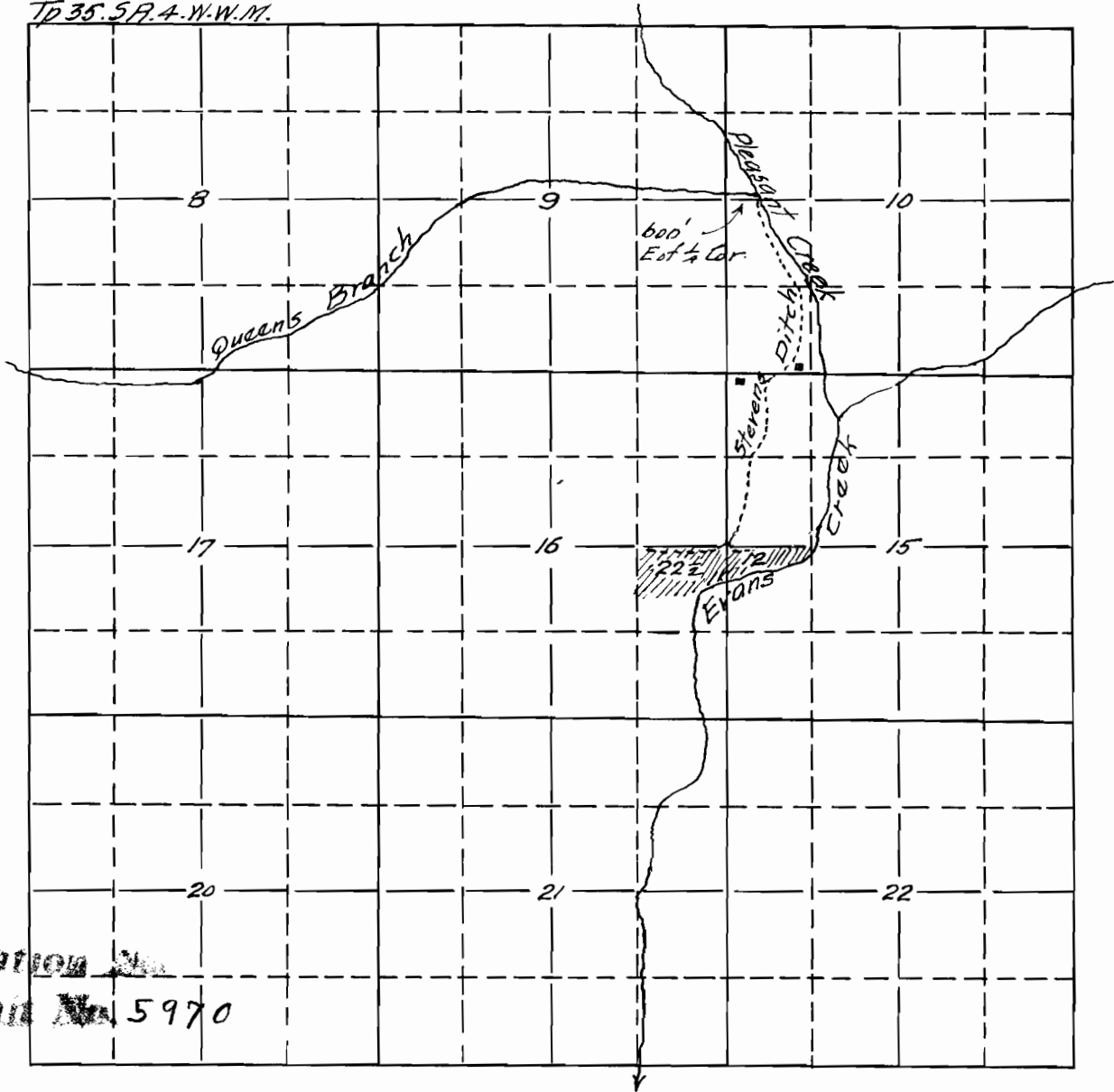

Application No. 5970

Map made from copy of survey of the Stevens ditch correctly showing location of Ditch, Lands to be irrigated together with streams and ditches in immediate vicinity. compiled by.

Fred. N. Cummings. C.E.