

I, R.W. Jones, of M<sup>c</sup>Minville do hereby certify that this map was made from notes taken during an actual survey made by me Aug. 17, 1923, and that it correctly represents the works described in the accompanying application, together with the location of streams and other ditches in the immediate vicinity.

*R. W. Jones*  
 Registered Professional Engineer  
 Oregon No. 793 Date Mar. 8, 1920

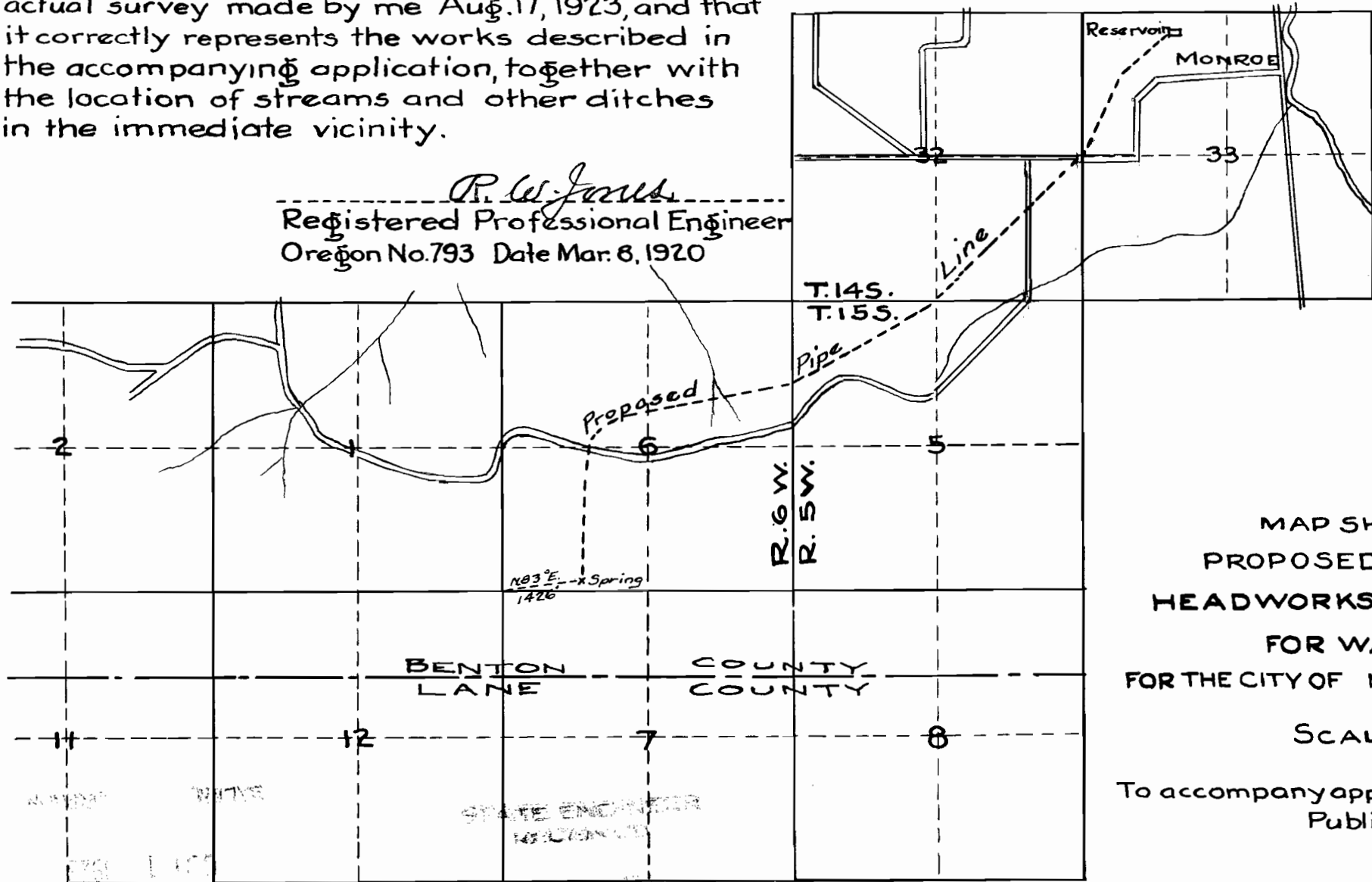

MAP SHOWING  
 PROPOSED LOCATION OF  
 HEADWORKS AND PIPE LINES  
 FOR WATER SUPPLY  
 FOR THE CITY OF MONROE OREGON

SCALE : 2 IN. = 1 MI.

To accompany application to appropriate  
 Public Water

Application No 9202  
 Permit No 6081

STATE ENGINEER  
 RICHMOND

STATE ENGINEER  
 RICHMOND

STATE ENGINEER  
 RICHMOND