

MAP

Accompanying application of J.W., L.E., JOHN, MARK, and L.A. Neathamer, J.E. Smithpeter, A.E. and E.M. Richman of Rogue River, Jackson County, Oregon. for permit to the flood and surplus waters of Evans Creek, Jackson County, Oregon. for the purpose of irrigation.

November 27th 1923.

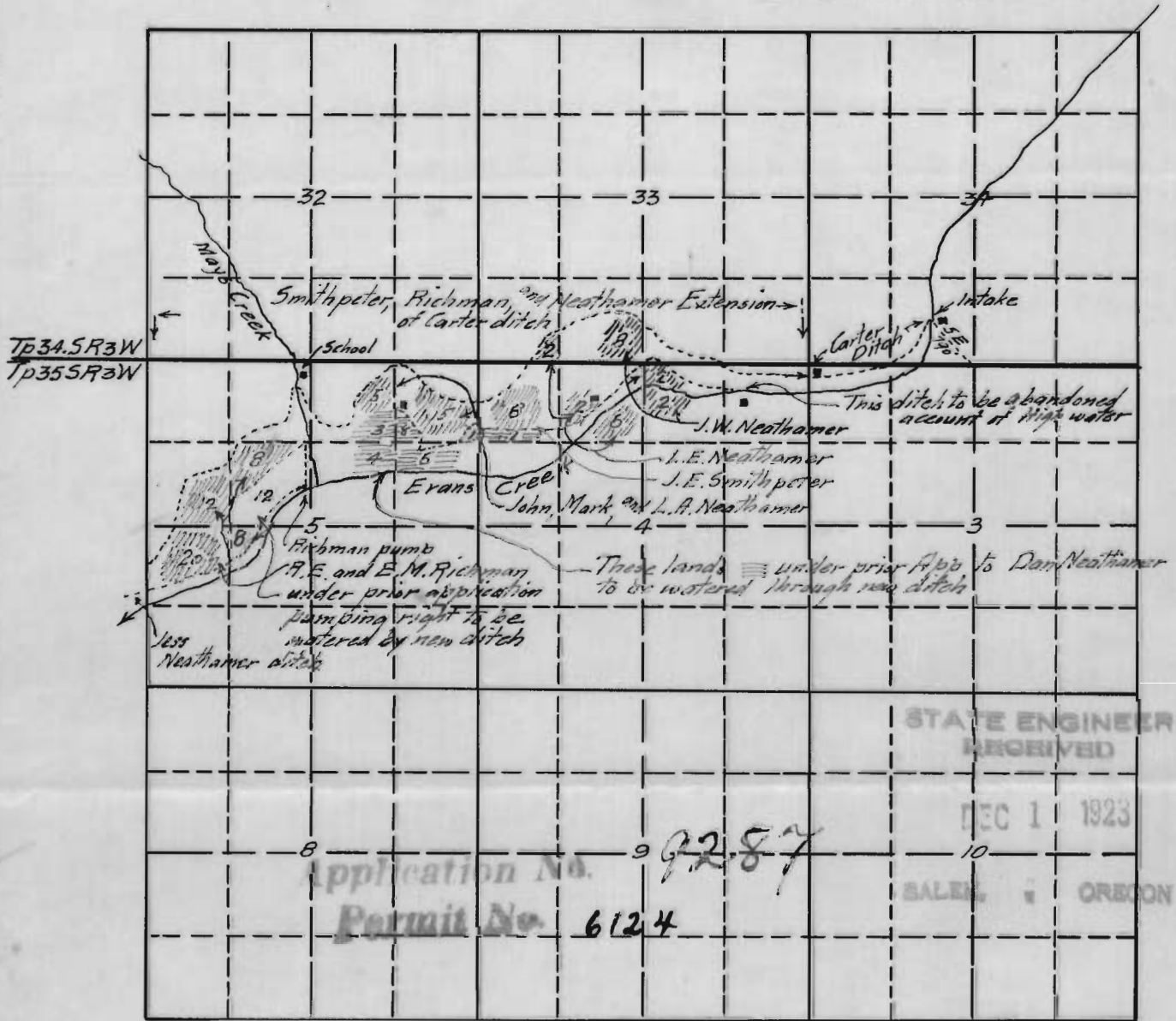

23 Lands under Permit 3987 } Certificate 3243 to D.E. Neathamer
20 Lands under Permit 3312 } Certificate 3571 to E.M. Richman
 Permission applied for to convey water to these lands by means of new ditch under this application.

Map made from notes and measurements taken in the field by Mark Neathamer the same correctly showing the lands to be irrigated, together with streams and ditches in immediate vicinity. Compiled by:
Fred. N. Cummings. C.E.

T.34S. R.3.W.W.M.

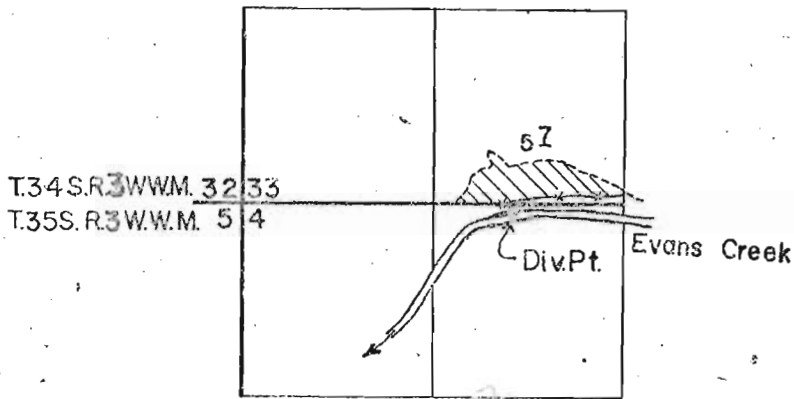

Div. pt. is 30' S & 1875' E from
the SW. cor. of sec. 33

FINAL PROOF SURVEY
UNDER

Trans. No. 2527
Application No. Permit No.

IN NAME OF

Elwyn L. & Betty M. Rowe

Surveyed Oct. 1, 1972, by L. Crow

CERT. NO. 44076
PRIORITY 12-1-23.

102

T.35S. R.3W. W.M.

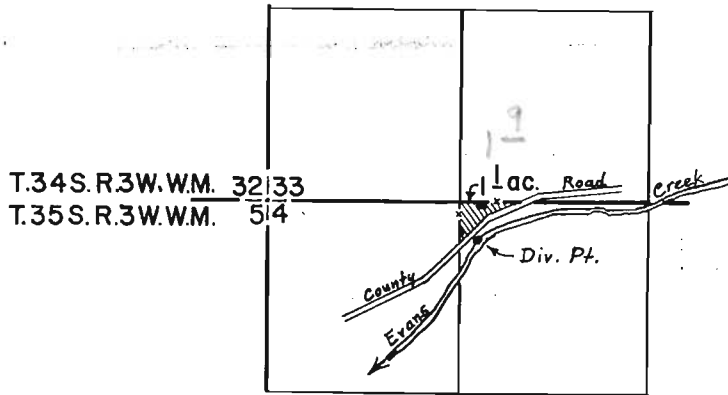

Div. Pt. is located 270' S. & 1460' E.
from N.W. Cor. of Sec. 4

FINAL PROOF SURVEY UNDER

Trans. No. 2528
Application No. _____ Permit No. 6124
IN NAME OF

Don A. Fowler

Surveyed Oct. 1, 1972, by L. Crow & D.C.H.

50907
Certificate No. 44128
Priority
12-1-23