

APR 5 1924

SALEM, OREGON

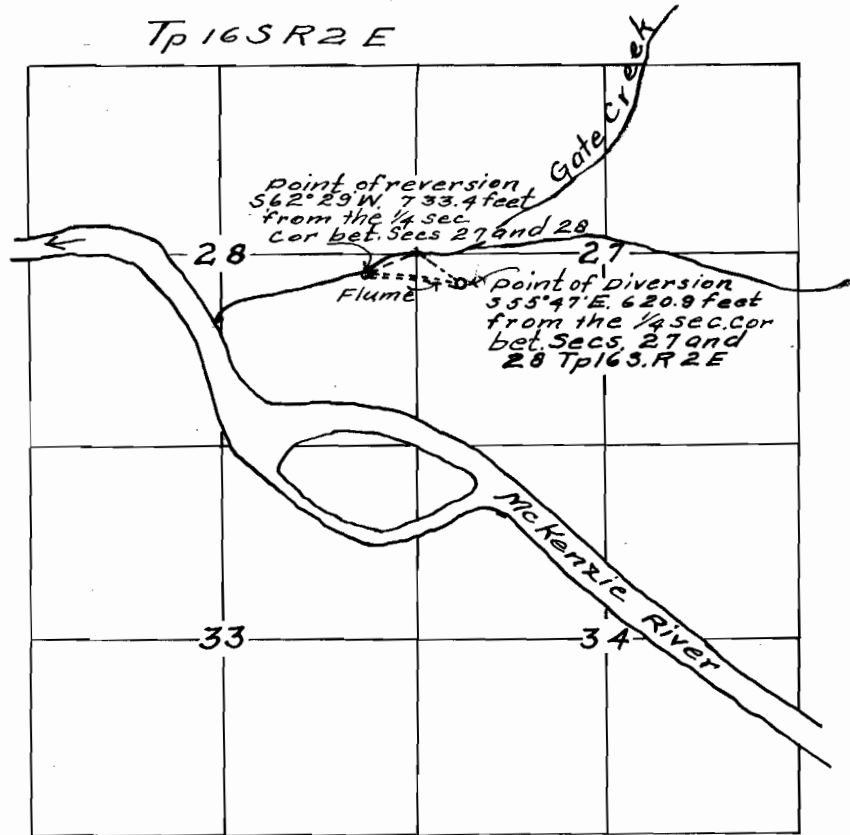

(Datum plane assumed)  
water surface  
Ele. 90

PROFILE OF FLUME

slope 2/10%

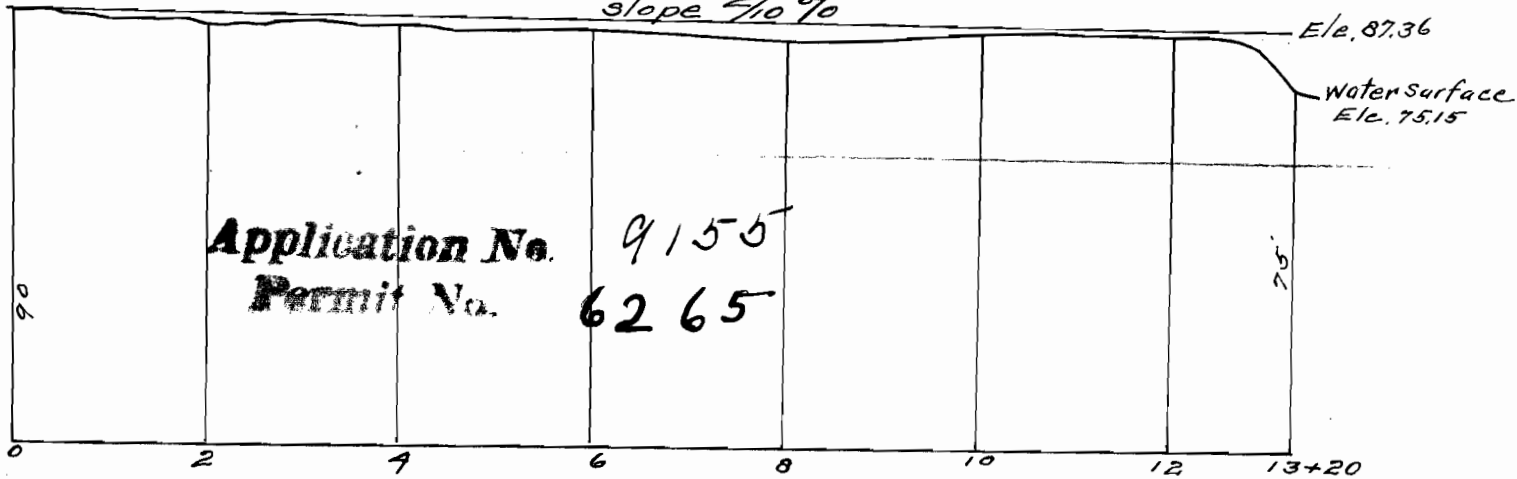

Application No. 9155  
Permit No. 6265

Scale, Hor. 200 feet to the inch  
" Vert. 40 " " " "

I, G.H. Waggoner of Eugene, Ore., do hereby certify that this map was made from notes taken during an actual survey made by me on the 26th day of March 1924 and that it correctly represents the works described in the accompanying application, together with the location of streams and other ditches in the immediate vicinity

G.H. Waggoner

Engineering Certificate No 954, Dated Dec. 31st, 1919