

Township 29,

Range 5 W.

084P

App. 9480
Per. 6277

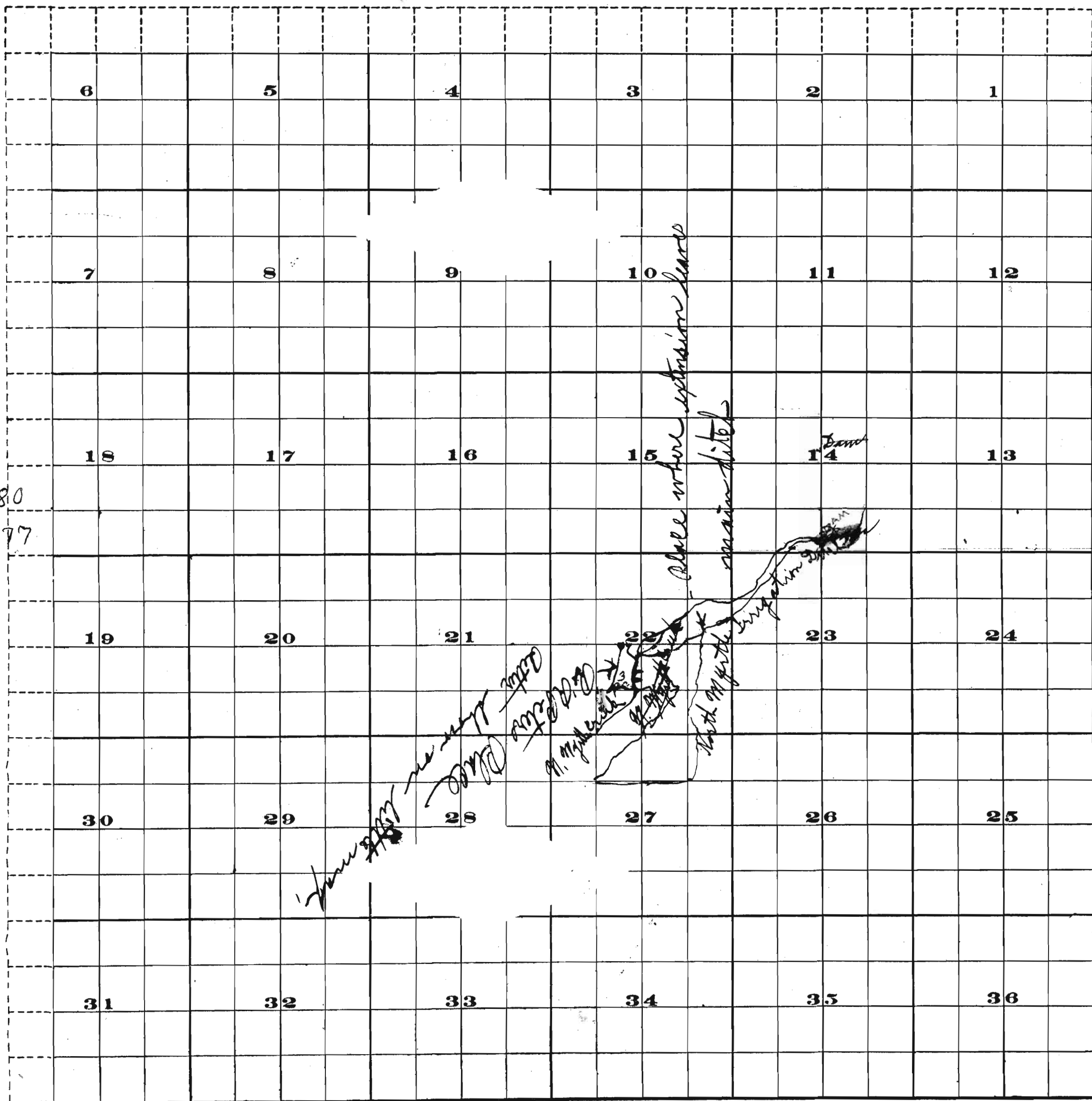

FROM OFFICE OF THE STATE ENGINEER, MALEM, OREGON

Scale of Feet.

084P 2480

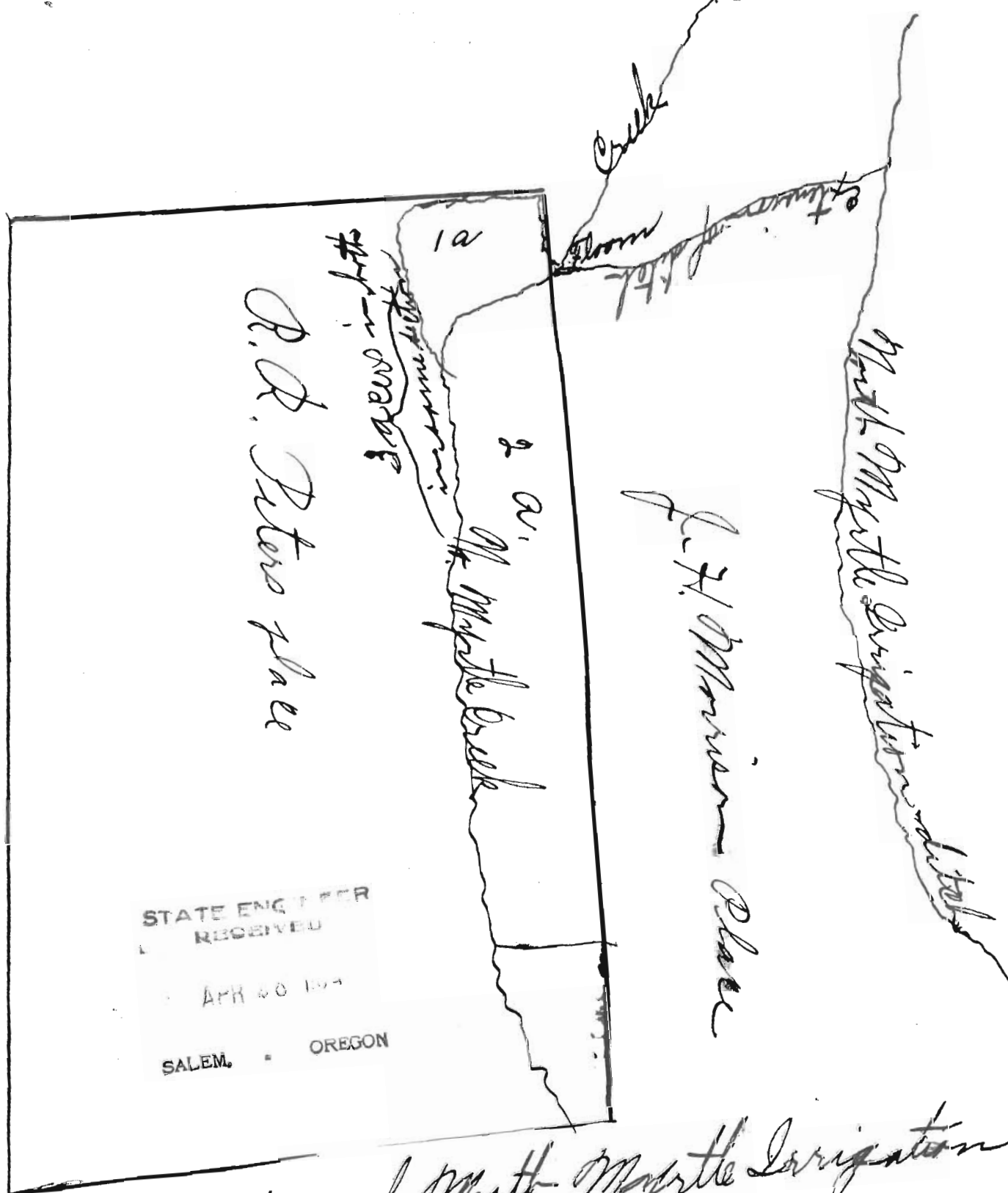

STATE ENGINEER
 RECEIVED
 APR 30 1944
 SALEM, OREGON

Extension of North Myrtle Irrigation
 Ditch on Permit No. 4803
 Application No. 9480
 Permit No. 6277