

Map

Accompanying application of JACKSON COUNTY, OREGON.  
for Permit to the waters of Green Springs tributary to  
Emigrant Creek, tributary to Rogue River, Jackson County  
Oregon, for Domestic and Stock purposes, for Public travel  
on the Ashland-Klamath Falls Highway.

June 1924.

Tp 39. S. R. 2. E. W. M.

25  
36

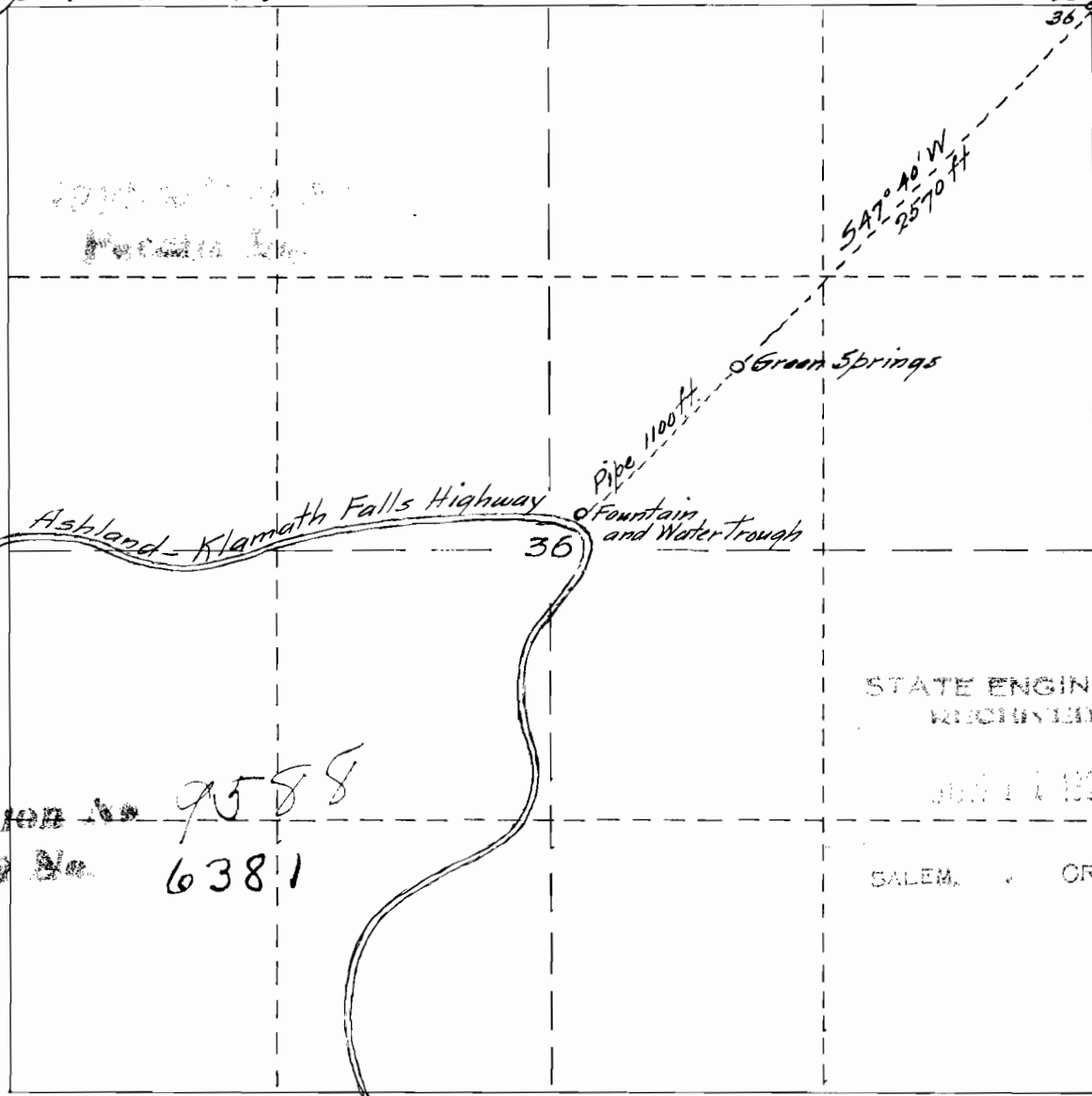

Application No. 9588  
Permit No. 6381

STATE ENGINEER  
RECEIVED  
JUN 11 1924  
SALEM, OREGON

Map made from notes of actual survey made in the field  
by Paul Rynning C.E. correctly showing location of Springs  
place of use, together with streams and ditches in  
immediate vicinity. compiled by.

Fred. N. Cummings. C.E.