

— Map —

Accompanying application of JACKSON COUNTY, Oregon
for Permit to the waters of Spring tributary to Emigrant
Creek, tributary to Rogue River, Jackson County, Oregon.
for Domestic use of Highway permanent Maintenance
Quarters, and Public fountain on Highway.

— June 1924. —

Tp 40 S. R. 2 E. W. 1 M.

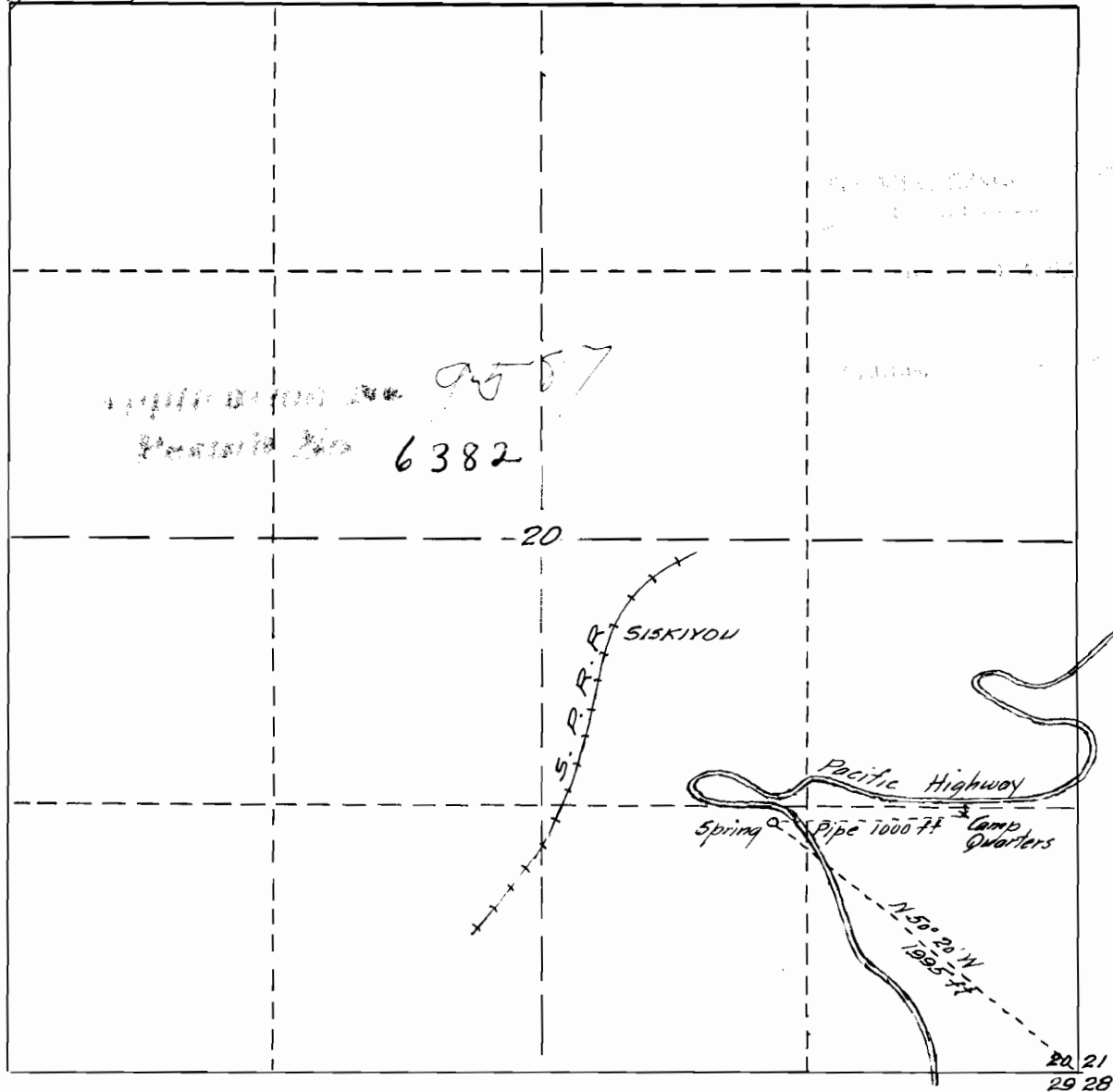

Map made from notes taken in the field from actual
survey by Paul Rynning C.E. correctly showing location
of Spring, place of use, etc. Streams and Ditches in
the immediate vicinity, compiled by

— Fred. N. Cummings, C.E. —