

OFFICE OF STATE ENGINEER  
RECEIVED  
APR 11 1911  
PORTLAND, OREGON.

APPLICATION  
OF  
STANDARD SAND & GRAVEL CO.  
FOR  
WATERS OF JOHNSON CREEK  
CLACKAMAS CO.  
Scale 2" = 1 Mile April 1911

Application No. 1344  
Permit No. 640

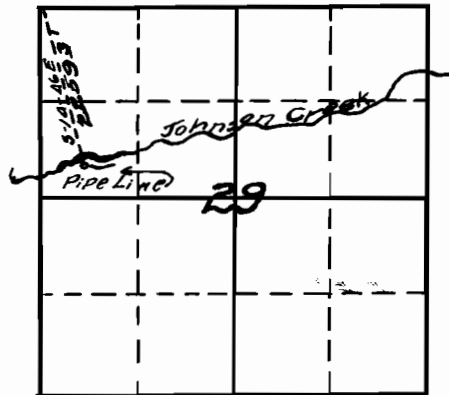

Sec 29 T. 1. S. R. 2 E.



I, C. H. Gossett, of Portland, Or. do hereby certify that this map was made from notes taken during an actual survey made under my immediate supervision in April, 1911, and that it correctly represents the works described in the accompanying application, together with the location of streams and other ditches in the immediate vicinity.

C. H. Gossett  
Surveyor.