

STATE ENGINEER
RECEIVED

JUN 6 1924

SALEM, OREGON

FRED PLAEP, ADA, OREGON

APPLICATION No. _____

North

1p. 19. S. R. 11 W. Willamette Meridian

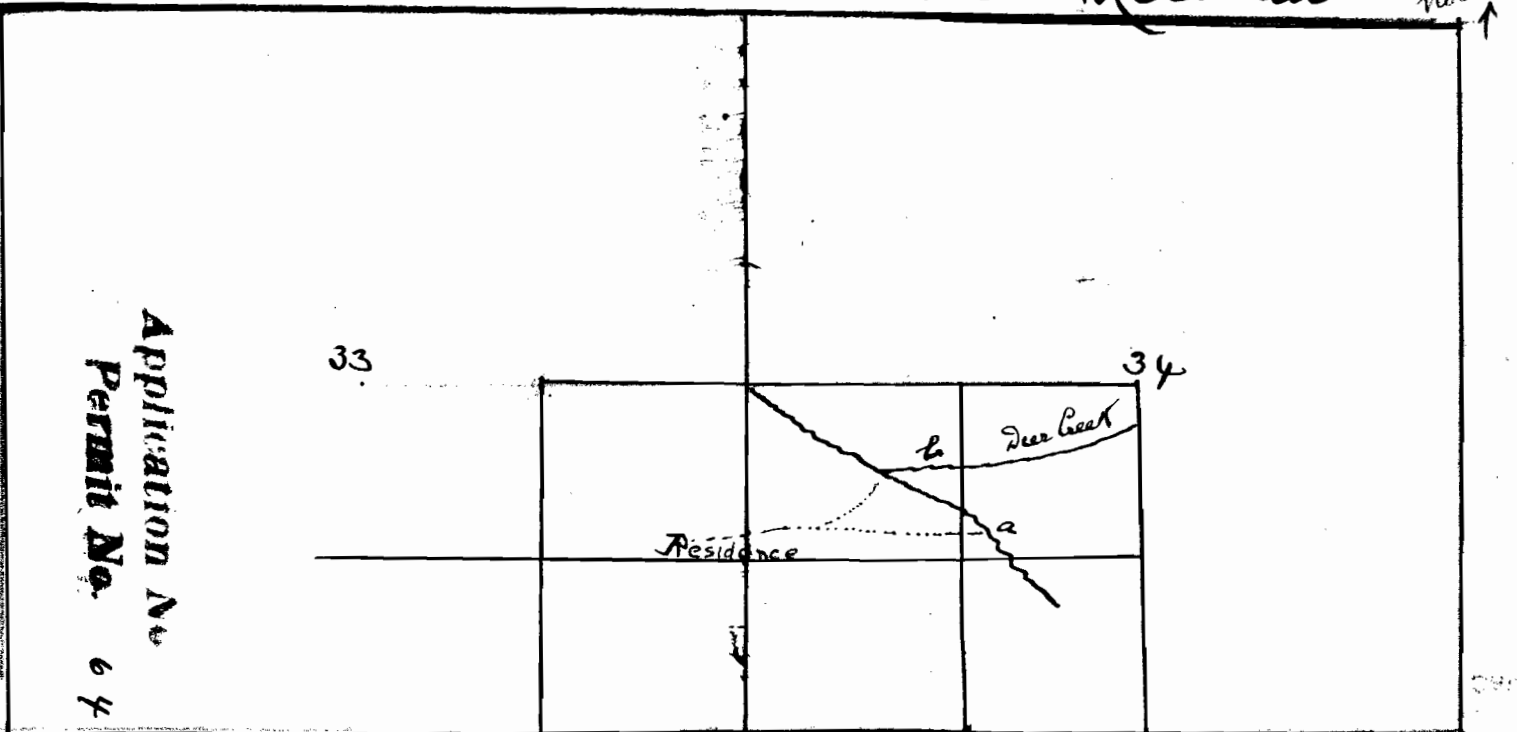

Application No. **9565**
Permit No. 6423

Re Application of FRED PLAEP, of ADA, Lane County,
Oregon.

Points of diversion on what is now named DEER CREEK a tributary of Point "a", or diversion point No. 1, is within NE $\frac{1}{4}$ of SW $\frac{1}{4}$ of Sec. 34, being about 368 ft. above intersection of the South fork with Deer Creek. Point "b", or point diversion No. 2, is within NW $\frac{1}{4}$ of SW $\frac{1}{4}$ of said Sec. 34, about 4ft. below forks of point of intersection of said South fork with Deer Creek. Dotted lines represent proposed pipe lines. "R" stands for Residence.