

Application No. 9689
Permit No. 6459

T. 28S. R. 14W. W.M.

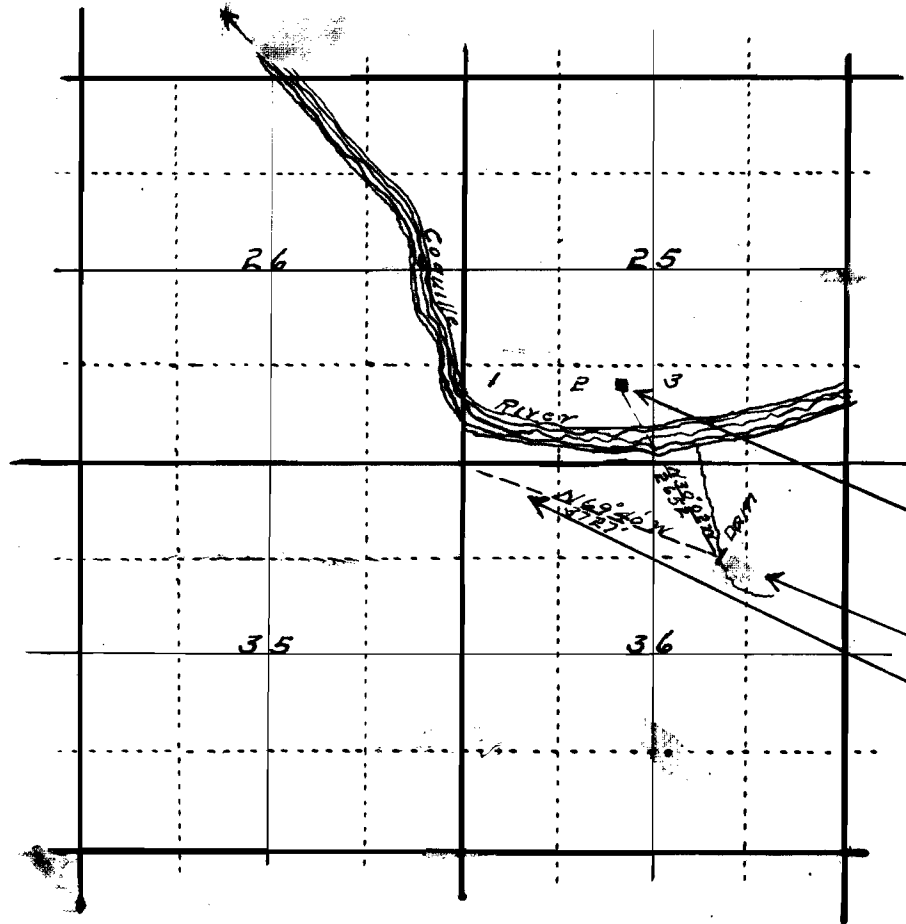
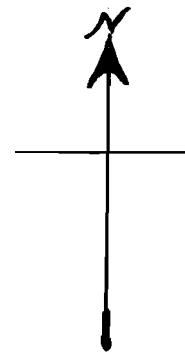

CERTIFICATE of ENGINEER

I, A.E. Hadsall of Coos County Oregon do hereby certify

that this map was made from notes taken during an actual survey made by me on July 1 - 1924 and that it correctly represents the works described in the accompanying application, together with the location of streams and other ditches in the immediate vicinity

A.E. Hadsall

Registered Professional Engineer

Oregon No. 630

Dec. 8 - 1919

Distribution

Point of diversion

Cor. Secs. 25, 26, 35 & 36

STATE ENGINEER
REGISTERED

JUL 17 1924

SALEM, OREGON