

TP 20 S R 1 E

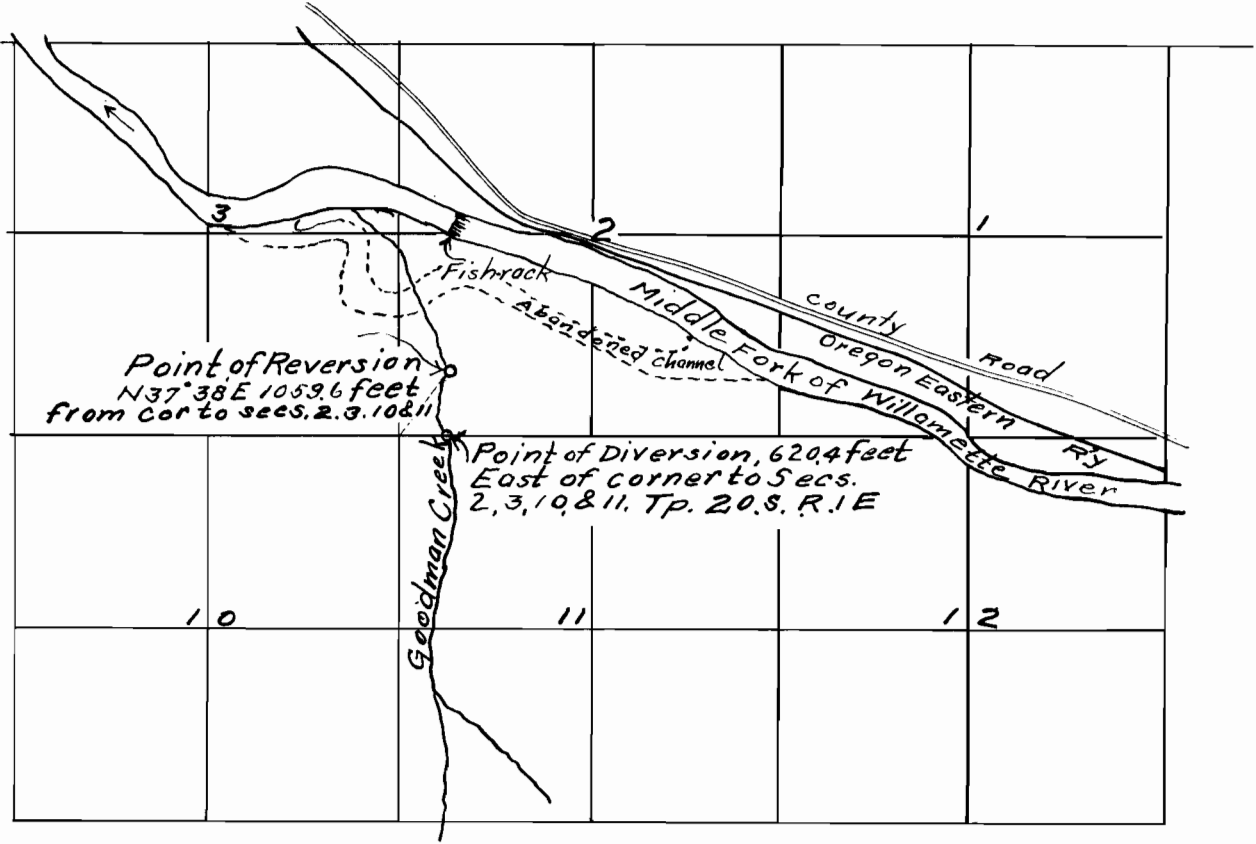

Point of Reversion  
 N37°38'E 1059.6 feet  
 from cor to secs. 2, 3, 10 & 11

Point of Diversion, 620.4 feet  
 East of corner to Secs.  
 2, 3, 10 & 11, Tp. 20 S. R. 1 E

I, G. H. Waggoner, of Eugene, Oregon, hereby certify that this map was made by me from notes taken during an actual survey made by me on the 7th day of June, 1924 and that it correctly represents the works described in the accompanying application together with the location of streams and other ditches in the immediate vicinity

G. H. Waggoner  
 Registered Professional Engineer  
 Oregon, No. 954  
 Date of Registration Dec. 31st, 1919

Registration No. 954  
 Permit No. 6468