

— MAP —

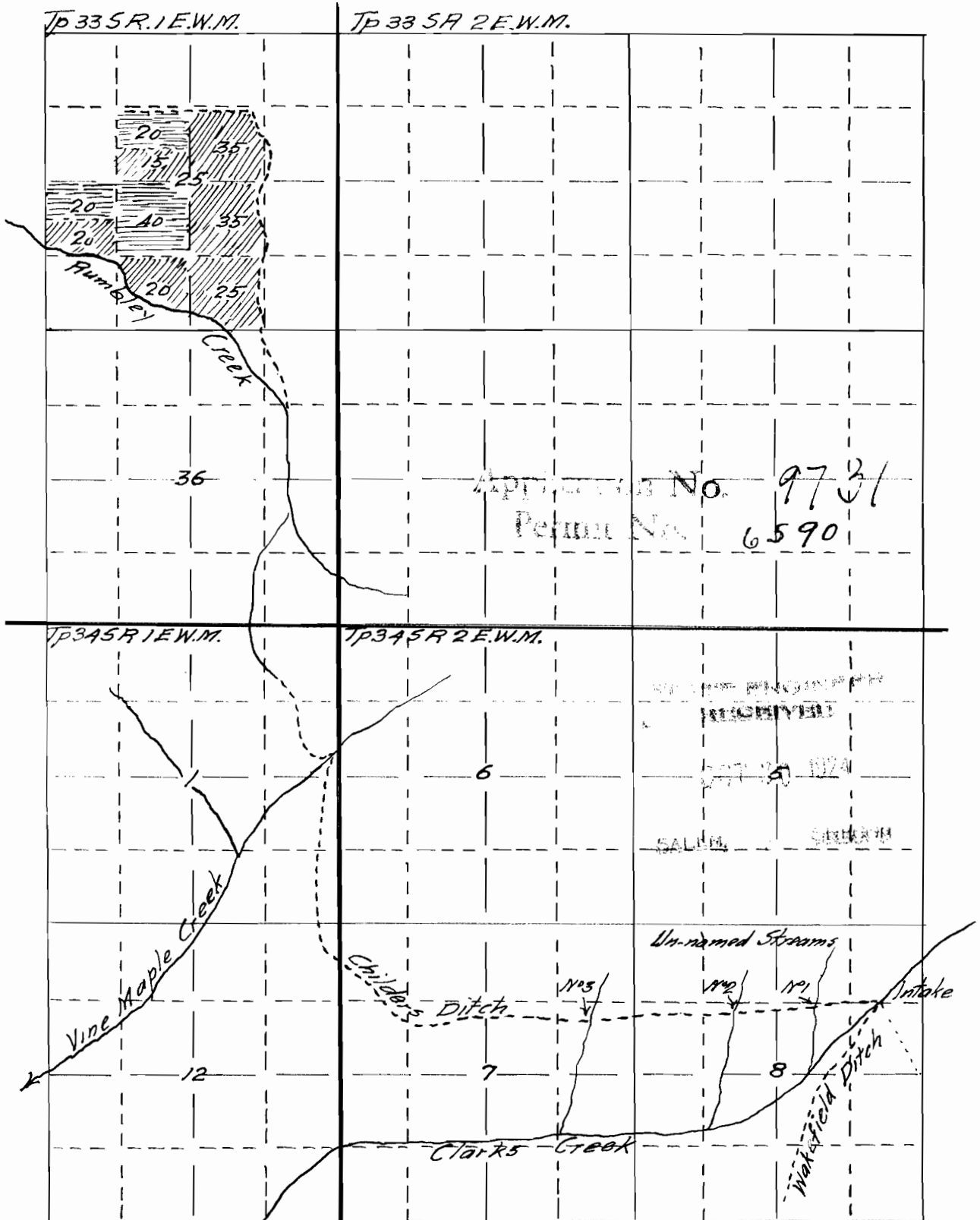

Accompanying application of E. L. CHILDERS of Trail Jackson County, Oregon. for permit to the waters of (3) Three unnamed streams tributary to Clarks Creek, Jackson Co Oregon, as Supplementary supply to Permit N^o 5971 for Irrigation of Lands as shown on this plat

— Oct 1924. —



Application No. 9731
Permit No. 6590

COPIES RECEIVED
OCT 25 1924
SALIDA, OREGON

 Decreed Rights } Supplemental from 3 Streams this application.
 Permit N° 5971

Map made from notes of survey made by Mr Childers showing Location of unnamed streams, ditch, Lands to be irrigated, streams and ditches in immediate vicinity, compiled by.

Fred. N. Cummings. C.E.