

Scale 2" = 1 Mile

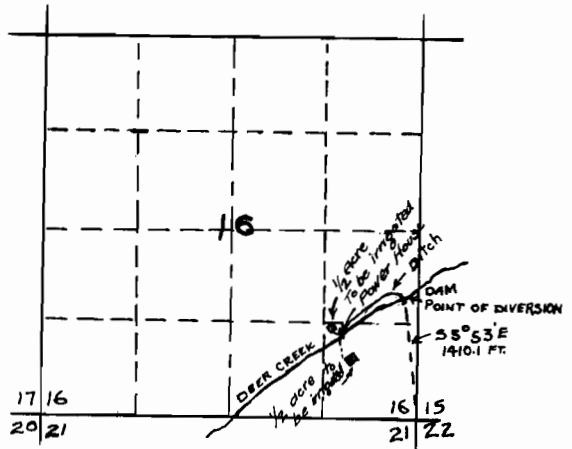

MAP OF  
**F.R. PRICE POWER SITE**  
 SEC. 16 T 27 S R 5 W. W.M.  
 DOUGLAS COUNTY OREGON  
 OFFICE OF  
**H.L. EPPSTEIN COUNTY SURVEYOR**

**CERTIFICATE OF SURVEYOR**

I, H.L. EPPSTEIN, OF ROSEBURG, OREGON, DO HEREBY CERTIFY THAT THIS MAP WAS MADE FROM NOTES TAKEN DURING AN ACTUAL SURVEY MADE BY ME, ON APRIL 30 - 1925 AND THAT IT CORRECTLY REPRESENTS THE WORKS DESCRIBED IN THE ACCOMPANYING APPLICATION TOGETHER WITH THE LOCATION OF STREAMS IN THE IMMEDIATE VICINITY.

OREGON NO. 1011  
 DATE OF REGISTRATION  
 NOV. 8, 1920

*H.L. Eppstein*

Application No. 19154  
 Power No. 6740